

CASE: PLAN21-00019

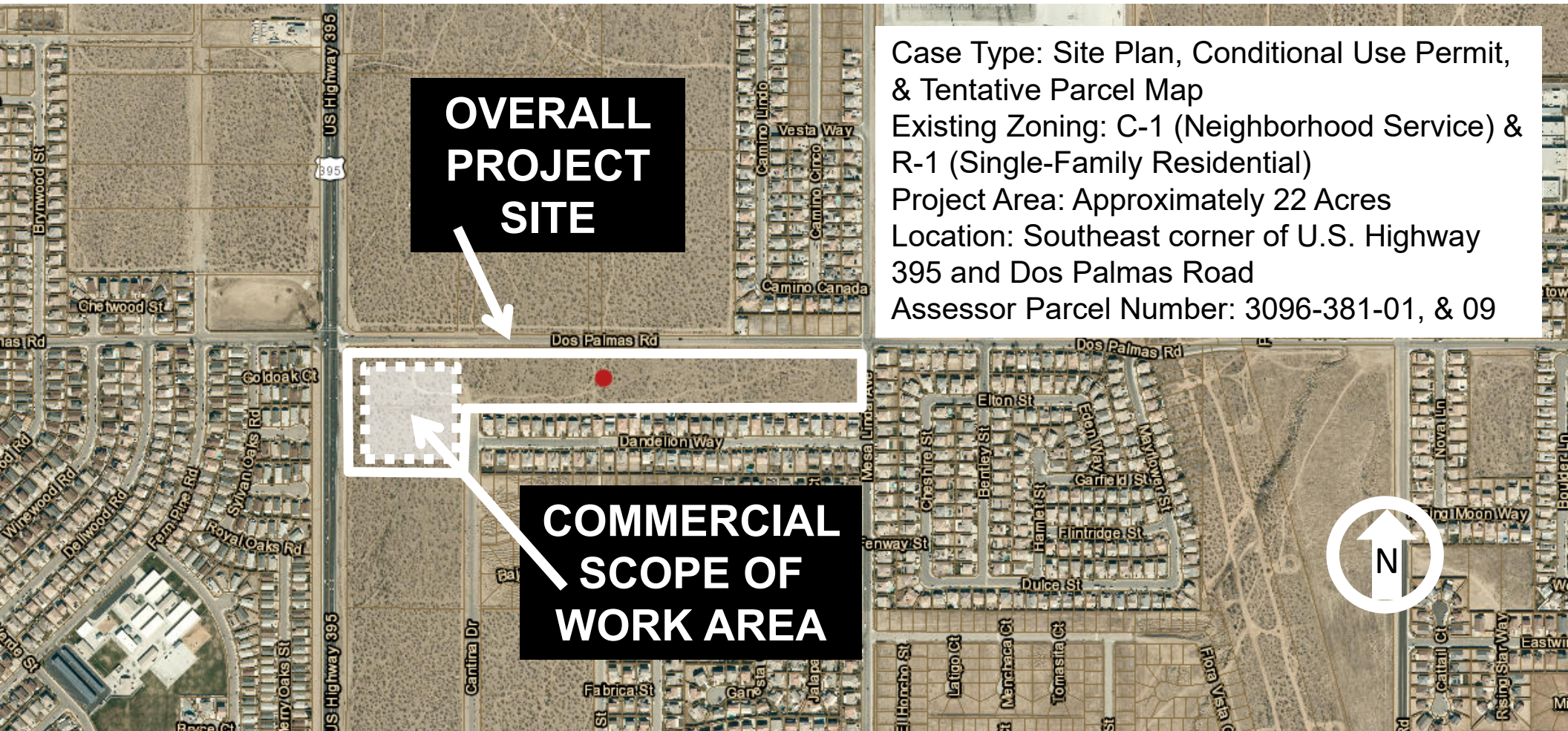

Case Type: Site Plan, Conditional Use Permit,
& Tentative Parcel Map
Existing Zoning: C-1 (Neighborhood Service) &
R-1 (Single-Family Residential)
Project Area: Approximately 22 Acres
Location: Southeast corner of U.S. Highway
395 and Dos Palmas Road
Assessor Parcel Number: 3096-381-01, & 09