

131 Sunset Avenue, Suite E # 120
Suisun, CA 94585-2064



707-718-1416 ▲ Fax 707-451-4775
www.solanoarchaeology.com

CULTURAL RESOURCES TECHNICAL MEMORANDUM

Date: August 12, 2020
To: Ms. Darlene Lum
From: Solano Archaeological Services, LLC
Subject: Cultural Resources Study – E&C Winery Project, City of Fairfield, Solano County, California

INTRODUCTION

This technical memorandum summarizes the background research, Native American community outreach, pedestrian survey, study findings, and recommendations for the E&C Winery Project (Project). The Project is subject to California Environmental Quality Act (CEQA) requirements, and Solano Archaeological Services (SAS) has prepared this technical memorandum to support those needs.

PROJECT LOCATION

The project area is located in a rural area within the City of Fairfield approximately ¼-mile north of Interstate 80, and ¾ of a mile east of the community of Rockville (Attachment A, Figures 1–2). The project area is situated in Township 5 North, Range 2 West in an un-sectioned (projected sections 29, 32, and 33) portion of the Suisun land grant on the *Fairfield South, California* U.S. Geological Survey (USGS) 7.5' topographic quadrangle.

The project area consists of an approximately 70.17-acre (ac.) parcel (APN 027-251-280, and APN-027-251-290) fronting Rockville road with Russel Road forming the eastern boundary (Attachment A, Figure 3). The presently undeveloped project area consists of generally flat grassland bounded by agricultural uses including rural residential improvements to the north, south, east, and west. A produce farm and farm stand is located to the east and a commercial tractor supply company is located to the southeast with both uses being accessed from Russell Road. The nearest residence is on the neighboring parcel (APN 027-251-040) to the north of the project area, approximately 620 feet from the nearest proposed Project building (see Project Description below). There are several residences across Russell Road to the east of the project area.

PROJECT DESCRIPTION

E & C Winery, LLC proposes to develop a new winemaking and hospitality facility on the two project parcels. The proposed winery will be built in three phases over approximately 10 years and have an initial production capacity of 125,000 gallons with an ultimate production capacity of 2,000,000 gallons subject to market demand. The facility will process grapes grown both onsite and from offsite sources. Onsite activities include receiving and crushing grapes, fermentation, processing grape juice into wine, bottling and cooperage, sales, hospitality, and administration.

August 2020
Page 2

The current site conditions consist of agricultural uses with undeveloped access roads, resulting in a mostly pervious site. Grading of the site will include earthwork for building footprints, wastewater treatment ponds, a potential detention basin, roadways and parking areas. In general, existing drainage patterns will be maintained in the post construction condition. Stormwater runoff and treatment mitigation measures will be implemented in accordance with Chapter 31 of the Solano County Code for new development.

REGULATORY SETTING

CEQA requires that public agencies having authority to finance or approve public or private projects assess the effects of the projects on cultural resources. Cultural resources include buildings, sites, structures, objects, or districts, each of which may have historical, architectural, archaeological, cultural, or scientific significance. CEQA states that if a proposed project would result in an effect that may cause a substantial adverse change in the significance of a significant cultural resource (termed a “historical resource”), alternative plans or mitigation measures must be considered. Because only significant cultural resources need to be addressed, the significance of cultural resources must be determined before mitigation measures are developed.

CEQA §5024.1 (Public Resources Code §5024.1) and §15064.5 of the State CEQA Guidelines (14 California Code of Regulations [CCR] §15064.5) define a historical resource as “a resource listed or eligible for listing on the California Register of Historical Resources.” A historical resource may be eligible for inclusion in the California Register of Historical Resources if it:

1. Is associated with events that have made a significant contribution to the broad patterns of California’s history and cultural heritage;
2. Is associated with the lives of persons important to our past;
3. Embodies the distinctive characteristics of a type, period, region, or method of construction; represents the work of an important creative individual; or possesses high artistic values; or
4. Has yielded, or may be likely to yield, information important to prehistory or history.

In addition, CEQA also distinguishes between two classes of archaeological resources: archaeological sites that meet the definition of a historical resource, and “unique archaeological resources.” An archaeological resource is considered “unique” if it:

- Is associated with an event or person of recognized significance in California or American history or of recognized scientific importance in prehistory;
- Can provide information that is of demonstrable public interest and is useful in addressing scientifically consequential and reasonable research questions;
- Has a special or particular quality such as oldest, best example, largest, or last surviving example of its kind;
- Is at least 100 years old and possesses substantial stratigraphic integrity; or
- Involves important research questions that historical research has shown can be answered only with archaeological methods (Public Resources Code §21083.2).

According to the CEQA Guidelines, a project with an effect that may cause a substantial adverse change in the significance of a historical resource or a unique archaeological resource is a project that may have a

August 2020
Page 3

significant effect on the environment (14 CCR §15064.5[b]). CEQA further states that a substantial adverse change in the significance of a resource means the physical demolition, destruction, relocation, or alteration of the resource or its immediate surroundings such that the significance of a historical resource would be materially impaired.

The CEQA Guidelines (14 CCR §15064.5[e]) also require that excavation activities be stopped whenever human remains are uncovered, and that the county coroner be called in to assess the remains. If the county coroner determines that the remains are those of a Native American, the Native American Heritage Commission must be contacted within 24 hours, and the provisions for treating or disposing of the remains and any associated grave goods as described in CCR §15064.5 must be followed.

NATURAL AND CULTURAL SETTING

Existing Environment

The project area lies in a transitional zone between the San Francisco Bay Area, the Coastal Range foothills, and the western edge of the Central Valley. Geologically, the Central Valley is filled several kilometers deep with alluvial soils washed down from the Sierra Nevada. The northern portion of the valley is drained by the Sacramento River, and the southern portion is drained by the San Joaquin River. Prehistoric populations were concentrated along the river channels and in the vicinity of the Sacramento/San Joaquin Rivers Delta, as these were rich with natural resources.

The project area exhibits a Lower Sonoran Zone climatic pattern that is characterized as Mediterranean, with cool, wet winters and hot, dry summers. The natural dominant vegetative communities in the project area and surrounding region consists of prairie grasslands marshes, with some areas of riparian woodland along nearby creeks (Kuchler 1977). Valley oak, cottonwood, sycamore, and willow trees grow along river and creek banks and these differing vegetative zones provided prehistoric populations with a diverse set of natural resources that were regularly exploited.

Faunal species that frequented the prehistoric prairie grasslands and tule marshes included mule deer, tule elk, pronghorn antelope, weasel, river otter, raccoon, and beaver. Migratory waterfowl such as Canada geese, and swans passed through during the winter, joining great blue and black-crowned herons, ibis, cranes, cormorants, and bald eagles. Badgers, coyotes, skunks, jackrabbits, and cottontail rabbits inhabited higher ground. Within the waterways, Chinook salmon, steelhead trout, Pacific lamprey, and white sturgeon seasonally joined other fish species indigenous to the area. Predators such as mountain lions, grizzly bears, wolves, kit fox, and bobcats also roamed the area (Moratto 1984).

Prehistoric Setting

Due to the plentiful resources and temperate climate, the Bay Area and Central Valley were well populated prehistorically and served as the location for some of the more substantial village sites known in California. As a result, the region surrounding the project area was an early focus for archaeological investigations. Beardsley (1948) and Lillard, Heizer, and Fenenga (1939) and others conducted numerous studies that formed the core of our early understanding of upper Central Valley archaeology. The earliest and best-documented human presence occurred during the Paleo-Indian or Lower Archaic time periods (10,000-3,000 BC) but very few sites or artifacts dating to this time period have been found. However, archaeologists have recovered a great deal of data from sites occupied beginning in the Middle Archaic period (3,000-1,000 BC). At this time, broad regional patterns of foraging subsistence strategies gave way

August 2020

Page 4

to more intensive procurement practices, which have been subdivided into three archaeological time periods/cultural patterns. These assemblages are discussed in detail in Moratto (1984) and summarized below.

The Windmill Pattern (3,000-1,000 BC) of archaeological assemblages included an increased emphasis on acorn use as well as a continuation of hunting and fishing activities. Ground and polished charmstones, twined basketry, baked-clay artifacts and worked shell and bone were hallmarks of Windmill culture. Widely ranging trade patterns brought goods in from the Coast Ranges and trans-Sierran sources as well as closer trading partners. Distinctive burial practices identified with the Windmill Pattern also appeared in the Sierra foothills, indicating possible seasonal migration into the Sierra.

The Berkeley Pattern (1,000 BC to AD 500) represented a greater reliance on acorns as a food source than was seen previously. Distinctive stone and shell artifacts distinguished it from earlier or later cultural expressions. The Berkeley Pattern appears to have developed in the Bay Area and was spread through the migration of Plains Miwok Indians.

The Augustine Pattern (AD 500 to Historic Era) may have been stimulated by the southern migration of Wintuan people from north of the Sacramento Valley. Their culture was marked by increasing populations resulting from more intensive food procurement strategies, as well as a marked change in burial practices, increased trade activities and a well-defined ceramic technology.

Ethnographic Setting

The project area and surrounding region was occupied by multiple Native American groups including the Patwin, Ohlone, Wappo, and Coast Miwok. However, according to ethnographic documentation, during the early 20th century the project area and surrounding vicinity was inhabited by the Patwin (Johnson 1978), who spoke a language belonging to the Penutian linguistic group.

The Patwin, which means “people” in their own language, were also known as the Copeh or Southern Wintun. At the time of initial contact between European explorers and Native Americans, they resided mainly in what would become Solano, Yolo, Napa, and Colusa counties, and shared territorial boundaries with many different Native American groups. The Nomlaki to the north referred to the Patwin as noymok, or “south people”, while the Yuki to the northwest referred to them as the “Little Stony Creek Patwin” who had contact with Ku’mnom, or “salt people” (Johnson 1978: 358-359).

Patwin territory took an approximate geographic expanse of 90 miles north–south by 40 miles east–west. They were known to have resided on the east side of the Coastal Range, along the foothills east of Clear Lake. Suisun Bay acted as their southern boundary, providing a Delta tule marsh habitat full of a diverse array of floral and faunal species to exploit. From Suisun Bay to the confluence of Feather River and the lower Sacramento River, the Patwin eastern boundary existed near the west banks of the Sacramento River.

Historic Setting - Solano County and Rockville

Situated northwest of the confluence of the San Pablo and Suisun Bays, Solano County developed both in the valleys where waterways such as the nearby Suisun Creek (about ¼-mile west of the project area) flow, and in the mountainous terrain rising from its banks. The area’s topography, geology, soil, and

August 2020

Page 5

weather conditions made it ideal for agricultural and ranching pursuits, and the landscape prompted relatively early European settlement of the region. The first non-native people to venture to the present-day Solano County area were Spanish explorers in search of new mission sites. For example, Padre Jose Altimira and Don Francisco Castro arrived in the nearby Napa Valley in 1823, finding the area similar in many respects to Sonoma. Later, private land grants from the Mexican government attracted settlers to undeveloped areas with large parcels of land, in exchange for loyal service (Hoover et al. 2002). The project area is contained within one of these land grants, *Rancho Suisun*, an 18,237-acre given in 1842 by Governor Juan Alvarado to Francisco Solano, a notable Native American leader, and Captain in the Mexican Army. Chief Solano received the grant in part due to his friendship and support of General Mariano Guadalupe Vallejo. However, Solano was not able to retain it, and sold it to General Vallejo in May 1850.

The community of Rockville began to be settled in the early 1850s as a stage stops on the road from Benicia to Sacramento. Rockville later grew to include a few stores, a hotel, and a post office and in 1856, Rockville residents built a stone chapel, most likely from rock obtained from a quarry on Rockville Road. The chapel was eventually deeded to the Rockville Public Cemetery District in 1929, restored, and established as a California Historical Landmark (#779) in 1940.

The first European settlers in the Rockville area grew grapes for wine on the valley slopes and maintained the flats for field crops. In the 1870s, a root disease destroyed many plants and most grape growers never recovered. Many growers had also reportedly grown cherry trees, and cherry orchards apparently grew successfully for generations. Gold was found in the area in 1887 and mining continued into the early 20th century but it was never a major industry and today much of the Rockville area remains dedicated to agriculture.

NATIVE AMERICAN COMMUNITY OUTREACH

SAS emailed a letter and a map depicting the E&C Winery Project area to the Native American Heritage Commission (NAHC) on June 24, 2020 requesting a Sacred Lands File (SLF) search of the project area, and a list of Native American community representatives who might have an interest in or concerns with the proposed Project (Attachment B). On June 25, 2020, Ms. Sarah Fonseca, Cultural Resources Analyst for the NAHC, replied in an emailed letter that the SLF search was completed with negative results. Ms. Fonseca also provided a list of local Native American contacts. On July 2, 2020, SAS mailed letters to the following Native American representatives identified by the NAHC:

- Charlie Wright, Chair - Cortina Rancheria – Klestal Dehe Band of Wintun Indians
- Gene Whitehouse, Chair - United Auburn Indian Community of the Auburn Rancheria
- Merlene Sanchez, Chair - Guidiville Indian Rancheria
- Anthony Roberts, Chair - Yocha Dehe Wintun Nation
- Corrina Gould, Chair - The Confederated Villages of Lisjan

SAS followed up with each letter with emails and phone calls as necessary. On July 9, 2020, SAS received an emailed letter from Mr. Laverne Bill, Cultural Resources Manager of the Yocha Dehe Wintun Nation. Mr. Bill stated that he did not have any knowledge of Native American resources in the project area but recommended cultural resources awareness training for construction personnel and that this training could be provided by a tribal member. In addition, on August 5, 2020 SAS Principal Investigator Dr. Brian Ludwig, spoke with Mr. Charlie Wright concerning the project and he stated that he no concerns regarding the proposed Project and was not aware of any cultural sites or properties in the project area.

August 2020
Page 6

CALIFORNIA HISTORICAL RESOURCES INFORMATION SYSTEM RECORDS SEARCH

SAS conducted a records search through the Northwest Information Center (NWIC) of the California Historical Resources Information System at Sonoma State University on June 23, 2020. The NWIC reviewed the CHRIS archives for records of previously known and recorded cultural resources, studies, and isolates in and within one half-mile of the project area. The record search included, but was not necessarily restricted to, a review of the following additional sources:

- The *National Register of Historic Places*;
- The *California Register of Historical Resources*;
- The *California Historical Landmarks* (California Office of Historic Preservation);
- The *California Points of Historical Interest* (California Office of Historic Preservation);
- The *California Inventory of Historic Resources* (California Department of Parks and Recreation);

The record search results (NWIC File No. 19-2323) indicated that no previously documented cultural resources were identified directly in the project area. However, the NWIC research indicated that 11 sites had been documented within the half-mile search area (Table 1). In addition, three previous cultural resources investigations were conducted immediately adjacent to the current project area (Table 2), and an additional 18 studies were conducted in the half-mile search area (see Attachment C).

Table 1. Sites Documented within One Half-Mile of Project Area

Site #	Association	Site Type	Recorded
P-48-000182 CA-SOL-000244	Unknown	Unknown	Record missing from NWIC archives
P-48-000183 CA-SOL-000245	Unknown	Unknown	Record missing from NWIC archives
P-48-000739	Historic era	Valine Farm	W. Kostura, 2007; M. Bowen et al. 2007 (Jones and Stokes)
P-48-000740	Historic era	Del Monte Warehouse	W. Kostura, 2003; M. Bowen et al. 2007 (Jones and Stokes)
P-48-000741	Historic era	Residence: 4136 Russel Rd.	W. Kostura 2003
P-48-000742	Historic era	Residence: 4164 Russel Rd.	W. Kostura 2003
P-48-000743	Historic era	Building: Green Valley Tractor	W. Kostura 2003
P-48-000898	Prehistoric	Hale Site	Meyer and Kaijanowski 2011 (FWARG)
P-48-001648	Historic era	Irrigation ditch	M. Bowen et al. 2007 (Jones and Stokes)
P-48-001649	Historic era	Residence: 4021 Russel Rd.	M. Bowen and K. Haley 2008 (Jones and Stokes)
P-48-001651	Historic era	Residence: 4015 Hale Ranch Rd.	M. Bowen and K. Haley 2007 (Jones and Stokes)

August 2020
Page 7

Table 2. Studies Previously Conducted in the Project Area

Report #	Author	Title	Date
031929	L. Martin and W. Self-William Self Associates	Historic Property Survey Report, Solano North Connector, Fairfield, Solano County, California; SOL 12 KP 3.9 (PM 2.4), SOL 80 KP 25.9 (PM 16.2), EA 04-264-0A5200, Contract No. 16009	2006
031929a	L. Martin - William Self Associates	Archaeological Survey Report, Solano Transportation Authority, Fairfield, Solano County, California; SOL 12 KP 3.9 (PM 2.4), SOL 80 KP 25.9 (PM 16.2), EA 04-264-0A5200, Contract No. 16009	2006
031929b	M. Rieder - William Self Associates	Historical Resources Evaluation Report, Solano North Connector, Fairfield, Solano County, California, SOL 12 KP 3.9 (PM 2.4), SOL 80 KP 25.9 (PM 16.2), EA 04-264-0A5200, Contract No. 16009	2006

SAS also reviewed a series of historic USGS topographic maps, General Land Office (GLO) plat maps, and historic aerial photographs to gather information on past land use and historic development in the project area. The aerial photos date to as early as 1948 at which time a series of buildings and structures appear in the northwestern-most portion of the project area immediately south of Rockville Road and adjacent to a feature noted on the 1949 USGS topographic map as an “Old railroad grade”. These buildings, probably related to agricultural activities on and near the project area, were still in place in 1968 but later aerial photos (1982) appear to show the buildings as having been recently demolished. From the early 1980s to the present day according to aerial photography and USGS mapping, no other development occurred in this area (or anywhere else in the project area) and where the buildings once stood was overgrown and partially wooded until the last few years when it was fully incorporated into agricultural fields.

Being situated within Rancho Suisun, features and developments contained within this and comparable land grants are normally not depicted on GLO maps and the plat map for Township 5 North, Range 2 West is no exception. The GLO plats for this area date to 1863, and 1883 and show some developments in sectioned areas outside of Rancho Suisun but well outside of the project area.

FIELD SURVEY

Methods

On August 7, 2020, SAS archaeologists Jason A. Coleman (M.A., Registered Professional Archaeologist) conducted an intensive pedestrian survey of the entire project area using parallel transects spaced 20 meters apart. Rodent burrows and other ground openings were thoroughly inspected, and the property was documented with digital photographs (Attachment D) and video recordings. A Trimble Juno unit was utilized to verify Project boundaries.

Results

The project area was completely cultivated at the time of the survey. Some fields were recently tilled but not planted while other portions of the property were devoted to corn, and hay. With the exception of the

*August 2020**Page 8*

field where hay had recently been mown, and another field with mature corn, ground surface visibility was variable but in some areas approached 100%. The northwestern-most corner of the project area where buildings and later undeveloped and overgrown lots existed between the late 1940s and as recently as 2016 according to aerial photography, is now completely under cultivation. No remains potentially associated with the buildings that once occupied the northwest corner of the project area adjacent to Rockville Road were noted during the survey. In addition, no other sites, features, or artifacts were documented during the survey.

RECOMMENDATIONS

The NAHC and NWIC record searches did not result in the identification of any previously documented cultural resources in the project area and none of the tribal groups and representatives contacted by SAS per the NAHC had any knowledge of sites in the project area and did not express any specific concerns with the proposed Project. The intensive survey of the project area did not result in the identification of any prehistoric or historic-era cultural resources or potentially archaeologically sensitive landforms or deposits. No further management is required.

In the event that presently undocumented buried archaeological deposits are encountered during any Project-associated construction activity, work must cease within a 50-foot radius of the discovery. A qualified archaeologist must be retained to document the discovery, assess its significance, and recommend treatment. If human remains or any associated funerary artifacts are discovered during construction, all work must cease within the immediate vicinity of the discovery. In accordance with the California Health and Safety Code (Section 7050.5), the Solano County Sheriff/Coroner must be contacted immediately. If the Coroner determines the remains to be Native American, the Coroner will notify the Native American Heritage Commission, which will in turn appoint a Most Likely Descendent (MLD) to act as a tribal representative. The MLD will work with the Applicant and a qualified archaeologist to determine the proper treatment of the human remains and any associated funerary objects. Construction activities will not resume until either the human remains are exhumed, or the remains are avoided via Project construction design change.

August 2020
Page 9

REFERENCES

Beardsley, R.K.

1948 Cultural Sequences in Central California Archaeology. *American Antiquity* 14(1):1-28.

Beck, Warren A., and Ynez D. Haase

1974 *Historical Atlas of California*. University of Oklahoma Press.

Hoover, M.B., H.E. Rensch, E.G. Rensch, and W.N. Abeloe

2002 *Historic Spots in California*. Fifth edition, revised by Douglas E. Kyle. Stanford University Press, Stanford, California.

Johnson, P.

1978 The Patwin. In *Handbook of North American Indians*, Vol. 8. Smithsonian Institution, Washington.

Kuchler, A.W.

1977 Map of the Natural Vegetation of California. In M.G. Barbour and J. Major, eds., *Terrestrial Vegetation of California*. New York: Wiley.

Lillard, J.B., R. F. Heizer and F. Fenenga

1939 *An Introduction to the Archaeology of Central California*. Sacramento: Sacramento Junior College, Department of Anthropology Bulletin 2.

Moratto, Michael J.

1984 *California Archaeology*. Academic Press, San Francisco.

Attachment A

Figures

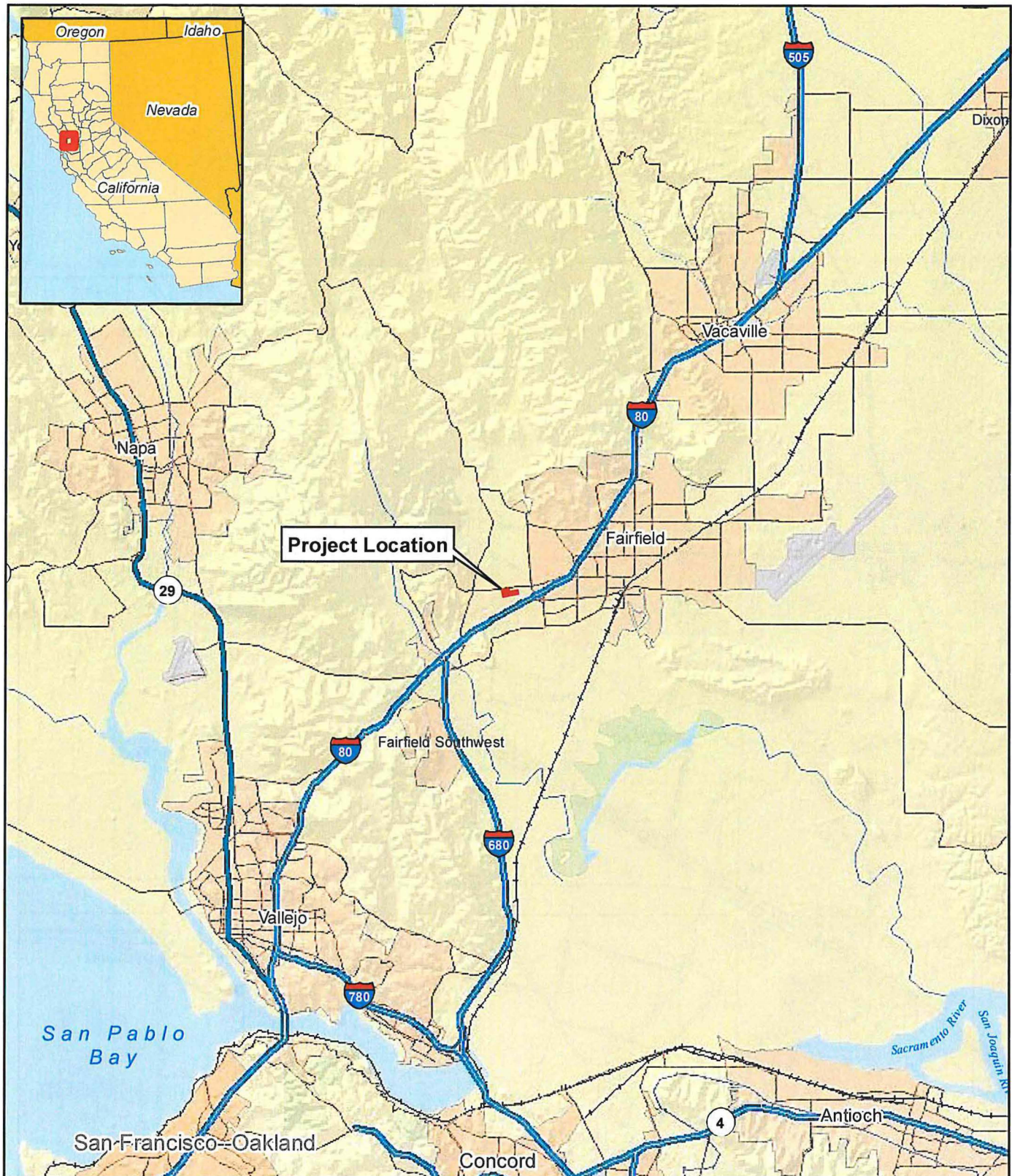

Figure1. Project Vicinity Map

■ E & C Winery Project Area

Sources: *USA Base Map* [layer], *Data and Maps* [CD]. ESRI, 2006.

1:250,000

0 3 Miles

0 6 Kilometers



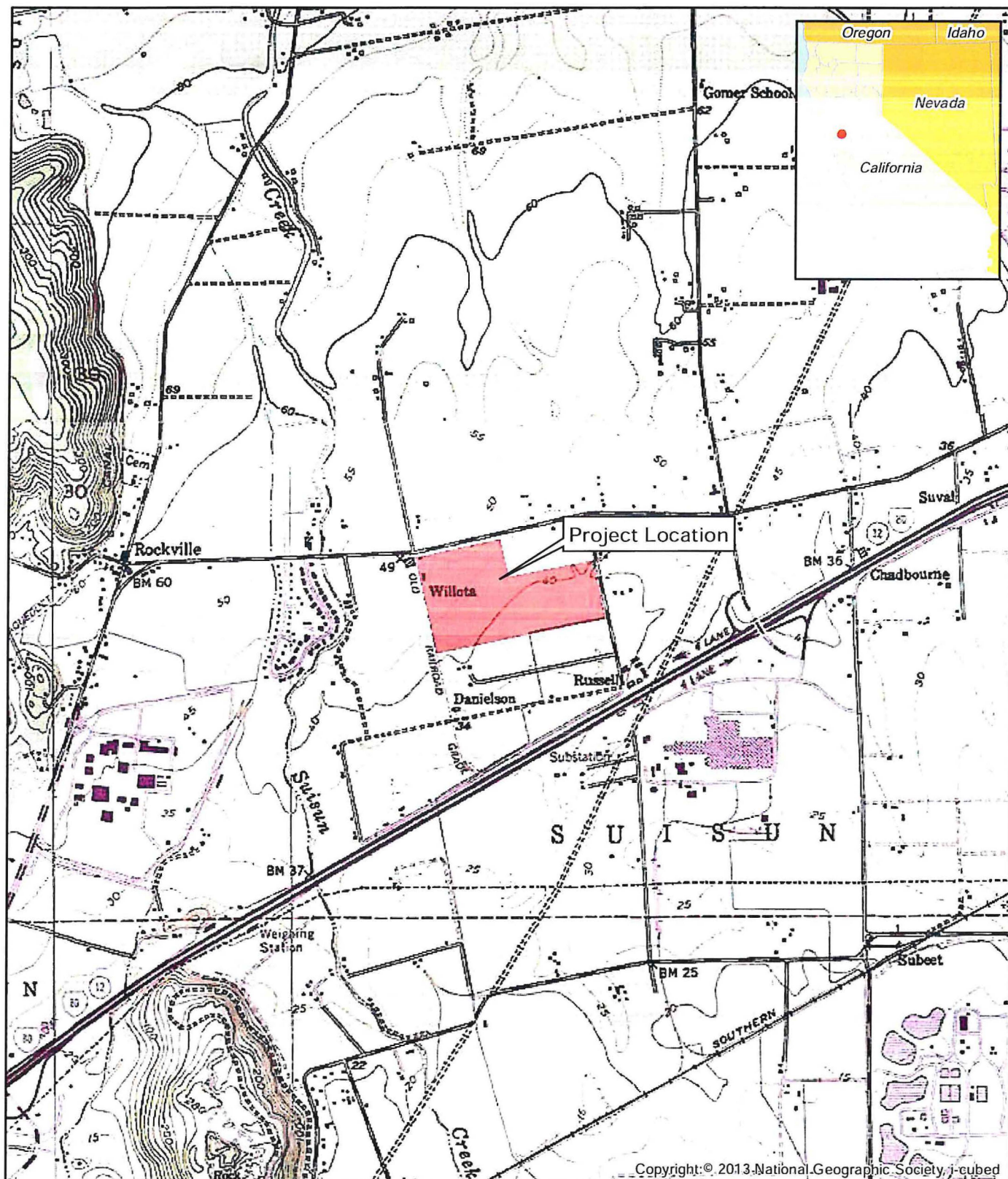

Figure 2. Project Location Map

■ E & C Winery Project Area

Suisun Land Grant (Presumed T05N, R02W, Sections 29, 32, 33).
Fairfield South 7.5' Series Quadrangle, USGS, 1980.

1:24,000

0.5

Miles

1

Kilometers





Figure 3. Project Area Map

 E & C Winery Project Area

Total Acres: 70.17

1:5,600

0 300 Feet

0 150 Meters



ATTACHMENT B
Native American Community Outreach

131 Sunset Avenue, Suite E # 120
Suisun, CA 94585-2064



707-718-1416 ▲ Fax 707-451-4775
www.solanoarchaeology.com

June 24, 2020

Native American Heritage Commission
1550 Harbor Blvd., Suite 100
West Sacramento, CA 95691

Re: E & C Winery Project - Solano County, California

To Whom It May Concern:

Summit Engineering, Inc., has retained Solano Archaeological Services (SAS) to conduct a cultural resources inventory of an approximately 70-acre project area for the E & C Winery Project (the Project). The proposed Project would consist of the construction of a winemaking, hospitality, and administration facility along Rockville Road, near the City of Fairfield in Solano County, California. As shown on the attached map, the project area is situated in an un-sectioned portion of Township 5 North, Range 2 West of the *Fairfield South, California* USGS 7.5' topographic quadrangle.

The cultural resources inventory will include a pedestrian survey of the project area. Before we commence fieldwork, however, we would like to request a Sacred Lands File review for any reported cultural properties within or adjacent to the project area. If you could also provide a list of Native American individuals/organizations that may have knowledge of cultural resources in the vicinity of the project area, we would greatly appreciate it. This request is being made for California Environmental Quality Act (CEQA) outreach purposes only and any formal requests for AB-52 consultation will be forwarded to the lead CEQA agency although SAS will, if requested and as appropriate, assist in facilitating the process.

Please email SLF search results and contacts list to Brian@solanoarchaeology.com.

If you have any questions or if you need any additional information, please feel free to contact me at your convenience. Thank you very much for your attention to this request and I hope to hear from you soon.

Regards,

Brian Ludwig, Ph.D.
Principal Investigator

Enc. Project area location map

122° 04' 52.5590" W
038° 15' 55.1979" N

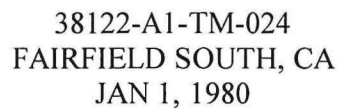

(HONKER BAY)

Native American Heritage Commission
Tribal Consultation List
Solano County
6/25/2020

**Cortina Rancheria - Kletsel
Dehe Band of Wintun Indians**

Charlie Wright, Chairperson
P.O. Box 1630 Wintun
Williams, CA, 95987
Phone: (530) 473 - 3274
Fax: (530) 473-3301

Guidiville Indian Rancheria

Merlene Sanchez, Chairperson
P.O. Box 339 Pomo
Talmage, CA, 95481
Phone: (707) 462 - 3682
Fax: (707) 462-9183
admin@guidiville.net

**United Auburn Indian
Community of the Auburn
Rancheria**

Gene Whitehouse, Chairperson
10720 Indian Hill Road Maidu
Auburn, CA, 95603 Miwok
Phone: (530) 883 - 2390
Fax: (530) 883-2380
bguth@auburnrancheria.com

Yocha Dehe Wintun Nation

Anthony Roberts, Chairperson
P.O. Box 18 Patwin
Brooks, CA, 95606
Phone: (530) 796 - 3400
Fax: (530) 796-2143
aroberts@yochadehe-nsn.gov

**The Confederated Villages of
Lisjan**

Corrina Gould, Chairperson
10926 Edes Avenue Bay Miwok
Oakland, CA, 94603 Ohlone
Phone: (510) 575 - 8408 Delta Yokut
cvltribe@gmail.com

This list is current only as of the date of this document. Distribution of this list does not relieve any person of statutory responsibility as defined in Section 7050.5 of the Health and Safety Code, Section 5097.94 of the Public Resources Code and section 5097.98 of the Public Resources Code.

This list is only applicable for consultation with Native American tribes under Public Resources Code Sections 21080.3.1 for the proposed E & C Winery Project, Solano County.



STATE OF CALIFORNIA

Gavin Newsom, Governor

NATIVE AMERICAN HERITAGE COMMISSION

June 25, 2020

Brian Ludwig, PhD, Principal Investigator
Solano Archaeological Services

Via Email to: brian@solanoarchology.com

Re: Native American Tribal Consultation, Pursuant to the Assembly Bill 52 (AB 52), Amendments to the California Environmental Quality Act (CEQA) (Chapter 532, Statutes of 2014), Public Resources Code Sections 5097.94 (m), 21073, 21074, 21080.3.1, 21080.3.2, 21082.3, 21083.09, 21084.2 and 21084.3, E & C Winery Project, Solano County

To Dr. Ludwig:

Pursuant to Public Resources Code section 21080.3.1 (c), attached is a consultation list of tribes that are traditionally and culturally affiliated with the geographic area of the above-listed project. Please note that the intent of the AB 52 amendments to CEQA is to avoid and/or mitigate impacts to tribal cultural resources, (Pub. Resources Code §21084.3 (a)) ("Public agencies shall, when feasible, avoid damaging effects to any tribal cultural resource.")

Public Resources Code sections 21080.3.1 and 21084.3(c) require CEQA lead agencies to consult with California Native American tribes that have requested notice from such agencies of proposed projects in the geographic area that are traditionally and culturally affiliated with the tribes on projects for which a Notice of Preparation or Notice of Negative Declaration or Mitigated Negative Declaration has been filed on or after July 1, 2015. Specifically, Public Resources Code section 21080.3.1 (d) provides:

Within 14 days of determining that an application for a project is complete or a decision by a public agency to undertake a project, the lead agency shall provide formal notification to the designated contact of, or a tribal representative of, traditionally and culturally affiliated California Native American tribes that have requested notice, which shall be accomplished by means of at least one written notification that includes a brief description of the proposed project and its location, the lead agency contact information, and a notification that the California Native American tribe has 30 days to request consultation pursuant to this section.

The AB 52 amendments to CEQA law does not preclude initiating consultation with the tribes that are culturally and traditionally affiliated within your jurisdiction prior to receiving requests for notification of projects in the tribe's areas of traditional and cultural affiliation. The Native American Heritage Commission (NAHC) recommends, but does not require, early consultation as a best practice to ensure that lead agencies receive sufficient information about cultural resources in a project area to avoid damaging effects to tribal cultural resources.

The NAHC also recommends, but does not require that agencies should also include with their notification letters, information regarding any cultural resources assessment that has been completed on the area of potential effect (APE), such as:

1. The results of any record search that may have been conducted at an Information Center of the California Historical Resources Information System (CHRIS), including, but not limited to:

CHAIRPERSON
Laura Miranda
Luiseño

VICE CHAIRPERSON
Reginald Pagaling
Chumash

SECRETARY
Merri Lopez-Keifer
Luiseño

PARLIAMENTARIAN
Russell Attebery
Karuk

COMMISSIONER
Marshall McKay
Wintun

COMMISSIONER
William Mungary
Paiute/White Mountain
Apache

COMMISSIONER
Julie Tumamait-Stenslie
Chumash

COMMISSIONER
[Vacant]

COMMISSIONER
[Vacant]

EXECUTIVE SECRETARY
Christina Snider
Pomo

NAHC HEADQUARTERS
1550 Harbor Boulevard
Suite 100
West Sacramento,
California 95691
(916) 373-3710
nahc@nahc.ca.gov
NAHC.ca.gov

- A listing of any and all known cultural resources that have already been recorded on or adjacent to the APE, such as known archaeological sites;
- Copies of any and all cultural resource records and study reports that may have been provided by the Information Center as part of the records search response;
- Whether the records search indicates a low, moderate, or high probability that unrecorded cultural resources are located in the APE; and
- If a survey is recommended by the Information Center to determine whether previously unrecorded cultural resources are present.

2. The results of any archaeological inventory survey that was conducted, including:

- Any report that may contain site forms, site significance, and suggested mitigation measures.

All information regarding site locations, Native American human remains, and associated funerary objects should be in a separate confidential addendum, and not be made available for public disclosure in accordance with Government Code section 6254.10.

3. The result of any Sacred Lands File (SLF) check conducted through the Native American Heritage Commission was negative.

4. Any ethnographic studies conducted for any area including all or part of the APE; and

5. Any geotechnical reports regarding all or part of the APE.

Lead agencies should be aware that records maintained by the NAHC and CHRIS are not exhaustive and a negative response to these searches does not preclude the existence of a tribal cultural resource. A tribe may be the only source of information regarding the existence of a tribal cultural resource.

This information will aid tribes in determining whether to request formal consultation. In the event that they do, having the information beforehand will help to facilitate the consultation process.

If you receive notification of change of addresses and phone numbers from tribes, please notify the NAHC. With your assistance, we can assure that our consultation list remains current.

If you have any questions, please contact me at my email address: Sarah.Fonseca@nahc.ac.gov.

Sincerely,



Sarah Fonseca
Cultural Resources Analyst

Attachment

131 Sunset Avenue, Suite E # 120
Suisun, CA 94585-2064



707-718-1416 ▲ Fax 707-451-4775
www.solanoarchaeology.com

July 2, 2020

Ms. Merlene Sanchez
Guidiville Indian Rancheria
P.O. Box 339
Talmage, CA 95481

Re: E & C Winery Project

Dear Ms. Sanchez:

Summit Engineering has retained Solano Archaeological Services (SAS) to conduct a cultural resources inventory of two adjoining parcels totaling approximately 70 acres for the construction of the E&C Winery wine-making and hospitality facility in Suisun Valley, Solano County, California, (the Project). As shown on the attached map, the project area is situated in Township 5 North, Range 2 West in an un-sectioned portion of the Suisun land grant on the *Fairfield South, California* USGS 7.5' topographic quadrangle.

The cultural resources inventory will include a pedestrian survey of the project area. Before we commence fieldwork, however, we would like to ask if you could provide any information on unrecorded resources within or in the vicinity of the project area as shown on the attached map. Any input or recommendations you could provide for the Project would be greatly appreciated. This request is being made for CEQA/AB-52 outreach purposes only and any formal requests for consultation will be forwarded to the lead CEQA agency although SAS will, if requested and as appropriate, facilitate the process. For your information, the Native American Heritage Commission Sacred Lands File record search indicates that no culturally significant properties have been recorded in or near the project area.

If you have any questions or if you need any additional information, please feel free to contact me at your convenience. Thank you very much for your attention to this request and I hope to hear from you soon.

Thanks,

Brian Ludwig, Ph.D.
Principal Investigator

Enc. Project area location map

131 Sunset Avenue, Suite E # 120
Suisun, CA 94585-2064



707-718-1416 ▲ Fax 707-451-4775
www.solanoarchaeology.com

July 2, 2020

Ms. Corrina Gould
The Confederated Villages of Lisjan
10926 Edes Ave.
Oakland, CA 94603

Re: E & C Winery Project

Dear Mr. Roberts:

Summit Engineering has retained Solano Archaeological Services (SAS) to conduct a cultural resources inventory of two adjoining parcels totaling approximately 70 acres for the construction of the E&C Winery wine-making and hospitality facility in Suisun Valley, Solano County, California, (the Project). As shown on the attached map, the project area is situated in Township 5 North, Range 2 West in an un-sectioned portion of the Suisun land grant on the *Fairfield South, California* USGS 7.5' topographic quadrangle.

The cultural resources inventory will include a pedestrian survey of the project area. Before we commence fieldwork, however, we would like to ask if you could provide any information on unrecorded resources within or in the vicinity of the project area as shown on the attached map. Any input or recommendations you could provide for the Project would be greatly appreciated. This request is being made for CEQA/AB-52 outreach purposes only and any formal requests for consultation will be forwarded to the lead CEQA agency although SAS will, if requested and as appropriate, facilitate the process. For your information, the Native American Heritage Commission Sacred Lands File record search indicates that no culturally significant properties have been recorded in or near the project area.

If you have any questions or if you need any additional information, please feel free to contact me at your convenience. Thank you very much for your attention to this request and I hope to hear from you soon.

Thanks,

Brian Ludwig, Ph.D.
Principal Investigator

Enc. Project area location map

131 Sunset Avenue, Suite E # 120
Suisun, CA 94585-2064



707-718-1416 ▲ Fax 707-451-4775
www.solanoarchaeology.com

July 2, 2020

Mr. Gene Whitehouse
United Auburn Indian Community of the Auburn Rancheria
10720 Indian Hill Rd.
Auburn, CA 95603

Re: E & C Winery Project

Dear Mr. Whitehouse:

Summit Engineering has retained Solano Archaeological Services (SAS) to conduct a cultural resources inventory of two adjoining parcels totaling approximately 70 acres for the construction of the E&C Winery wine-making and hospitality facility in Suisun Valley, Solano County, California, (the Project). As shown on the attached map, the project area is situated in Township 5 North, Range 2 West in an un-sectioned portion of the Suisun land grant on the *Fairfield South, California* USGS 7.5' topographic quadrangle.

The cultural resources inventory will include a pedestrian survey of the project area. Before we commence fieldwork, however, we would like to ask if you could provide any information on unrecorded resources within or in the vicinity of the project area as shown on the attached map. Any input or recommendations you could provide for the Project would be greatly appreciated. This request is being made for CEQA/AB-52 outreach purposes only and any formal requests for consultation will be forwarded to the lead CEQA agency although SAS will, if requested and as appropriate, facilitate the process. For your information, the Native American Heritage Commission Sacred Lands File record search indicates that no culturally significant properties have been recorded in or near the project area.

If you have any questions or if you need any additional information, please feel free to contact me at your convenience. Thank you very much for your attention to this request and I hope to hear from you soon.

Thanks,

Brian Ludwig, Ph.D.
Principal Investigator

Enc. Project area location map

131 Sunset Avenue, Suite E # 120
Suisun, CA 94585-2064



707-718-1416 ▲ Fax 707-451-4775
www.solanoarchaeology.com

July 2, 2020

Mr. Charlie Wright
Cortina Rancheria-Kletsel Dehe Band of Wintun Indians
P.O. Box 1630
Williams, CA 95987

Re: E & C Winery Project

Dear Mr. Wright:

Summit Engineering has retained Solano Archaeological Services (SAS) to conduct a cultural resources inventory of two adjoining parcels totaling approximately 70 acres for the construction of the E&C Winery wine-making and hospitality facility in Suisun Valley, Solano County, California, (the Project). As shown on the attached map, the project area is situated in Township 5 North, Range 2 West in an un-sectioned portion of the Suisun land grant on the *Fairfield South, California* USGS 7.5' topographic quadrangle.

The cultural resources inventory will include a pedestrian survey of the project area. Before we commence fieldwork, however, we would like to ask if you could provide any information on unrecorded resources within or in the vicinity of the project area as shown on the attached map. Any input or recommendations you could provide for the Project would be greatly appreciated. This request is being made for CEQA/AB-52 outreach purposes only and any formal requests for consultation will be forwarded to the lead CEQA agency although SAS will, if requested and as appropriate, facilitate the process. For your information, the Native American Heritage Commission Sacred Lands File record search indicates that no culturally significant properties have been recorded in or near the project area.

If you have any questions or if you need any additional information, please feel free to contact me at your convenience. Thank you very much for your attention to this request and I hope to hear from you soon.

Thanks,

Brian Ludwig, Ph.D.
Principal Investigator

Enc. Project area location map

131 Sunset Avenue, Suite E # 120
Suisun, CA 94585-2064



707-718-1416 ▲ Fax 707-451-4775
www.solanoarchaeology.com

July 2, 2020

Mr. Anthony Roberts
Yocha Dehe Wintun Nation
P.O. Box 18
Brooks, CA 95606

Re: E & C Winery Project

Dear Mr. Roberts:

Summit Engineering has retained Solano Archaeological Services (SAS) to conduct a cultural resources inventory of two adjoining parcels totaling approximately 70 acres for the construction of the E&C Winery wine-making and hospitality facility in Suisun Valley, Solano County, California, (the Project). As shown on the attached map, the project area is situated in Township 5 North, Range 2 West in an un-sectioned portion of the Suisun land grant on the *Fairfield South, California* USGS 7.5' topographic quadrangle.

The cultural resources inventory will include a pedestrian survey of the project area. Before we commence fieldwork, however, we would like to ask if you could provide any information on unrecorded resources within or in the vicinity of the project area as shown on the attached map. Any input or recommendations you could provide for the Project would be greatly appreciated. This request is being made for CEQA/AB-52 outreach purposes only and any formal requests for consultation will be forwarded to the lead CEQA agency although SAS will, if requested and as appropriate, facilitate the process. For your information, the Native American Heritage Commission Sacred Lands File record search indicates that no culturally significant properties have been recorded in or near the project area.

If you have any questions or if you need any additional information, please feel free to contact me at your convenience. Thank you very much for your attention to this request and I hope to hear from you soon.

Thanks,

Brian Ludwig, Ph.D.
Principal Investigator

Enc. Project area location map

ATTACHMENT C

Record Search Results

CALIFORNIA
HISTORICAL
RESOURCES
INFORMATION
SYSTEM

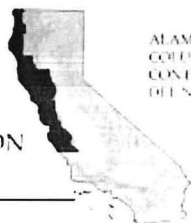

ALAMEDA
COLUSA
CONTRA COSTA
DEL Norte

HUMBOLDT
LAKE
MARIN
MENDOCINO
MONTEBELL
NAPA
SAN BENITO

SAN FRANCISCO
SAN MATEO
SANTA CLARA
SANTA CRUZ
SOLANO
SONOMA
YUBA

Northwest Information Center
Sonoma State University
150 Professional Center Drive, Suite E
Rohnert Park, California 94928-3689
Tel: 707.588.8455
nwic@sonoma.edu
http://www.sonoma.edu/nwic

7/31/2020

NWIC File No.: 19-2323

Jason A. Coleman
Solano Archaeological Services
131 Sunset Avenue, Ste. E 120
Suisun City, CA 94585

Re: E & C Winery Project

The Northwest Information Center received your record search request for the project area referenced above, located on the Fairfield South, Fairfield North USGS 7.5' quad(s). The following reflects the results of the records search for the project area and a .5 mi. radius:

Resources within project area:	None listed
Resources within .5 mi. radius:	P-48-000182, P-48-000183, P-48-000739, P-48-000740, P-48-000741, P-48-000742, P-48-000743, P-48-000898, P-48-001648, P-48-001649, P-48-001651
Reports within project area:	S-31929, 45102, 48541
Reports within .5 mi. radius:	[18] Please see attached list, page 3

Resource Database Printout (list):

☒ enclosed ☐ not requested ☐ nothing listed

Resource Database Printout (details):

☐ enclosed ☒ not requested ☐ nothing listed

Resource Digital Database Records:

☒ enclosed ☐ not requested ☐ nothing listed

Report Database Printout (list):

☒ enclosed ☐ not requested ☐ nothing listed

Report Database Printout (details):

☐ enclosed ☒ not requested ☐ nothing listed

Report Digital Database Records:

☒ enclosed ☐ not requested ☐ nothing listed

Resource Record Copies: [None within]

☐ enclosed ☐ not requested ☒ nothing listed

Report Copies:

☐ enclosed ☒ not requested ☐ nothing listed

OHP Built Environment Resources Directory:

☒ enclosed ☐ not requested ☐ nothing listed

Archaeological Determinations of Eligibility:

☐ enclosed ☐ not requested ☒ nothing listed

CA Inventory of Historic Resources (1976):

☒ enclosed ☐ not requested ☐ nothing listed

***Notes:**

****** Current versions of these resources are available on-line:

Caltrans Bridge Survey: <http://www.dot.ca.gov/hq/structur/strmaint/historic.htm>

Soil Survey: <http://www.nrcs.usda.gov/wps/portal/nrcs/surveylist/soils/survey/state/?stateId=CA>

Shipwreck Inventory: <http://www.slc.ca.gov/Info/Shipwrecks.html>

Please forward a copy of any resulting reports from this project to the office as soon as possible. Due to the sensitive nature of archaeological site location data, we ask that you do not include resource location maps and resource location descriptions in your report if the report is for public distribution. If you have any questions regarding the results presented herein, please contact the office at the phone number listed above.

The provision of CHRIS Data via this records search response does not in any way constitute public disclosure of records otherwise exempt from disclosure under the California Public Records Act or any other law, including, but not limited to, records related to archeological site information maintained by or on behalf of, or in the possession of, the State of California, Department of Parks and Recreation, State Historic Preservation Officer, Office of Historic Preservation, or the State Historical Resources Commission.

Due to processing delays and other factors, not all of the historical resource reports and resource records that have been submitted to the Office of Historic Preservation are available via this records search. Additional information may be available through the federal, state, and local agencies that produced or paid for historical resource management work in the search area. Additionally, Native American tribes have historical resource information not in the CHRIS Inventory, and you should contact the California Native American Heritage Commission for information on local/regional tribal contacts.

Should you require any additional information for the above referenced project, reference the record search number listed above when making inquiries. Requests made after initial invoicing will result in the preparation of a separate invoice.

Thank you for using the California Historical Resources Information System (CHRIS).

Sincerely,

Annette Neal

Researcher

Report List

Report No.	Other IDs	Year	Author(s)	Title	Affiliation	Resources
S-031929	Caltrans - EA 04-264-0A5200; Submitter - Contract No. 16009	2006	Leigh Martin and William Self	Historic Property Survey Report, Solano North Connector, Fairfield, Solano County, California; SOL 12 KP 3.9 (PM 2.4), SOL 80 KP 25.9 (PM 16.2), EA 04-264-0A5200, Contract No. 16009	William Self Associates, Inc	48-000487, 48-000737, 48-000738, 48-000739, 48-000740, 48-000741, 48-000742, 48-000743
S-031929a		2006	Leigh A. Martin	Archaeological Survey Report, Solano Transportation Authority, Fairfield, Solano County, California; SOL 12 KP 3.9 (PM 2.4), SOL 80 KP 25.9 (PM 16.2), EA 04-264-0A5200, Contract No. 16009	William Self Associates	
S-031929b		2006	Morgan Rieder	Historical Resources Evaluation Report, Solano North Connector, Fairfield, Solano County, California; SOL 12 KP 3.9 (PM 2.4), SOL 80 KP 25.9 (PM 16.2), EA 04-264-0A5200, Contract No. 16009	William Self Associates	

Report List

Report No.	Other IDs	Year	Author(s)	Title	Affiliation	Resources
S-045102	Caltrans - EA 0A5300; OHP PRN - FHWA091021B	2009	Madeline Bowen	Historic Property Survey Report, 1-8011- 680/SR 12 Interchange Project, California Department of Transportation, District 4, Solano County, California	ICF Jones & Stokes	48-000103, 48-000384, 48-000385, 48-000446, 48-000447, 48-000448, 48-000449, 48-000450, 48-000451, 48-000452, 48-000453, 48-000454, 48-000455, 48-000456, 48-000457, 48-000458, 48-000459, 48-000460, 48-000463, 48-000464, 48-000465, 48-000466, 48-000467, 48-000468, 48-000469, 48-000470, 48-000471, 48-000472, 48-000473, 48-000474, 48-000475, 48-000476, 48-000477, 48-000478, 48-000479, 48-000480, 48-000481, 48-000482, 48-000483, 48-000484, 48-000485, 48-000486, 48-000487, 48-000491, 48-000542, 48-000549, 48-000737, 48-000738, 48-000739, 48-000740, 48-000786, 48-000809, 48-001596, 48-001639, 48-001640, 48-001641, 48-001642, 48-001643, 48-001644, 48-001645, 48-001646, 48-001647, 48-001648, 48-001649, 48-001650, 48-001651, 48-001652, 48-001653, 48-001654, 48-001655, 48-001656, 48-001657, 48-001658, 48-001659, 48-001660, 48-001661, 48-001662, 48-001663, 48-001664, 48-001665, 48-001666, 48-001667, 48-001668, 48-001669, 48-001670, 48-001671, 48-001672, 48-001673, 48-001674, 48-001675, 48-001676, 48-001677, 48-001678, 48-001679, 48-001680, 48-001681, 48-001682, 48-001683, 48-001684, 48-001685, 48-001686, 48-001687, 48-001688, 48-001689, 48-001690, 48-001691, 48-001692, 48-001693, 48-001694, 48-001695, 48-001696, 48-001697, 48-001698, 48-001699, 48-001700, 48-001701, 48-001702, 48-001703, 48-001704, 48-001705, 48-001706, 48-001707, 48-001708, 48-001709, 48-001710, 48-001711, 48-001712, 48-001713, 48-001714, 48-001715, 48-001716, 48-001717, 48-001718, 48-001719, 48-001720, 48-001721, 48-001722, 48-001723,

Report List

Report No.	Other IDs	Year	Author(s)	Title	Affiliation	Resources
						48-001724, 48-001725, 48-001726, 48-001727, 48-001728, 48-001729, 48-001730, 48-001731, 48-001732, 48-001733, 48-001734, 48-001735, 48-001736, 48-001737, 48-001738, 48-001739, 48-001740, 48-001741, 48-001742, 48-001743, 48-001744, 48-001745, 48-001746, 48-001747, 48-001748, 48-001749, 48-001750, 48-001751, 48-001752, 48-001753, 48-001754, 48-001755, 48-001756, 48-001757, 48-001758, 48-001759, 48-001760, 48-001761, 48-001762, 48-001763, 48-001764, 48-001765, 48-001766, 48-001767, 48-001768, 48-001769, 48-001770, 48-001771, 48-001772, 48-001773, 48-001774, 48-001775, 48-001776, 48-001777, 48-001778, 48-001779, 48-001780, 48-001781, 48-001782, 48-001783, 48-001784, 48-001785, 48-001786, 48-001787, 48-001788, 48-001789, 48-001790, 48-001791, 48-001792, 48-001793, 48-001794, 48-001795, 48-001796, 48-001797, 48-001798, 48-001799, 48-001800
S-045102a		2009	Madeline Bowen	Historical Resources Evaluation Report I-80/I-680/SR12 Interchange Project CA Department of Transportation, District 4 Solano County, CA	ICF Jones & Stokes	
S-045102b		2009	Alisa Reynolds	Archaeological Survey Report, 1-8011-680JSR 12 Interchange Project, California Department of Transportation, District 4, Solano County, California; 04-SOL-80 PM 10.8-17.0; 04-SOL-680 PM 10.0-13.1; 04-SOL-SR 12W PM 1.7-2.8; and 04-SOL-SR 12E PM 1.8-4.8	ICF Jones & Stokes	
S-045102c		2011	Alisa Reynolds	Historic Property Treatment Plan, I-80/I-680/SR 12 Interchange Project, California Department of Transportation, District 4, Solano County, California, EA 0A5300	ICF Jones & Stokes	

Report List

Report No.	Other IDs	Year	Author(s)	Title	Affiliation	Resources
S-045102d		2011	Anmarie Medin	[FHWA091021B]; Submittal of draft Programmatic Agreement Being Prepared for the Interstate 680/State Route 12 Interchange Project, Solano County, California	Department of Transportation, Division of Environmental Analysis; Office of Historic Preservation	
S-045102e		2010	Alisa Reynolds,	Archaeological Extended Phase I and Geoarchaeological Assessment	ICF Jones & Stokes	
S-045102f		2009	Milford Wayne Donaldson and Jennifer Darcangelo	FHWA091021B Historic Property Survey Report for the I-80/I-680/SR-12 interchange project in Solano County (EA 0A5300)	California Department of Transportation District 4; Office of Historic Preservation	
S-048541	Caltrans - STPL 5923 (109)	2015	Sean Michael Jensen	Suisun Valley Bicycle and Pedestrian Improvements Project Solano County, CA	Genesis Society	48-000188
S-048541a		2015	Sean Michael Jensen	ESA Action Plan Suisun Valley Bicycle & Pedestrian Improvements Project Solano County, CA	Genesis Society	
S-048541b		2015	Sean Michael Jensen	Archaeological Survey Report for Suisun Valley Bicycle and Pedestrian Improvements Project Solano County, CA	Genesis Society	



- | | | | | | |
|---|-------------------------|---|----------------------|---|--------------------|
|  | ECWinery_5 mi. Buffer |  | Resources approx loc |  | Reports approx loc |
|  | E&C Winery Project Area |  | Reports (points) |  | Quad outlines |
|  | Resources (lines) |  | Reports (lines) |  | County outlines |
|  | Resources (polygons) |  | Reports (polygons) | | |

E & C Winery Project Results Map #4

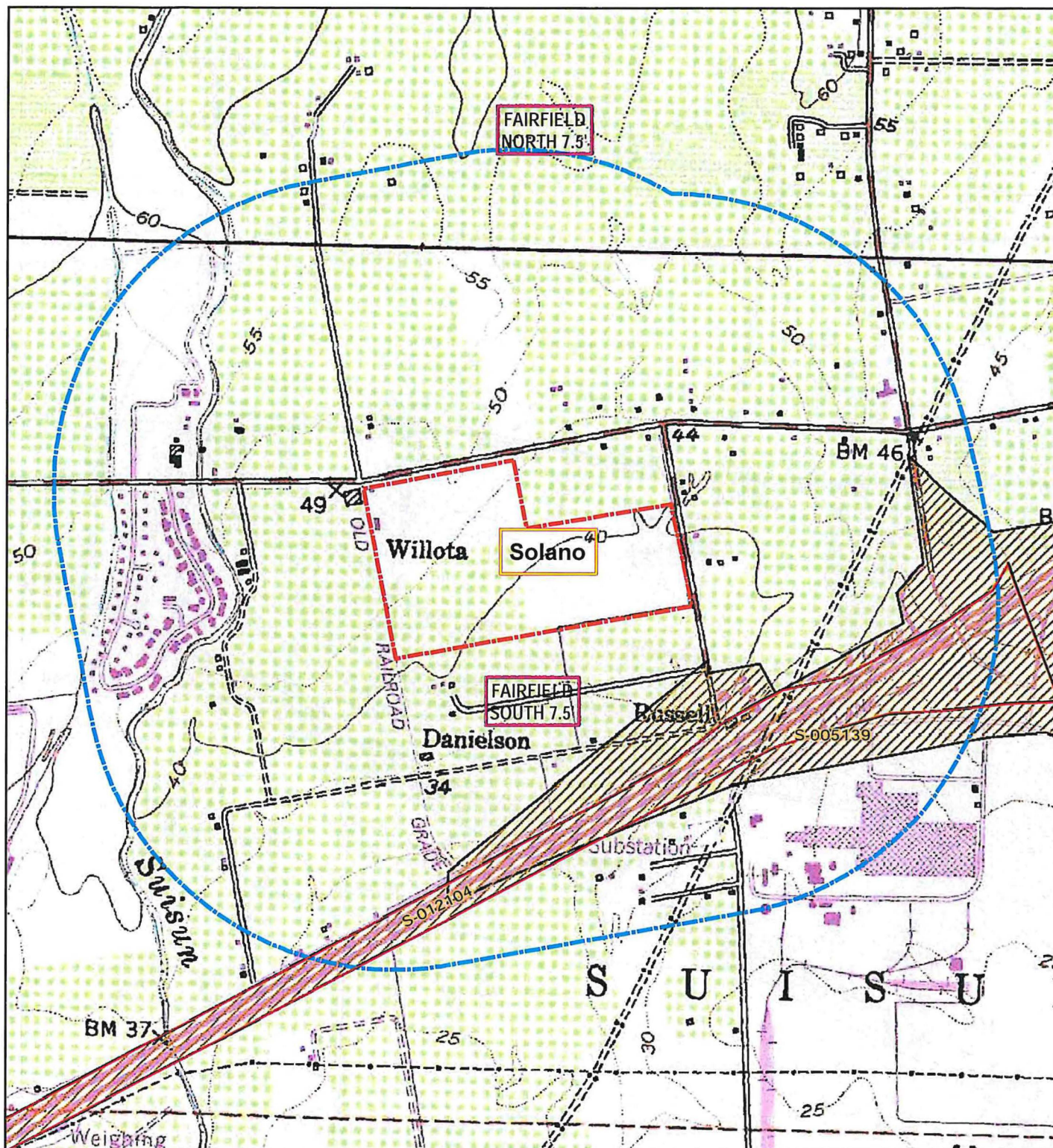

Northwest Information Center

19-2323 30 July 2020 A.Neal

May depict confidential cultural resource locations.
Do not distribute.

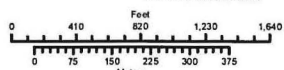

- | | | |
|-------------------------|----------------------|--------------------|
| ECWinery_5 mi. Buffer | Resources approx loc | Reports approx loc |
| E&C Winery Project Area | Reports (points) | Quad outlines |
| Resources (lines) | Reports (lines) | County outlines |
| Resources (polygons) | Reports (polygons) | |



May depict confidential cultural resource locations.
Do not distribute.

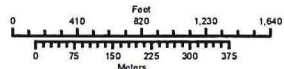

- | | | | | | |
|---|-------------------------|---|----------------------|---|--------------------|
|  | ECWinery_.5 mi. Buffer |  | Resources approx loc |  | Reports approx loc |
|  | E&C Winery Project Area |  | Reports (points) |  | Quad outlines |
|  | Resources (lines) |  | Reports (lines) |  | County outlines |
|  | Resources (polygons) |  | Reports (polygons) | | |

E & C Winery Project Results Map #2

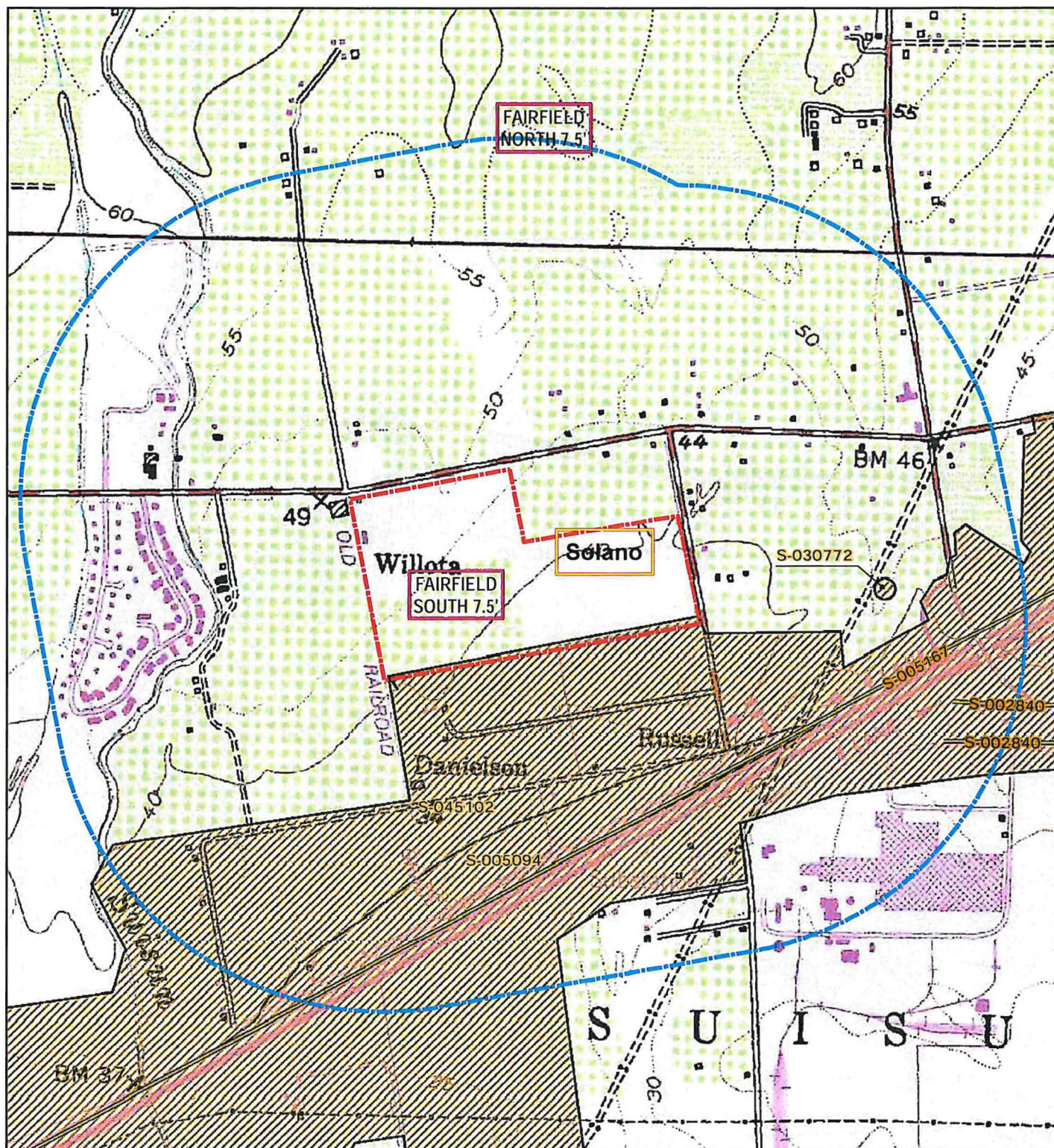

Northwest Information Center

19-2323 30 Juy 2020 A.Neal

May depict confidential cultural resource locations.
Do not distribute.

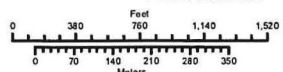

-  ECWinery_.5 mi. Buffer
  Resources approx loc
  Reports approx loc
 E&C Winery Project Area
  Reports (points)
  Quad outlines
 Resources (lines)
 Reports (lines)
 County outlines
 Resources (polygons)
 Reports (polygons)

E & C Winery Project Results Map #1

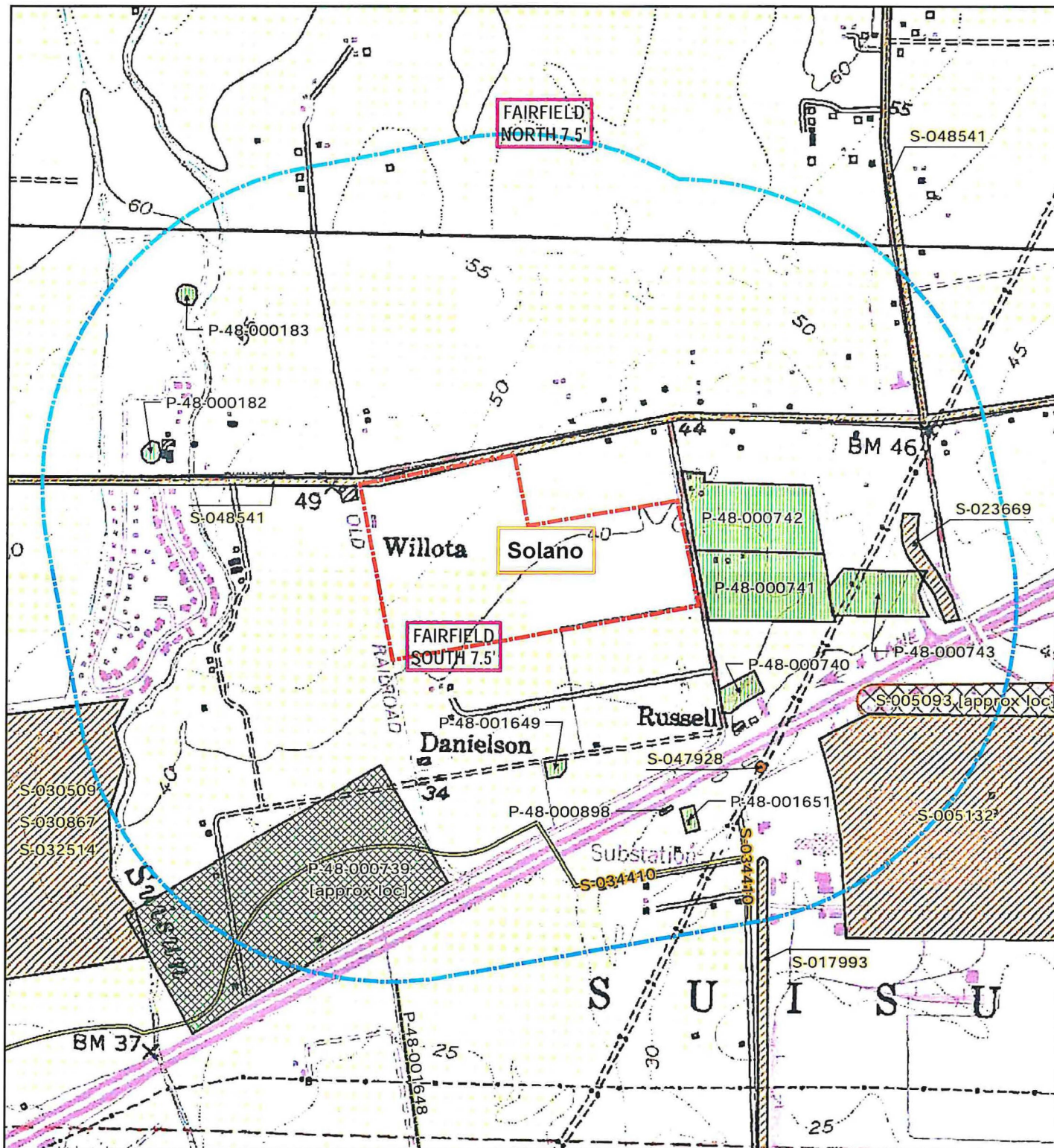

Northwest Information Center

19-2323 30 July 2020 A.Neal

May depict confidential cultural resource locations.
Do not distribute.

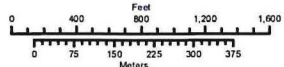

- | | | |
|-------------------------|----------------------|--------------------|
| ECWinery_5 mi. Buffer | Resources approx loc | Reports approx loc |
| E&C Winery Project Area | Reports (points) | Quad outlines |
| Resources (lines) | Reports (lines) | County outlines |
| Resources (polygons) | Reports (polygons) | |

Resource List

Primary No.	Trinomial	Other IDs	Type	Age	Attribute codes	Recorded by	Reports
P-48-000182	CA-SOL-000244	Resource Name - record missing	Site				
P-48-000183	CA-SOL-000245	Resource Name - record missing	Site				
P-48-000739		Resource Name - Valine Farm; OHP Property Number - 163633; OHP PRN - FHWA060329A	Building	Historic	HP02; HP33; HP39	2006 (William Kostura, [none]); 2007 (M. Bowen, K. Haley, ICF Jones & Stokes)	S-031929, S- 033902, S-034410, S-045102
P-48-000740		Resource Name - Del Monte Warehouses; OHP Property Number - 163634; OHP PRN - FHWA060329A; Other - Map Reference #58; Other - 0027510040	Building	Historic	HP08	2003 (William Kostura, [none]); 2007 (M. Bowen, K. Haley, ICF Jones & Stokes)	S-031929, S-045102
P-48-000741		Resource Name - 4136 Russell Road; OHP Property Number - 163635; OHP PRN - FHWA060329A	Building	Historic	HP02; HP33	2003 (William Kostura, [none])	S-031929
P-48-000742		Resource Name - 4164 Russell Road; OHP Property Number - 163636; OHP PRN - FHWA060329A	Building	Historic	HP02; HP33	2003 (William Kostura, [none])	S-031929
P-48-000743		Resource Name - Green Valley Tractor; OHP Property Number - 163638; OHP PRN - FHWA060329A	Building, Structure	Historic	HP33	2003 (William Kostura, [none])	S-031929, S-050659
P-48-000898		Resource Name - Hale Site; Other - Exploratory Area 4, Trench 4-2 and 4-11	Site	Prehistoric	AP09; AP15	2011 (Jack Meyer and Phil Kajankoski, Far Western)	S-038627, S- 048993, S-049780
P-48-001648		Resource Name - Irrigation Ditch; Other - Map Reference #54	Structure	Historic	HP20	2007 (Madeline Bowen, Katie Haley, ICF Jones & Stokes)	S-045102
P-48-001649		Resource Name - 4012 Russel Road; Other - Map Reference # 55	Building	Historic	HP33	2008 (M. Bowen, K. Haley, ICF Jones & Stokes)	S-045102
P-48-001651		Resource Name - 4015 Hale Ranch Road; Other - Map Reference #57; OHP Property Number - 174946; OHP PRN - FHWA090126B	Building	Historic	HP33	2007 (Madeline Bowen, Kathryn Haley, ICF Jones & Stokes)	S-045102

Report List

Report No.	Other IDs	Year	Author(s)	Title	Affiliation	Resources
S-002840	Caltrans - 10102-071600; Voided - ASC #351c	1981	Wayne C. Wiant	First Addendum Archaeological Survey for the Proposed Fairfield Bypass Project, Solano County, 10-Sol-12/80 R3.1/R6.2, 15.0/16.8, 10102-071600.	Caltrans, District 10	
S-005093	Voided - ASC #351a	1977	D. L. True	Archaeological Survey: Realignment of Highway 12, Fairfield, California.	University of California, Davis	
S-005094	Voided - ASC #351b	1978	D. L. True	Archaeological Survey Near Fairfield, California: Alternate Route for Highway 12.	University of California, Davis	
S-005132	Voided - ASC #388	1979	Theo N. Mabry	Archaeological Records Search and Reconnaissance Survey, Fairfield Redevelopment Project, Fairfield, CA.	Archaeological Planning Collaborative	
S-005139	Voided - ASC #530	1980	David Chavez	Archaeological evaluation of the Area of Potential Environmental Impact (APEI) for the Interstate 80/Highway 12 Interchange Project (letter report)		
S-005148	Voided - ASC #607	1980	Eleanor H. Derr	An Archeological Survey of the Fairfield Linear Park, Solano County, California.	Archeological Study Center, California State University, Sacramento	
S-005167	Voided - ASC #720a	1980	David Chavez	Cultural Resources Evaluation of the North Bay Aqueduct Alignment Alternatives (Routes 1, 4 and 6), Solano County, California.		48-000109, 48-000119, 48-000120
S-012104	Caltrans - 04136-006010	1990	Michael W. Love	Negative Archaeological Survey Report: Addendum 1, Two Additions to the New Benicia/Martinez Bridge System Project, 04-SOL-080 P.M. 0.0/1.0, 12.0/16.15, 04136-006010	Caltrans, District 04	

Report List

Report No.	Other IDs	Year	Author(s)	Title	Affiliation	Resources
S-017993		1995	Brian Hatoff, Barb Voss, Sharon Waechter, Stephen Wee, and Vance Bente	Cultural Resources Inventory Report for the Proposed Mojave Northward Expansion Project	Woodward-Clyde Consultants	01-000231, 01-001775, 01-001776, 01-001783, 01-002190, 01-010620, 01-010629, 01-011603, 07-000091, 07-000402, 07-000438, 07-000487, 07-000488, 07-000489, 07-000490, 07-000499, 07-000500, 07-000501, 07-000502, 07-000504, 07-000806, 07-000813, 07-002402, 07-002695, 35-000334, 38-000007, 41-000009, 41-000165, 41-000169, 41-000172, 41-000310, 41-000311, 41-000410, 41-000411, 41-000412, 41-000413, 41-000414, 41-000415, 41-000416, 41-000417, 41-000418, 41-000419, 41-000420, 41-000421, 41-000422, 41-000423, 41-000424, 41-000425, 41-000456, 41-000632, 41-000808, 43-000623, 43-000649, 43-000650, 43-000903, 43-000928, 48-000179, 48-000180, 48-000207, 48-000208, 48-000549, 48-000955
S-017993a		1995		Proposed Mojave Northward Expansion Project: Appendix A - Native American Consultation	Woodward-Clyde Consultants	
S-017993b		1995		Proposed Mojave Northward Expansion Project: Appendix B - Looping Segments - Class 1	Woodward-Clyde Consultants	
S-017993c		1995		Proposed Mojave Northward Expansion Project: Appendix C - Monitoring and Emergency Discovery Plan	Woodward-Clyde Consultants	
S-017993d		1995		Proposed Mojave Northward Expansion Project: Appendix D - General Construction Information	Woodward-Clyde Consultants	
S-017993e		1995		Proposed Mojave Northward Expansion Project: Appendix E - Archaeological Site Records	Woodward-Clyde Consultants	
S-017993f		1995		Proposed Mojave Northward Expansion Project: Appendix F - Historic Features Evaluation Forms	Woodward-Clyde Consultants	
S-017993g		1995		Proposed Mojave Northward Expansion Project: Appendix G - Railroad Crossing Evaluation Forms	Woodward-Clyde Consultants	

Report List

Report No.	Other IDs	Year	Author(s)	Title	Affiliation	Resources
S-017993h		1995		Proposed Mojave Northward Expansion Project: Appendix H - Crossing Diagrams and Plan View Maps	Woodward Clyde Consultants	
S-017993i		1995		Proposed Mojave Northward Expansion Project: Appendix I - Railroad Depot NRHP Nomination Forms and Related Records	Woodward-Clyde Consultants	
S-017993j		1995		Proposed Mojave Northward Expansion Project: Appendix J - Looping Segment and Compressor Station Site Records	Woodward-Clyde Consultants	
S-017993k		1995		Proposed Mojave Northward Expansion Project: Appendix K - Historic Site Records / Isolate Forms	Woodward-Clyde Consultants	
S-017993l		1995		Proposed Mojave Northward Expansion Project: Appendix L - Photodocumentation	Woodward-Clyde Consultants	
S-017993m		1995		Proposed Mojave Northward Expansion Project: Appendix M - Curricula Vitae of Key Preparers	Woodward-Clyde Consultants	
S-023669		2001	Charlane Gross	Negative Archaeological Survey Report for the Proposed Abernathy Bike Path Construction Project, Solano County, California	KEA Environmental, Inc.	
S-024034	Caltrans - EA 04-249-OT1600	2001	Kathleen McBride	Historic Property Survey Report for the Proposed Reconfiguration of I-80/I-680 Interchange Connectors and Construction of Interstate 80 Auxiliary Lanes, 04-Sol-80 KP 20.6/25.59 (PM 12.8/15.9) EA 04-249-OT1600	Caltrans, District 4	48-000527, 48-000528
S-024034a		2001	Jennifer A. Ferneau	Negative Archaeological Survey Report for the Proposed Reconfiguration of I-80/I-680 Interchange Connectors and Construction of Interstate 80 Auxiliary Lanes, 04-Sol-80 KP 20.6/25.59 (PM 12.8/15.9) EA 04-249-OT1600	Caltrans, District 04	
S-030509	Submitter - Project RY148 54/05	2005	Heidi Koenig	A Cultural Resources Study for Solano Community College, Fairfield, Solano County, California	Anthropological Studies Center, Sonoma State University	48-000087, 48-000722
S-030772		2005	Carolyn Losee	4135 Abernathy Road, Fairfield, Solano, CA., Collocation ("CO") Submission Packet FCC Form 621	Archaeological Resources Technology	
S-030772a		2005	Carolyn Losee	Cingular Wireless Site NB-108-01 "Green Valley Tractor/PG&E Tower" (letter report)	Archaeological Resources Technology	

Report List

Report No.	Other IDs	Year	Author(s)	Title	Affiliation	Resources
S-030867	Submitter - RY 148 Job 54-05	2005	Jack McIlroy and Adrian Praetzelis	Archaeological Test Excavations at Solano Community College, Fairfield, California (CA- SOL-243 Vicinity)	Anthropological Studies Center, Sonoma State University	48-000087
S-032514	Submitter - QA705 75/05	2006	Michael Stoyka and Adrian Praetzelis	Archaeological Monitoring for Hot and Cold Water Conveyance Replacement at Solano Community College, Fairfield, California	Anthropological Studies Center, Sonoma State University.	
S-034410	Submitter - LSA Project No. CND0701; Submitter - LSA Project No. CND1301; Submitter - LSA Project No. CND230	2007	E. Timothy Jones	A Cultural and Paleontological Resources Study for the East-West Water Transmission Pipeline Project, Phase 2, Fairfield, Solano County, California	LSA Associates, Inc.	48-000143, 48-000199, 48-000549, 48-000739
S-034410a		2005	E. Timothy Jones and Ben Matzen	A Cultural and Paleontological Resources Study for the East-West Water Transmission Pipeline Project	LSA Associates, Inc.	
S-034410b		2016	John Kelley	Addendum for the East-West Water Transmission Pipeline, Segment 4 Section, Fairfield, Solano County, California (LSA Project No. CND1301)	LSA Associates, Inc.	
S-034410c		2018	Julianne Polanco and Rick M. Bottoms	[COE_2018_1004_001] Section 106 Consultation for the City of Fairfield's proposed installation of 675 linear feet of water transmission pipeline in Fairfield, Solano County, California (Corps File Number 2018-00349N)	Office of Historic Preservation, Department of the Army	
S-047928	OHP PRN - FCC_2015_1019_008	2015	Carrie D. Wills and Kathleen Crawford	FCC Form 621 Collocation Submission Packet: BA00402A (SF402 PG&E Tower- Budweiser) 301 Busch Drive, Fairfield, CA 94534	Environmental Assessment Specialists, Inc.	
S-047928a		2015	Carrie D. Wills and Kathleen A. Crawford	Cultural Resources Records Search for T- Mobile West, LLC Candidate BA00402A (SF402 PG&E Tower-Budweiser) 301 Busch Drive, Fairfield, Solano County, California	Environmental Assessment Specialists, Inc.	
S-047928b		2015	Carrie D. Wills and Kathleen A. Crawford	Direct APE Historic Architectural Assessment for T-Mobile West, LLC Candidate BA00402A (SF402 PG&E Tower-Budweiser) 301 Busch Drive, Fairfield, Solano County, California	Environmental Assessment Specialists, Inc.	

Report List

Report No.	Other IDs	Year	Author(s)	Title	Affiliation	Resources
S-047928c		2015	Julianne Polanco	FCC_2015_1019_008: BA00402A (SF402 PG&E Tower-Budweiser) 301 Busch Drive, Fairfield, Collocation	Office of Historic Preservation	
S-048993	Caltrans - 0412000332; Caltrans - 04-SOL-80 PM 10.4/30.2; Caltrans - EA 04-4G0800	2014	Nathan Stevens and Jack Meyer	Archaeological Survey Report for the Interstate-80 Express Lanes Project from Red Top Road to I-505 in Solano County	Far Western Anthropological Research Group, Inc.	48-000038, 48-000049, 48-000111, 48-000157, 48-000897, 48-000898

Attachment D

Representative Project Area Photographs



Figure 1. Project area overview - view to west and tilled field



Figure 2. Project area overview - view to east and newly planted corn crop



Figure 3. Project area overview - view to north



Figure 4. Project area overview, recently harvested hay field - view to southeast

Solano County Environmental Health Services Division

VALERO BENICIA REFINERY COMMUNITY ADVISORY PANEL
COMMUNITY EDUCATION NIGHT
COLBY LAPLACE, SENIOR HAZARDOUS MATERIALS SPECIALIST

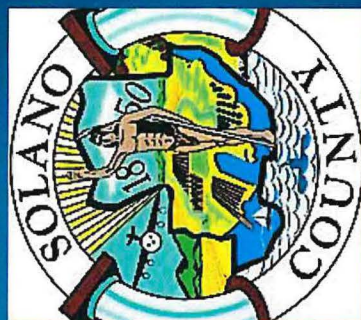

Certified Unified Program Agency (CUPA)

- A Certified Unified Program Agency (CUPA) is a local agency that is certified every three years by the California Environmental Protection Agency (CalEPA) to implement several state regulatory inspection initiatives, consolidate the enforcement of state and local hazardous materials and waste laws, and perform emergency response functions.
- In 1993, California Governor Pete Wilson signed California Senate Bill 1082, which established the CUPA program and Solano County's Hazardous Materials division which was recognized by Cal-EPA as having jurisdiction.
- Following the Richmond Chevron Refinery Crude Unit Fire on August 6, 2012, Governor Brown initiated the formation of the Interagency Refinery Task Force (IRTF) to draft regulations with input from others.
- The IRTF group is comprised of following agencies:
 - CUPA's with Refineries
 - Cal-OSHA Process Safety Group
 - Air Quality Management Districts
 - California Air Resources Board
 - Office of Emergency Services
 - Local Fire Agencies

Solano County Hazardous Materials Division

- Solano County CUPA develops *Guidance Documents* for stationary source facilities located within Solano County and implements the following 6 state regulatory inspection functions:
 - Hazardous Materials Business Plans
 - Hazardous Waste Generators
 - Underground Storage Tanks
 - Above Ground Petroleum Storage Tanks
 - CalARP Program
- Solano County CUPA inspects the Valero Refinery for all of these programs except HHW and files reports on each of these inspections. We also conduct audits, unannounced inspections & review Risk Management and Safety Plans
- Issue public reports regarding investigation reports, audits and plan reviews of stationary source facilities. [City of Benicia Fire Department - Public Information Bank](#)
- Publish Solano County's Hazardous Materials Business Plan (HMBP) & Risk Assessment and Release Reporting
- Collaborate with Contra Costa County's [Community Awareness Emergency Response](#) (CAER), Community Warning System (CWS) and [Alert Solano](#) to provide cross-county timely release event notifications and information
- Perform public outreach at local events (eg: Benicia Peddler's Fair) and Solano CUPA issues public reports regarding investigation reports, audits and plan reviews of stationary source facilities.

California Accident Release Prevention

- The California Accident Release Prevention (Cal ARP) Program was created to prevent accidental releases of substances that can cause serious harm to the public and the environment, to minimize the damage if releases do occur, and to satisfy community right-to-know laws.
- The program requires that stationary sources within the state of California create a system that is updated every three years for effective communication and implementation of safety, operations, maintenance, corrective actions, recommendations and findings.
- Cal ARP Program 4 is the fourth version of the ARP plan that received extensive pre-regulatory input from refinery representatives, labor unions, refinery leadership teams, non-governmental organizations, academic experts, federal, state, and local agencies, and the public.
- The first Solano County CUPA Program 4 inspection was conducted at the Valero Benicia Refinery in November 2017 and lasted until April 2018. We performed one on-site inspection per week and many documents reviewed on-site, too. No major violations were identified during this inspection.

CalARP Program

Prevent major incidents
at petroleum refineries
in order to protect the
health and safety of
communities and the
environment

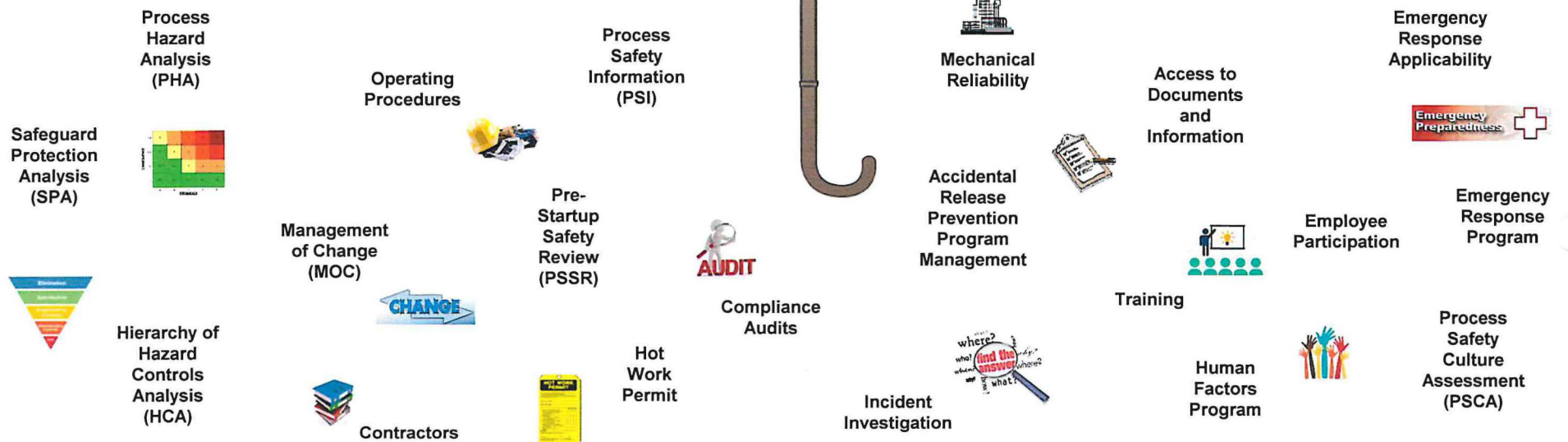

CalARP Program 4 Compliance

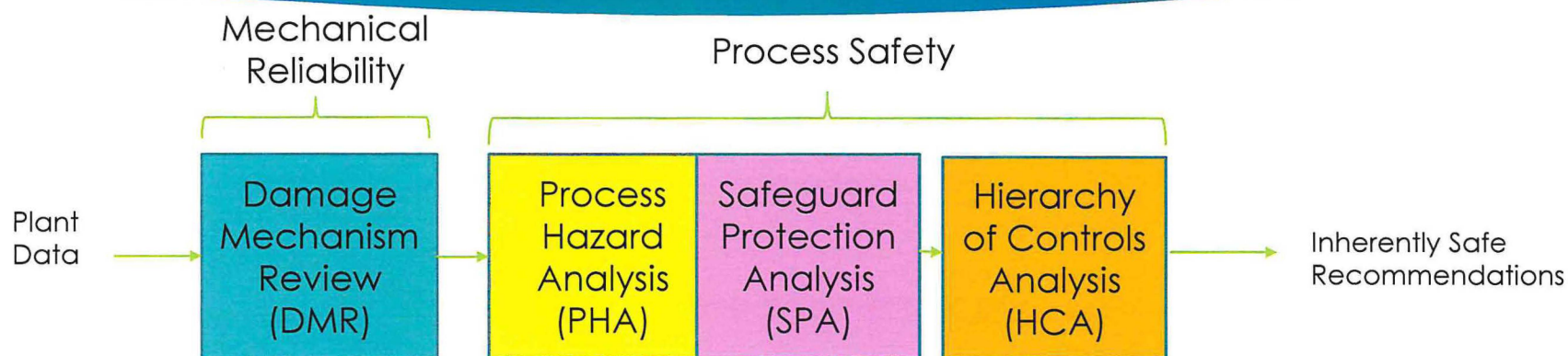

Program 4 Compliance Requirements:

- ✓ ► DMR, PHA, SPA, and HCA- 50% completion by 3Q2020
- ✓ ► Human Factors in Procedures Reviews- 50% completion by 3Q2020
- ✓ ► Process Safety Culture Assessment- completion by 1Q2019
- ✓ ► Process Safety Information Reporting- yearly

A comprehensive CalARP Program 4 audit was conducted in 2017-2018.



Contact Information

Colby S LaPlace

Senior Hazardous Materials Specialist
Solano County Environmental Health Services Division

675 Texas Street

Suite 5500

Fairfield, CA 94533

Main Office: 707-784-6765

Direct Line: 707-784-3318

Cell: 707-816-7848

Fax: 707-784-4805

cslaplace@solanocounty.com

