

INITIAL STUDY/NEGATIVE DECLARATION

[Pursuant to Public Resources Code Section 21080(c) and California Code of Regulations, Title 14, Sections 15070-15071]

LEAD AGENCY: San Joaquin County Community Development Department

PROJECT APPLICANT: Costco Wholesale

PROJECT TITLE/FILE NUMBER(S): PA-1900143 (SA)

PROJECT DESCRIPTION: A Site Approval application for an unmanned trailer parking and storage facility for a maximum of 200 trailers. The project includes the construction of an 80-square foot restroom building, and the removal of all existing structures and existing septic system. This project site is served by an existing private well for water supply, and proposes a new onsite septic system, and new onsite retention pond and bio-swale. Access to the facility will be permitted seven (7) days per week, twenty-four (24) hours per day through a single, secured, gated driveway that fronts S. Hansen Road. (Use Type: Truck Sales & Services – Parking)

The project site is located on the west side of S. Hansen Road, 4,500 feet south of Schulte Road, west of Tracy.

ASSESSORS PARCEL NO(S): 209-110-10

ACRES: 15.38

GENERAL PLAN: I/G

ZONING: I-G/S-8

POTENTIAL POPULATION, NUMBER OF DWELLING UNITS, OR SQUARE FOOTAGE OF USE(S):
An 80 square foot restroom.

SURROUNDING LAND USES:

NORTH: Industrial

SOUTH: Industrial with a residence.

EAST: Industrial

WEST: Industrial

REFERENCES AND SOURCES FOR DETERMINING ENVIRONMENTAL IMPACTS:

Original source materials and maps on file in the Community Development Department including: all County and City general plans and community plans; assessor parcel books; various local and FEMA flood zone maps; service district maps; maps of geologic instability; maps and reports on endangered species such as the Natural Diversity Data Base; noise contour maps; specific roadway plans; maps and/or records of archeological/historic resources; soil reports and maps; etc.

Many of these original source materials have been collected from other public agencies or from previously prepared EIR's and other technical studies. Additional standard sources which should be specifically cited below include on-site visits by staff (note date); staff knowledge or experience; and independent environmental studies submitted to the County as part of the project application (**Air Quality Assessment (CalEEMod), September 2019, E-Tech Environmental**). Copies of these reports can be found by contacting the Community Development Department.

TRIBAL CULTURAL RESOURCES:

Have California Native American tribes traditionally and culturally affiliated with the project area requested consultation pursuant to Public Resources Code section 21080.3.1? If so, is there a plan for consultation that includes, for example, the determination of significance of impacts to tribal cultural resources, procedures regarding confidentiality, etc.?

No.

GENERAL CONSIDERATIONS:

1. Does it appear that any environmental feature of the project will generate significant public concern or controversy?

PA-1900143 (SA) – Initial Study

☐ Yes ☒ No

Nature of concern(s): Enter concern(s).

2. Will the project require approval or permits by agencies other than the County?

☐ Yes ☒ No

Agency name(s): Enter agency name(s).

3. Is the project within the Sphere of Influence, or within two miles, of any city?

☒ Yes ☐ No

City: Tracy

ENVIRONMENTAL FACTORS POTENTIALLY AFFECTED:

The environmental factors checked below would be potentially affected by this project, involving at least one impact that is a "**Potentially Significant Impact**" as indicated by the checklist on the following pages.

<input type="checkbox"/> Aesthetics	<input type="checkbox"/> Agriculture and Forestry Resources	<input type="checkbox"/> Air Quality
<input type="checkbox"/> Biological Resources	<input type="checkbox"/> Cultural Resources	<input type="checkbox"/> Energy
<input type="checkbox"/> Geology / Soils	<input type="checkbox"/> Greenhouse Gas Emissions	<input type="checkbox"/> Hazards & Hazardous Materials
<input type="checkbox"/> Hydrology / Water Quality	<input type="checkbox"/> Land Use / Planning	<input type="checkbox"/> Mineral Resources
<input type="checkbox"/> Noise	<input type="checkbox"/> Population / Housing	<input type="checkbox"/> Public Services
<input type="checkbox"/> Recreation	<input type="checkbox"/> Transportation	<input type="checkbox"/> Tribal Cultural Resources
<input type="checkbox"/> Utilities / Service Systems	<input type="checkbox"/> Wildfire	<input type="checkbox"/> Mandatory Findings of Significance

DETERMINATION: (To be completed by the Lead Agency) On the basis of this initial evaluation:

- ☐ I find that the proposed project **COULD NOT** have a significant effect on the environment, and a **NEGATIVE DECLARATION** will be prepared.
- ☒ I find that although the proposed project could have a significant effect on the environment, there will not be a significant effect in this case because revisions in the project have been made by or agreed to by the project proponent. A **MITIGATED NEGATIVE DECLARATION** will be prepared.
- ☐ I find that the proposed project MAY have a significant effect on the environment, and an **ENVIRONMENTAL IMPACT REPORT** is required.
- ☐ I find that the proposed project **MAY** have a "potentially significant impact" or "potentially significant unless mitigated" impact on the environment, but at least one effect 1) has been adequately analyzed in an earlier document pursuant to applicable legal standards, and 2) has been addressed by mitigation measures based on the earlier analysis as described on attached sheets. An **ENVIRONMENTAL IMPACT REPORT** is required, but it must analyze only the effects that remain to be addressed.
- ☐ I find that although the proposed project could have a significant effect on the environment, because all potentially significant effects (a) have been analyzed adequately in an earlier **EIR** or **NEGATIVE DECLARATION** pursuant to applicable standards, and (b) have been avoided or mitigated pursuant to that earlier **EIR** or **NEGATIVE DECLARATION**, including revisions or mitigation measures that are imposed upon the proposed project, nothing further is required.

Signature 

Date 16 Jan 2020

EVALUATION OF ENVIRONMENTAL IMPACTS:

- 1) A brief explanation is required for all answers except "No Impact" answers that are adequately supported by the information sources a lead agency cites in the parentheses following each question. A "No Impact" answer is adequately supported if the referenced information sources show that the impact simply does not apply to projects like the one involved (e.g., the project falls outside a fault rupture zone). A "No Impact" answer should be explained where it is based on project-specific factors as well as general standards (e.g., the project will not expose sensitive receptors to pollutants, based on a project-specific screening analysis).
- 2) All answers must take account of the whole action involved, including off-site as well as on-site, cumulative as well as project-level, indirect as well as direct, and construction as well as operational impacts.
- 3) Once the lead agency has determined that a particular physical impact may occur, then the checklist answers must indicate whether the impact is potentially significant, less than significant with mitigation, or less than significant. "Potentially Significant Impact" is appropriate if there is substantial evidence that an effect may be significant. If there are one or more "Potentially Significant Impact" entries when the determination is made, an EIR is required.
- 4) "Negative Declaration: Less Than Significant With Mitigation Incorporated" applies where the incorporation of mitigation measures has reduced an effect from "Potentially Significant Impact" to a "Less Than Significant Impact." The lead agency must describe the mitigation measures, and briefly explain how they reduce the effect to a less than significant level (mitigation measures from "Earlier Analyses," as described in (5) below, may be cross-referenced).
- 5) Earlier analyses may be used where, pursuant to the tiering, program EIR, or other CEQA process, an effect has been adequately analyzed in an earlier EIR or negative declaration. Section 15063(c)(3)(D). In this case, a brief discussion should identify the following:
 - a) Earlier Analysis Used. Identify and state where they are available for review.
 - b) Impacts Adequately Addressed. Identify which effects from the above checklist were within the scope of and adequately analyzed in an earlier document pursuant to applicable legal standards, and state whether such effects were addressed by mitigation measures based on the earlier analysis.
 - c) Mitigation Measures. For effects that are "Less than Significant with Mitigation Measures Incorporated," describe the mitigation measures which were incorporated or refined from the earlier document and the extent to which they address site-specific conditions for the project.
- 6) Lead agencies are encouraged to incorporate into the checklist references to information sources for potential impacts (e.g., general plans, zoning ordinances). Reference to a previously prepared or outside document should, where appropriate, include a reference to the page or pages where the statement is substantiated.
- 7) Supporting Information Sources: A source list should be attached, and other sources used or individuals contacted should be cited in the discussion.
- 8) This is only a suggested form, and lead agencies are free to use different formats; however, lead agencies should normally address the questions from this checklist that are relevant to a project's environmental effects in whatever format is selected.
- 9) The explanation of each issue should identify:
 - a) the significance criteria or threshold, if any, used to evaluate each question; and
 - b) the mitigation measure identified, if any, to reduce the impact to less than significance.

ISSUES:

	Potentially Significant Impact	Less Than Significant with Mitigation Incorporated	Less Than Significant Impact	No Impact	Analyzed In The Prior EIR
<u>I. AESTHETICS.</u>					
Except as provided in Public Resources Code Section 21099, would the project:					
a) Have a substantial adverse effect on a scenic vista?	<input type="checkbox"/>	<input type="checkbox"/>	<input type="checkbox"/>	<input checked="" type="checkbox"/>	<input type="checkbox"/>
b) Substantially damage scenic resources, including, but not limited to, trees, rock outcroppings, and historic buildings within a state scenic highway?	<input type="checkbox"/>	<input type="checkbox"/>	<input type="checkbox"/>	<input checked="" type="checkbox"/>	<input type="checkbox"/>
c) In non-urbanized areas, substantially degrade the existing visual character or quality of public views of the site and its surroundings? (Public views are those that are experienced from publically accessible vantage point). If the project is in an urbanized area, would the project conflict with applicable zoning and other regulations governing scenic quality?	<input type="checkbox"/>	<input type="checkbox"/>	<input type="checkbox"/>	<input checked="" type="checkbox"/>	<input type="checkbox"/>
d) Create a new source of substantial light or glare which would adversely affect day or nighttime views in the area?	<input type="checkbox"/>	<input type="checkbox"/>	<input type="checkbox"/>	<input checked="" type="checkbox"/>	<input type="checkbox"/>

Impact Discussion:

- a-d) The proposed project site is located on South Hansen Road in the unincorporated, urban community of Tracy. Pursuant to San Joaquin County General Plan 2035 Natural and Cultural Resources Element Figure NCR-1 (page 3.4-13), this section of South Hansen Road is not a designated Scenic Route. Therefore the project will have to impact on a scenic vista.

Potentially Significant Impact	Less Than Significant with Mitigation Incorporated	Less Than Significant Impact	No Impact	Analyzed In The Prior EIR
--------------------------------------	---	------------------------------------	--------------	---------------------------------

II. AGRICULTURE AND FORESTRY RESOURCES.

In determining whether impacts to agricultural resources are significant environmental effects, lead agencies may refer to the California Agricultural Land Evaluation and Site Assessment Model (1997) prepared by the California Dept. of Conservation as an optional model to use in assessing impacts on agriculture and farmland. In determining whether impacts to forest resources, including timberland, are significant environmental effects, lead agencies may refer to information compiled by the California Department of Forestry and Fire Protection regarding the state's inventory of forest land, including the Forest and Range Assessment Project and the Forest Legacy Assessment project; and forest carbon measurement methodology provided in Forest Protocols adopted by the California Air Resources Board. -- Would the project:

- | | | | | | |
|--|--------------------------|--------------------------|--------------------------|-------------------------------------|--------------------------|
| a) Convert Prime Farmland, Unique Farmland, or Farmland of Statewide Importance (Farmland), as shown on the maps prepared pursuant to the Farmland Mapping and Monitoring Program of the California Resources Agency, to nonagricultural use? | <input type="checkbox"/> | <input type="checkbox"/> | <input type="checkbox"/> | <input checked="" type="checkbox"/> | <input type="checkbox"/> |
| b) Conflict with existing zoning for agricultural use, or a Williamson Act contract? | <input type="checkbox"/> | <input type="checkbox"/> | <input type="checkbox"/> | <input checked="" type="checkbox"/> | <input type="checkbox"/> |
| c) Conflict with existing zoning for, or cause rezoning of, forest land (as defined in Public Resources Code section 12220(g)), timberland (as defined by Public Resources Code section 4526), or timberland zoned Timberland Production (as defined by Government Code section 51104(g))? | <input type="checkbox"/> | <input type="checkbox"/> | <input type="checkbox"/> | <input checked="" type="checkbox"/> | <input type="checkbox"/> |
| d) Result in the loss of forest land or conversion of forest land to non-forest use? | <input type="checkbox"/> | <input type="checkbox"/> | <input type="checkbox"/> | <input checked="" type="checkbox"/> | <input type="checkbox"/> |
| e) Involve other changes in the existing environment which, due to their location or nature, could result in conversion of Farmland, to non-agricultural use or conversion of forest land to non-forest use? | <input type="checkbox"/> | <input type="checkbox"/> | <input type="checkbox"/> | <input checked="" type="checkbox"/> | <input type="checkbox"/> |

Impact Discussion:

a-e) The subject property is not identified or designated as Prime or Unique Farmland or as Farmland of Statewide Importance on maps provided by the California Department of Conservation's Farmland Mapping and Monitoring Program. The subject property is designated as Grazing Land (G) and Other Land (X), which is further described as Semi-Agriculture and Rural Commercial Land (sAC) by the Department of Conservation's Rural Land Mapping Project. The subject property is zoned General Industrial (I-G) and is located within an existing industrial corridor. Therefore, the proposed project will not convert important farmland to non-agricultural use or forest land to non-forest use, conflict with agricultural or forestland zoning or a Williamson Act Contract, or result in loss of forest land.

III. AIR QUALITY.

Where available, the significance criteria established by the applicable air quality management or air pollution control district may be relied upon to make the following determinations. Would the project:

	Potentially Significant Impact	Less Than Significant with Mitigation Incorporated	Less Than Significant Impact	No Impact	Analyzed In The Prior EIR
a) Conflict with or obstruct implementation of the applicable air quality plan?	<input type="checkbox"/>	<input type="checkbox"/>	<input checked="" type="checkbox"/>	<input type="checkbox"/>	<input type="checkbox"/>
b) Result in a cumulatively considerable net increase of any criteria pollutant for which the project region is non-attainment under an applicable federal or state ambient air quality standard?	<input type="checkbox"/>	<input type="checkbox"/>	<input checked="" type="checkbox"/>	<input type="checkbox"/>	<input type="checkbox"/>
c) Expose sensitive receptors to substantial pollutant concentrations?	<input type="checkbox"/>	<input type="checkbox"/>	<input checked="" type="checkbox"/>	<input type="checkbox"/>	<input type="checkbox"/>
d) Result in substantial emissions (such as those leading to odors) adversely affecting a substantial number of people?	<input type="checkbox"/>	<input type="checkbox"/>	<input checked="" type="checkbox"/>	<input type="checkbox"/>	<input type="checkbox"/>

Impact Discussion:

- a-d) The project site is located in the San Joaquin Valley Air Basin, which is regulated by the San Joaquin Valley Air Pollution Control District (SJVAPCD). SJVAPCD is the lead air quality regulatory agency for San Joaquin. This project was referred to the SJVAPCD for review on June 28, 2019. In a letter dated July 24, 2019, SJVAPCD responded that the project may exceed one or more of the District's significant thresholds of pollutant and required an Air Impact Assessment application demonstrating compliance with District Rule 9510 which is intended to mitigate a project's impact on air quality through project design elements or by payment of applicable off-site fees. In an Air Impact Assessment dated September 2019, performed by E-Tech Environmental, it has been concluded that the maximum air emissions of each criteria air pollutant generated by the proposed project are well below the regulatory significance thresholds. The applicant will be required to meet existing requirements for emissions and dust control as established by SJVAPCD. Therefore, any impacts to air quality will be reduced to less than significant.

IV. BIOLOGICAL RESOURCES.

Would the project:

	Potentially Significant Impact	Less Than Significant with Mitigation Incorporated	Less Than Significant Impact	No Impact	Analyzed In The Prior EIR
a) Have a substantial adverse effect, either directly or through habitat modifications, on any species identified as a candidate, sensitive, or special status species in local or regional plans, policies, or regulations, or by the California Department of Fish and Game or U.S. Fish and Wildlife Service?	<input type="checkbox"/>	<input checked="" type="checkbox"/>	<input type="checkbox"/>	<input type="checkbox"/>	<input type="checkbox"/>
b) Have a substantial adverse effect on any riparian habitat or other sensitive natural community identified in local or regional plans, policies, regulations or by the California Department of Fish and Game or US Fish and Wildlife Service?	<input type="checkbox"/>	<input type="checkbox"/>	<input type="checkbox"/>	<input checked="" type="checkbox"/>	<input type="checkbox"/>
c) Have a substantial adverse effect on state or federally protected wetlands (including, but not limited to, marsh, vernal pool, coastal, etc.) through direct removal, filling, hydrological interruption, or other means?	<input type="checkbox"/>	<input type="checkbox"/>	<input type="checkbox"/>	<input checked="" type="checkbox"/>	<input type="checkbox"/>
d) Interfere substantially with the movement of any native resident or migratory fish or wildlife species or with established native resident or migratory wildlife corridors, or impede the use of native wildlife nursery sites?	<input type="checkbox"/>	<input checked="" type="checkbox"/>	<input type="checkbox"/>	<input type="checkbox"/>	<input type="checkbox"/>
e) Conflict with any local policies or ordinances protecting biological resources, such as a tree preservation policy or ordinance?	<input type="checkbox"/>	<input type="checkbox"/>	<input checked="" type="checkbox"/>	<input type="checkbox"/>	<input type="checkbox"/>
f) Conflict with the provisions of an adopted Habitat Conservation Plan, Natural Community Conservation Plan, or other approved local, regional, or state habitat conservation plan?	<input type="checkbox"/>	<input checked="" type="checkbox"/>	<input type="checkbox"/>	<input type="checkbox"/>	<input type="checkbox"/>

Impact Discussion:

- a) The California Department of Fish and Wildlife Natural Diversity Database lists *Vulpes macrotis mutica* (San Joaquin Kit Fox), *Tropidocarpum capparideum* (caper-fruited tropidocarpum), *Blepharizonia plumose* (big tarplant), *Rana aurora draytonii* (California red-legged frog), *Agelaius tricolor* (tricolored black bird) and *Athene cunicularia* (burrowing owl) as rare, endangered, or threatened species or habitat located on or near the site for the proposed project. Referrals have been sent to the San Joaquin Council of Governments (SJCOG), the agency responsible for verifying the correct implementation of the *San Joaquin County Multi-Species Habitat Conservation and Open Space Plan* (SJMSCP), which provides compensation for the conversion of Open Space to non-Open Space uses which affect the plant, fish and wildlife species covered by the Plan. Pursuant to the Final EIR/EIS for SJMSCP, dated November 15, 2000, and certified by SJCOG on December 7, 2000, implementation of the SJMSCP is expected to reduce impacts to biological resources resulting from the proposed project to a level of less-than-significant.

SJCOG responded in a letter dated July 3, 2019, that the project site is subject to the SJMSCP. The applicant has confirmed that they will participate in SJMSCP. With the applicant's participation, the proposed project is consistent with the SJMSCP and any impacts to biological resources resulting from the proposed project will be reduced to a level of less-than-significant.

- b-c) The project site is not located in a riparian habitat as there is no river, stream or other waterway on the site, nor is it within an identified protected wetland, therefore the project will have no impact on riparian habitat or wetlands.
- d) The project's impact on resident or migratory wildlife corridors will be reduced to less than significant because the project applicant will participate in the San Joaquin Multi-Species Habitat Conservation and Open Space Plan (SJMSCP). Implementation of the SJMSCP is expected to reduce impacts to biological resources resulting from the proposed project to a level of less-than-significant.
- e) The projects impact on protected biological resources will be reduced to less than significant because the project applicant will participate in the San Joaquin Multi-Species Habitat Conservation and Open Space Plan (SJMSCP). Implementation of the SJMSCP is expected to reduce impacts to biological resources resulting from the proposed project to a level of less-than-significant.

The project site is not expected to interfere with local policies protecting biological resources because the applicant will be required to comply with the County's policy regarding Native Oak Trees, Heritage Oak Trees, or Historical Trees. If any such trees exist on the property, the project will be conditioned to protect and/or provide for replacement of the trees. In this way, any impact to protected biological resources will be reduced to less than significant.

- f) The project will not conflict with the provisions of an adopted Habitat Conservation Plan, natural Community Conservation Plan, or other approved local, regional, or state habitat conservation plan, because the project applicant will participate in the San Joaquin Multi-Species Habitat Conservation and Open Space Plan (SJMSCP). Implementation of the SJMSCP is expected to reduce impacts to biological resources resulting from the proposed project to a level of less-than-significant.

V. CULTURAL RESOURCES.

Would the project:

	Potentially Significant Impact	Less Than Significant with Mitigation Incorporated	Less Than Significant Impact	No Impact	Analyzed In The Prior EIR
a) Cause a substantial adverse change in the significance of a historical resource pursuant to § 15064.5?	<input type="checkbox"/>	<input type="checkbox"/>	<input type="checkbox"/>	<input checked="" type="checkbox"/>	<input type="checkbox"/>
b) Cause a substantial adverse change in the significance of an archaeological resource pursuant to § 15064.5?	<input type="checkbox"/>	<input type="checkbox"/>	<input type="checkbox"/>	<input checked="" type="checkbox"/>	<input type="checkbox"/>
c) Disturb any human remains, including those interred outside of dedicated cemeteries?	<input type="checkbox"/>	<input type="checkbox"/>	<input checked="" type="checkbox"/>	<input type="checkbox"/>	<input type="checkbox"/>

Impact Discussion:

- a-b) The proposed project will have no impact on Cultural Resources as there are no resources on the project site that are listed or are eligible for listing on a local register, the California Register of Historic Places, or National Register of Historic Places.
- c) In the event human remains are encountered during any portion of the project, California state law requires that there shall be no further excavation or disturbance of the site or any nearby area reasonably suspected to overlie adjacent remains until the coroner of the county has determined manner and cause of death, and the recommendations concerning the treatment and disposition of the human remains have been made to the person responsible for the excavation (California Health and Safety Code - Section 7050.5). In this way, any disturbance to human remains will be reduced to less than significant.

Potentially Significant Impact	Less Than Significant with Mitigation Incorporated	Less Than Significant Impact	No Impact	Analyzed In The Prior EIR
--------------------------------------	---	------------------------------------	--------------	---------------------------------

VI. ENERGY.

Would the project:

a) Result in a potentially significant environmental impact due to wasteful, inefficient, or unnecessary consumption of energy, or wasteful use of energy resources, during project construction or operation?

☐
☐
☒
☐
☐

b) Conflict with or obstruct a state or local plan for renewable energy or energy efficiency?

☐
☐
☒
☐
☐

Impact Discussion:

- a-b) The California Energy Code (also titled The Energy Efficiency Standards for Residential and Non-residential Buildings) was created by the California Building Standards Commission in response to a legislative mandate to reduce California's energy consumption. The code's purpose is to advance the state's energy policy, develop renewable energy sources and prepare for energy emergencies. These standards are updated periodically by the California Energy Commission. The code includes energy conservation standards applicable to most buildings throughout California. These requirements will be applicable to the proposed project ensuring that any impact to the environment due to wasteful, inefficient, or unnecessary consumption of energy will be less than significant and preventing any conflict with state or local plans for energy efficiency and renewable energy.

VII. GEOLOGY AND SOILS.

Would the project:

	Potentially Significant Impact	Less Than Significant with Mitigation Incorporated	Less Than Significant Impact	No Impact	Analyzed In The Prior EIR
a) Directly or indirectly cause potential substantial adverse effects, including the risk of loss, injury, or death involving:	<input type="checkbox"/>	<input type="checkbox"/>	<input checked="" type="checkbox"/>	<input type="checkbox"/>	<input type="checkbox"/>
i) Rupture of a known earthquake fault, as delineated on the most recent Alquist-Priolo Earthquake Fault Zoning Map issued by the State Geologist for the area or based on other substantial evidence of a known fault? Refer to Division of Mines and Geology Special Publication 42.	<input type="checkbox"/>	<input type="checkbox"/>	<input checked="" type="checkbox"/>	<input type="checkbox"/>	<input type="checkbox"/>
ii) Strong seismic ground shaking?	<input type="checkbox"/>	<input type="checkbox"/>	<input checked="" type="checkbox"/>	<input type="checkbox"/>	<input type="checkbox"/>
iii) Seismic-related ground failure, including liquefaction?	<input type="checkbox"/>	<input type="checkbox"/>	<input checked="" type="checkbox"/>	<input type="checkbox"/>	<input type="checkbox"/>
iv) Landslides?	<input type="checkbox"/>	<input type="checkbox"/>	<input checked="" type="checkbox"/>	<input type="checkbox"/>	<input type="checkbox"/>
b) Result in substantial soil erosion or the loss of topsoil?	<input type="checkbox"/>	<input type="checkbox"/>	<input checked="" type="checkbox"/>	<input type="checkbox"/>	<input type="checkbox"/>
c) Be located on a geologic unit or soil that is unstable, or that would become unstable as a result of the project, and potentially result in on- or off-site landslide, lateral spreading, subsidence, liquefaction or collapse?	<input type="checkbox"/>	<input type="checkbox"/>	<input checked="" type="checkbox"/>	<input type="checkbox"/>	<input type="checkbox"/>
d) Be located on expansive soil and create direct or indirect risks to life or property?	<input type="checkbox"/>	<input type="checkbox"/>	<input checked="" type="checkbox"/>	<input type="checkbox"/>	<input type="checkbox"/>
e) Have soils incapable of adequately supporting the use of septic tanks or alternative waste water disposal systems where sewers are not available for the disposal of waste water?	<input type="checkbox"/>	<input type="checkbox"/>	<input checked="" type="checkbox"/>	<input type="checkbox"/>	<input type="checkbox"/>
f) Directly or indirectly destroy a unique paleontological resource or site or unique geologic feature?	<input type="checkbox"/>	<input type="checkbox"/>	<input checked="" type="checkbox"/>	<input type="checkbox"/>	<input type="checkbox"/>

Impact Discussion:

- a) The geology of San Joaquin County is composed of high organic alluvium, which is susceptible to earthquake movement. The project will have to comply with the California Building Code (CBC) which includes provisions for soils reports for grading and foundations as well as design criteria for seismic loading and other geologic hazards based on fault and seismic hazard mapping. All recommendations from a soils report must be incorporated into the construction plans. Therefore, impacts to seismic-related (or other) landslide hazards will be less than significant.
- b) The project will not result in substantial soil erosion or the loss of topsoil because the project will require a grading permit as the site will be paved and landscape. Therefore, the grading will be done under permit and inspection by the San Joaquin County Community Development Department's Building Division. As a result, impacts to soil erosion or loss of topsoil will be less than significant.

- c-d) The project site is relatively flat terrain where landslides have not historically been an issue. A soils report will be required for grading and foundations and all recommendations from a soils report must be incorporated into the construction plans. Therefore, any risks resulting from being located on an unstable unit will be reduced to less than significant.
- e) The project will be served by an onsite septic tank or alternative waste water disposal system for the disposal of waste water. The Environmental Health Department is requiring a soil suitability/nitrate loading study to determine the appropriate system and design prior to issuance of building permit(s). The sewage disposal system shall comply with the onsite wastewater treatment systems standards of San Joaquin County prior to approval. A percolation test that meets absorption rates of the manual of septic tank practice or E.P.A. Design Manual for onsite wastewater treatment and disposal system is required for each parcel. With these standards in place, only soils capable of adequately supporting the use of septic tanks will be approved for the septic system.

Potentially Significant Impact	Less Than Significant with Mitigation Incorporated	Less Than Significant Impact	No Impact	Analyzed In The Prior EIR
--------------------------------------	---	------------------------------------	--------------	---------------------------------

VIII. GREENHOUSE GAS EMISSIONS.

Would the project:

a) Generate greenhouse gas emissions, either directly or indirectly, that may have a significant impact on the environment?

☐
☐
☒
☐
☐

b) Conflict with an applicable plan, policy or regulation adopted for the purpose of reducing the emissions of greenhouse gases?

☐
☐
☒
☐
☐

Impact Discussion:

a-b) "Though there is no Greenhouse gas (GHG) significance thresholds established by SJVUAPCD, however, even when compared to the industrial threshold established by other regions within California, the emissions of GHG (CO2e) are well below the significance thresholds." (E-Tech Environmental, 2019, p.7)

References

E-Tech Environmental. (2019). *Air Quality Assessment*. Air Emissions Analysis Construction and Operational, Diamond Bar.

	Potentially Significant Impact	Less Than Significant with Mitigation Incorporated	Less Than Significant Impact	No Impact	Analyzed In The Prior EIR
<u>IX. HAZARDS AND HAZARDOUS MATERIALS.</u>					
Would the project:					
a) Create a significant hazard to the public or the environment through the routine transport, use, or disposal of hazardous materials?	<input type="checkbox"/>	<input type="checkbox"/>	<input checked="" type="checkbox"/>	<input type="checkbox"/>	<input type="checkbox"/>
b) Create a significant hazard to the public or the environment through reasonably foreseeable upset and accident conditions involving the release of hazardous materials into the environment?	<input type="checkbox"/>	<input type="checkbox"/>	<input checked="" type="checkbox"/>	<input type="checkbox"/>	<input type="checkbox"/>
c) Emit hazardous emissions or handle hazardous or acutely hazardous materials, substances, or waste within one-quarter mile of an existing or proposed school?	<input type="checkbox"/>	<input type="checkbox"/>	<input checked="" type="checkbox"/>	<input type="checkbox"/>	<input type="checkbox"/>
d) Be located on a site which is included on a list of hazardous materials sites compiled pursuant to Government Code Section 65962.5 and, as a result, would it create a significant hazard to the public or the environment?	<input type="checkbox"/>	<input type="checkbox"/>	<input checked="" type="checkbox"/>	<input type="checkbox"/>	<input type="checkbox"/>
e) For a project located within an airport land use plan or, where such a plan has not been adopted, within two miles of a public airport or public use airport, would the project result in a safety hazard or excessive noise for people residing or working in the project area?	<input type="checkbox"/>	<input type="checkbox"/>	<input checked="" type="checkbox"/>	<input type="checkbox"/>	<input type="checkbox"/>
f) Impair implementation of or physically interfere with an adopted emergency response plan or emergency evacuation plan?	<input type="checkbox"/>	<input type="checkbox"/>	<input checked="" type="checkbox"/>	<input type="checkbox"/>	<input type="checkbox"/>
g) Expose people or structures, either directly or indirectly, to a significant risk of loss, injury or death involving wildland fires, including where wildlands are adjacent to urbanized areas or where residences are intermixed with wildlands?	<input type="checkbox"/>	<input type="checkbox"/>	<input checked="" type="checkbox"/>	<input type="checkbox"/>	<input type="checkbox"/>

Impact Discussion:

- a-g) The proposed application would not result in, create or induce hazards and associated risks to the public. Construction activities for the project typically involve the use of toxic or hazardous materials such as paint, fuels, and solvents. Construction activities would be subject to federal, state, and local laws and requirements designed to minimize and avoid potential health and safety risks associated with hazardous materials. No significant impacts are anticipated related to the transport, use, or storage of hazardous materials during construction activities are anticipated.

The project site does not fall within the Airport Influence Area the comprehensive Airport Land Use Plan boundaries for the Tracy Municipal Airport. The project site is located approximately 2.9 miles northwest of the nearest runway. As a result, there will be no impact to airport flight paths.

X. HYDROLOGY AND WATER QUALITY.

Would the project:

	Potentially Significant Impact	Less Than Significant with Mitigation Incorporated	Less Than Significant Impact	No Impact	Analyzed In The Prior EIR
a) Violate any water quality standards or waste discharge requirements or otherwise substantially degrade surface or ground water quality?	<input type="checkbox"/>	<input type="checkbox"/>	<input type="checkbox"/>	<input checked="" type="checkbox"/>	<input type="checkbox"/>
b) Substantially decrease groundwater supplies or interfere substantially with groundwater recharge such that the project may impede sustainable groundwater management of the basin?	<input type="checkbox"/>	<input type="checkbox"/>	<input type="checkbox"/>	<input checked="" type="checkbox"/>	<input type="checkbox"/>
c) Substantially alter the existing drainage pattern of the site or area, including through the alteration of the course of a stream or river or through the addition of impervious surfaces, in a manner which would:	<input type="checkbox"/>	<input type="checkbox"/>	<input type="checkbox"/>	<input checked="" type="checkbox"/>	<input type="checkbox"/>
i) result in substantial erosion or siltation on- or off-site;	<input type="checkbox"/>	<input type="checkbox"/>	<input type="checkbox"/>	<input checked="" type="checkbox"/>	<input type="checkbox"/>
ii) substantially increase the rate or amount of surface runoff in a manner which would result in flooding on- or off-site;	<input type="checkbox"/>	<input type="checkbox"/>	<input type="checkbox"/>	<input checked="" type="checkbox"/>	<input type="checkbox"/>
iii) create or contribute runoff water which would exceed the capacity of existing or planned stormwater drainage systems or provide substantial additional sources of polluted runoff; or	<input type="checkbox"/>	<input type="checkbox"/>	<input type="checkbox"/>	<input checked="" type="checkbox"/>	<input type="checkbox"/>
iv) impede or redirect flood flows?	<input type="checkbox"/>	<input type="checkbox"/>	<input type="checkbox"/>	<input checked="" type="checkbox"/>	<input type="checkbox"/>
d) In flood hazard, tsunami, or seiche zones, risk release of pollutants due to project inundation?	<input type="checkbox"/>	<input type="checkbox"/>	<input checked="" type="checkbox"/>	<input type="checkbox"/>	<input type="checkbox"/>
e) Conflict with or obstruct implementation of a water quality control plan or sustainable groundwater management plan?	<input type="checkbox"/>	<input type="checkbox"/>	<input checked="" type="checkbox"/>	<input type="checkbox"/>	<input type="checkbox"/>

Impact Discussion:

- d) The project site is located in the Flood Zone X, 0.2 percent annual chance of flood designations. A referral has been sent to the Department of Public Works, Flood Control Division for comments. If approved, any new developments will have to comply with Development Title Section 9-1605 regarding flood hazards.

The project site is located approximately 202 feet south of the California Aqueduct. Uses to the north, south, east, and west are industrial. The proposed unmanned trailer parking and storage facility is an infill project in an urban area. A referral was sent to the Central Valley Regional Water Quality Control Board for review. As a Condition of Approval, the project will be subject to the Water Board's rules and regulations. As a result, the effects the project will have on waterways in the vicinity are expected to be less than significant.

Potentially Significant Impact	Less Than Significant with Mitigation Incorporated	Less Than Significant Impact	No Impact	Analyzed In The Prior EIR
--------------------------------------	---	------------------------------------	--------------	---------------------------------

XI. LAND USE AND PLANNING.

Would the project:

- | | | | | | |
|--|--------------------------|--------------------------|-------------------------------------|-------------------------------------|--------------------------|
| a) Physically divide an established community? | <input type="checkbox"/> | <input type="checkbox"/> | <input type="checkbox"/> | <input checked="" type="checkbox"/> | <input type="checkbox"/> |
| b) Cause a significant environmental impact due to a conflict with any land use plan, policy, or regulation adopted for the purpose of avoiding or mitigating an environmental effect? | <input type="checkbox"/> | <input type="checkbox"/> | <input checked="" type="checkbox"/> | <input type="checkbox"/> | <input type="checkbox"/> |

Impact Discussion:

- a) The construction and operation of the proposed project will not physically divide an established community. The project is an orderly extension of the industrial development that is established within the industrial corridor in the urban community of Tracy and the project is an industrial use adjacent to properties zoned for industrial use. Therefore, the project's impact on an established community would be less than significant.
- b) The project is for an unmanned trailer parking and storage facility to include the construction of an 80-square-foot restroom building. The Truck Sales & Services - Parking use type may be conditionally permitted in the I-G (General Industrial) zone with an approved Site Approval application in compliance with the S-8 Conditional Zoning:

1) Prior to the approval of any industrial use of the property applicants shall agree to meet the requirements of the State and Federal Endangered Species Acts with respect to the San Joaquin Kit Fox.

- The applicant can choose to participate in the San Joaquin County Multi-Species Habitat Conservation and Open Space Plan (SJMSCP). Compliance with the SJMSCP will satisfy the requirements of State and Federal Endangered Species Acts with respect to the San Joaquin Kit Fox. If the applicant chooses not to participate in the SJMSCP, an alternative mitigation plan will need to be approved by the Department of Fish and Wildlife prior to approval of a land use permit. The applicant will be required to confirm if they are participating in the SJMSCP, prior to the completion of the environmental review.

2) All individual industrial uses must meet the County Water Policy (Resolution R-91-973).

- The Department of Public Works has indicated that this site has met the County Water Policy by virtue of the approved General Plan Amendment to General Industrial. In addition, the policy does not apply to parcels under 20 acres and the project parcel is 15.38 acres in size.

3) Any industrial development of the parcels shall be served by public water, wastewater treatment, and drainage systems when such systems become available. Interim use of the existing private wells and septic systems shall be limited to domestic type waste generation until there is a connection to public services.

- This project meets this requirement because it will use an existing well and replace the septic system. Public services are not available at this time and the project would be conditioned to be limited to domestic type waste.

4) Any industrial development of the parcels will require improvement of Hansen Road across the frontage of the project site, to San Joaquin County standards for a 60 foot wide right of way Local Industrial Road.

- The Department of Public Works has reviewed the requirements and has determined the owner shall

execute an Irrevocable Offer to Dedicate Road to result in a twenty-five (25) foot wide right-of-way from the centerline of Hansen Road to the property line across the parcel's frontage.

5) Prior to the approval of any industrial development, a traffic study will be required to determine if traffic signals are warranted at the intersection of Hansen Road and Schulte Road.

- The Department of Public Works has confirmed that traffic signals have been installed at the intersection of Hansen Road and Schulte Road, and has determined a traffic study is not required.

The project is not a growth-inducing action nor is it in conflict with any existing or planned uses. The project will not set a significant land use precedent in the area. There are no applicable Master Plans, Special Purpose Plans, or Specific Plans in the vicinity.

Potentially Significant Impact	Less Than Significant with Mitigation Incorporated	Less Than Significant Impact	No Impact	Analyzed In The Prior EIR
--------------------------------------	---	------------------------------------	--------------	---------------------------------

XII. MINERAL RESOURCES.

Would the project:

- | | | | | | |
|--|--------------------------|--------------------------|--------------------------|-------------------------------------|--------------------------|
| a) Result in the loss of availability of a known mineral resource that would be of value to the region and the residents of the state? | <input type="checkbox"/> | <input type="checkbox"/> | <input type="checkbox"/> | <input checked="" type="checkbox"/> | <input type="checkbox"/> |
| b) Result in the loss of availability of a locally- important mineral resource recovery site delineated on a local general plan, specific plan or other land use plan? | <input type="checkbox"/> | <input type="checkbox"/> | <input type="checkbox"/> | <input checked="" type="checkbox"/> | <input type="checkbox"/> |

Impact Discussion:

- a, b) The proposed project will not result in the loss of availability of a known mineral resource of a resource recovery site because the site does not contain minerals of significance or known mineral resources. San Joaquin County applies a mineral resource zone (MRZ) designation to land that meets the significant mineral deposits definition by the State Division of Mines and Geology. The proposed project is not in a designated MRZ zone. Therefore, the proposed project applications will not have an impact on the availability of mineral resources or mineral resource recovery sites within San Joaquin County.

Potentially Significant Impact	Less Than Significant with Mitigation Incorporated	Less Than Significant Impact	No Impact	Analyzed In The Prior EIR
--------------------------------------	---	------------------------------------	--------------	---------------------------------

XIII. NOISE.

Would the project result in:

- a) Generation of a substantial temporary or permanent increase in ambient noise levels in the vicinity of the project in excess of standards established in the local general plan or noise ordinance, or applicable standards of other agencies?
- b) Generation of excessive groundborne vibration or groundborne noise levels?
- c) For a project within the vicinity of a private airstrip or an airport land use plan, or where such a plan has not been adopted, within two miles of a public airport or public use airport, would the project expose people residing or working in the project area to excessive noise levels?

<input type="checkbox"/>	<input type="checkbox"/>	<input checked="" type="checkbox"/>	<input type="checkbox"/>	<input type="checkbox"/>
<input type="checkbox"/>	<input type="checkbox"/>	<input checked="" type="checkbox"/>	<input type="checkbox"/>	<input type="checkbox"/>
<input type="checkbox"/>	<input type="checkbox"/>	<input checked="" type="checkbox"/>	<input type="checkbox"/>	<input type="checkbox"/>

Impact Discussion:

- c. The nearest conforming single family residence is located approximately 892 feet east of the project site, on the east side of South Hansen Road. Development Title Section 9-1025.9 lists the Residential use type as a noise sensitive land use. Development Title Section Table 9-1025.9 Part I states that the maximum sound level for transportation noise is 65dB. This applies to outdoor activity areas of the receiving use, or applies at the lot line if no activity area is known. The proposed project would be subject to these Development Title standards. The primary noise source would be transportation noise from an unmanned truck parking facility with surrounding Industrial uses. All truck traffic will go north on Hansen Road, and will not directly impact the residence. Therefore, noise impacts from the proposed project are expected to be less than significant.

Potentially Significant Impact	Less Than Significant with Mitigation Incorporated	Less Than Significant Impact	No Impact	Analyzed In The Prior EIR
--------------------------------------	---	------------------------------------	--------------	---------------------------------

XIV. POPULATION AND HOUSING.

Would the project:

- | | | | | | |
|---|--------------------------|--------------------------|--------------------------|-------------------------------------|--------------------------|
| a) Induce substantial unplanned population growth in an area, either directly (for example, by proposing new homes and businesses) or indirectly (for example, through extension of roads or other infrastructure)? | <input type="checkbox"/> | <input type="checkbox"/> | <input type="checkbox"/> | <input checked="" type="checkbox"/> | <input type="checkbox"/> |
| b) Displace substantial numbers of existing people or housing, necessitating the construction of replacement housing elsewhere? | <input type="checkbox"/> | <input type="checkbox"/> | <input type="checkbox"/> | <input checked="" type="checkbox"/> | <input type="checkbox"/> |

Impact Discussion:

- a-c) The proposed project will not induce substantial population growth in the area either directly or indirectly because the project site is in an industrial zone and surrounding properties are zoned commercial and industrial. The proposed project would not displace substantial numbers of people or existing housing, necessitating the construction of replacement housing elsewhere. Therefore, the project will have no impact on population and housing.

Potentially Significant Impact	Less Than Significant with Mitigation Incorporated	Less Than Significant Impact	No Impact	Analyzed In The Prior EIR
--------------------------------------	---	------------------------------------	--------------	---------------------------------

XV. PUBLIC SERVICES.

a) Would the project result in substantial adverse physical impacts associated with the provision of new or physically altered governmental facilities, need for new or physically altered governmental facilities, the construction of which could cause significant environmental impacts, in order to maintain acceptable service ratios, response times or other performance objectives for any of the public services:

Fire protection?	<input type="checkbox"/>	<input type="checkbox"/>	<input type="checkbox"/>	<input checked="" type="checkbox"/>	<input type="checkbox"/>
Police protection?	<input type="checkbox"/>	<input type="checkbox"/>	<input type="checkbox"/>	<input checked="" type="checkbox"/>	<input type="checkbox"/>
Schools?	<input type="checkbox"/>	<input type="checkbox"/>	<input type="checkbox"/>	<input checked="" type="checkbox"/>	<input type="checkbox"/>
Parks?	<input type="checkbox"/>	<input type="checkbox"/>	<input type="checkbox"/>	<input checked="" type="checkbox"/>	<input type="checkbox"/>
Other public facilities?	<input type="checkbox"/>	<input type="checkbox"/>	<input type="checkbox"/>	<input checked="" type="checkbox"/>	<input type="checkbox"/>

Impact Discussion:

a) The proposed project is a truck parking facility to include the construction of an 80-square-foot restroom building and spaces for parking two hundred trucks. The project site is located in the Tracy Rural Fire District and the Lammersville Unified School District. Both agencies were provided with the project proposal and invited to respond with any concerns or conditions. A response was not received from either agency. The project site is served by the San Joaquin County Sheriff's Office. The office was provided with the project proposal and invited to respond with any concerns or conditions. A response was not received from that office. As proposed, the project is not anticipated to result in a need for a substantial change to public services.

	Potentially Significant Impact	Less Than Significant with Mitigation Incorporated	Less Than Significant Impact	No Impact	Analyzed In The Prior EIR
<u>XVI. RECREATION.</u>					
a) Would the project increase the use of existing neighborhood and regional parks or other recreational facilities such that substantial physical deterioration of the facility would occur or be accelerated?	<input type="checkbox"/>	<input type="checkbox"/>	<input type="checkbox"/>	<input checked="" type="checkbox"/>	<input type="checkbox"/>
b) Does the project include recreational facilities or require the construction or expansion of recreational facilities which might have an adverse physical effect on the environment?	<input type="checkbox"/>	<input type="checkbox"/>	<input type="checkbox"/>	<input checked="" type="checkbox"/>	<input type="checkbox"/>

Impact Discussion:

- a-b) This project will not increase the use of existing neighborhood and regional parks or other recreational facilities such that substantial physical deterioration of the facility would occur or be accelerated, because the project will not generate any new residential units and the impacts to parks generated by the employees of this project will be minimal. This project does not include recreational facilities or require the construction or expansion of recreational facilities, which might have an adverse physical effect on the environment, because the type of project proposed, a retail store, will not result in an increased demand for recreational facilities. Therefore, the project will have no impact on recreation facilities.

Potentially Significant Impact	Less Than Significant with Mitigation Incorporated	Less Than Significant Impact	No Impact	Analyzed In The Prior EIR
--------------------------------------	---	------------------------------------	--------------	---------------------------------

XVII. TRANSPORTATION.

Would the project:

a) Conflict with a program plan, ordinance, or policy addressing the circulation system, including transit, roadways, bicycle, and pedestrian facilities?	<input type="checkbox"/>	<input type="checkbox"/>	<input checked="" type="checkbox"/>	<input type="checkbox"/>	<input type="checkbox"/>
b) Would the project conflict or be inconsistent with CEQA Guidelines section 15064.3, subdivision (b)?	<input type="checkbox"/>	<input type="checkbox"/>	<input type="checkbox"/>	<input checked="" type="checkbox"/>	<input type="checkbox"/>
c) Substantially increase hazards due to a geometric design feature (e.g., sharp curves or dangerous intersections) or incompatible uses (e.g., farm equipment)?	<input type="checkbox"/>	<input type="checkbox"/>	<input checked="" type="checkbox"/>	<input type="checkbox"/>	<input type="checkbox"/>
d) Result in inadequate emergency access?	<input type="checkbox"/>	<input type="checkbox"/>	<input checked="" type="checkbox"/>	<input type="checkbox"/>	<input type="checkbox"/>

Impact Discussion:

- a) The proposed project will not conflict with a program plan, ordinance, or policy addressing the circulation system, including transit, roadways, etc., because the conditions of approval include conditions to mitigate any conflict. The proposed truck parking facility is located on the west side of South Hansen Road, and will be accessible twenty-four (24) hours per day, seven (7) days a week, with no employees. A referral was sent to the San Joaquin County Department of Public Works on June 28, 2018. The Department responded in a letter dated August 20, 2019 that the potential traffic impacts are less than significant.
- b) N/A
- c) The Department of Public Works includes in its conditions, the requirement that the South Hansen Road driveway design shall be improved in accordance with the requirements of San Joaquin County Improvements Standards Drawing No. 16 [return raddi for truck-trailer egress shall be designed to prevent encroachment onto opposing lanes of traffic] (Development Title Section 9-1145.5). With these conditions from the Department of Public Works, any hazards from curves or intersections will be reduced to less than significant.
- d) The proposed project has adequate access from South Hansen Road that provides for adequate access for emergency equipment. The Department of Public Works, in its conditions, requires that the driveway approach be improved in accordance with the requirements of San Joaquin County Improvement Standards Drawing No. 13 [including return radii to accommodate truck-trailer movements for trucks exiting the site so as not to encroach on opposing lanes of traffic]. Pursuant to Development Title Section 9-1015.5(h)(1), access driveways shall have a width of no less than twenty-five (25) feet for two-way aisles and sixteen (16) feet for one-way aisles, except that in no case shall driveways designated as fire department access be less than twenty (20) feet wide. With these required improvements, the project's impact on emergency access is expected to be less than significant.

Potentially Significant Impact	Less Than Significant with Mitigation Incorporated	Less Than Significant Impact	No Impact	Analyzed In The Prior EIR
--------------------------------------	---	------------------------------------	--------------	---------------------------------

XVIII. TRIBAL CULTURAL RESOURCES.

a) Would the project cause a substantial adverse change in the significance of a tribal cultural resource, defined in Public Resources Code section 21074 as either a site, feature, place, cultural landscape that is geographically defined in terms of the size and scope of the landscape, sacred place, or object with cultural value to a California Native American tribe, and that is:

i) Listed or eligible for listing in the California Register of Historical Resources, or in a local register of historical resources as defined in Public Resources Code section 5020.1(k), or

☐
☐
☐
☒
☐

ii) A resource determined by the lead agency, in its discretion and supported by substantial evidence, to be significant pursuant to criteria set forth in subdivision (c) of Public Resources Code Section 5024.1. In applying the criteria set forth in subdivision (c) of Public Resource Code Section 5024.1, the lead agency shall consider the significance of the resource to a California Native American tribe.

☐
☐
☐
☒
☐

Impact Discussion:

a) This project is located in the Urban community of Tracy, 0.86 miles south of West Schulte Road, between the California Aqueduct to the north and I-580 to the south.

The project must comply with state and federal laws regarding any resources or remains found during construction. If, in the course of development, concentrations of prehistoric or historic-period materials are encountered, all work in the vicinity of the find must be halted until an archaeologist can evaluate the materials and make recommendations for further action. If human remains are encountered, all work must halt in the vicinity and the County Coroner shall be notified immediately. At the same time, a qualified archaeologist shall be contacted to evaluate the finds. If Human burials are found to be of Native American origin, steps shall be taken pursuant to Section 15064.5(e) of Guidelines for California Environmental Quality Act. The California Valley Miwok Tribe was sent a referral for the project on October 8, 2018 and a response was not received.

	Potentially Significant Impact	Less Than Significant with Mitigation Incorporated	Less Than Significant Impact	No Impact	Analyzed In The Prior EIR
--	--------------------------------------	---	------------------------------------	--------------	---------------------------------

XIX. UTILITIES AND SERVICE SYSTEMS.

Would the project:

- | | | | | | |
|---|--------------------------|--------------------------|-------------------------------------|--------------------------|--------------------------|
| a) Require or result in the relocation or construction of new or expanded water, wastewater treatment, or storm water drainage, electric power, natural gas, or telecommunications facilities, the construction or relocation of which could cause significant environmental effects? | <input type="checkbox"/> | <input type="checkbox"/> | <input checked="" type="checkbox"/> | <input type="checkbox"/> | <input type="checkbox"/> |
| b) Have sufficient water supplies available to serve the project and reasonably foreseeable future development during normal, dry and multiple dry years? | <input type="checkbox"/> | <input type="checkbox"/> | <input checked="" type="checkbox"/> | <input type="checkbox"/> | <input type="checkbox"/> |
| c) Result in a determination by the wastewater treatment provider which serves or may serve the project that it has adequate capacity to serve the project's projected demand in addition to the provider's existing commitments? | <input type="checkbox"/> | <input type="checkbox"/> | <input checked="" type="checkbox"/> | <input type="checkbox"/> | <input type="checkbox"/> |
| d) Generate solid waste in excess of State or local standards, or in excess of the capacity of local infrastructure, or otherwise impair the attainment of solid waste reduction goals? | <input type="checkbox"/> | <input type="checkbox"/> | <input checked="" type="checkbox"/> | <input type="checkbox"/> | <input type="checkbox"/> |
| e) Comply with federal, state, and local management and reduction statutes and regulations related to solid waste? | <input type="checkbox"/> | <input type="checkbox"/> | <input checked="" type="checkbox"/> | <input type="checkbox"/> | <input type="checkbox"/> |

Impact Discussion:

- a) The project will utilize an onsite well and a private septic system as well as a retention pond for storm water. Therefore the project will not require new public facilities. A replacement septic system will be installed under permit and inspection by the Environmental Health Department. The well and septic system will be maintained privately.
- b) The project will utilize an existing individual domestic water well.
- c) The project will utilize an onsite sewage disposal system constructed under permit from the Environmental Health Department and subject to the onsite wastewater treatment system regulations that will comply with the standards of San Joaquin County.
- d-e) The project is a Site Approval application to establish an unmanned trailer parking and storage facility for 200 trailers, to include the construction of an eighty (80) square foot restroom building. As proposed, the project is not anticipated to generate solid waste in excess of State and local standards.

	Potentially Significant Impact	Less Than Significant with Mitigation Incorporated	Less Than Significant Impact	No Impact	Analyzed In The Prior EIR
<u>XX. WILDFIRE.</u>					
If located in or near state responsibility areas or lands classified as very high fire hazard severity zones, would the project:					
a) Substantially impair an adopted emergency response plan or emergency evacuation plan?	<input type="checkbox"/>	<input type="checkbox"/>	<input checked="" type="checkbox"/>	<input type="checkbox"/>	<input type="checkbox"/>
b) Due to slope, prevailing winds, and other factors, exacerbate wildfire risks, and thereby expose project occupants to pollutant concentrations from a wildfire or the uncontrolled spread of a wildfire?	<input type="checkbox"/>	<input type="checkbox"/>	<input checked="" type="checkbox"/>	<input type="checkbox"/>	<input type="checkbox"/>
c) Require the installation or maintenance of associated infrastructure (such as roads, fuel breaks, emergency water sources, power lines or other utilities) that may exacerbate fire risk or that may result in temporary or ongoing impacts to the environment?	<input type="checkbox"/>	<input type="checkbox"/>	<input checked="" type="checkbox"/>	<input type="checkbox"/>	<input type="checkbox"/>
d) Expose people or structures to significant risks, including downslope or downstream flooding or landslides, as a result of runoff, post-fire slope instability, or drainage changes?	<input type="checkbox"/>	<input type="checkbox"/>	<input checked="" type="checkbox"/>	<input type="checkbox"/>	<input type="checkbox"/>

Impact Discussion:

- a-d) The project location is in the urban community of Tracy, CA, and the project parcel is identified as a Community at Risk from Wildfire by Cal Fire's "Fire Risk Assessment Program". Communities at Risk from Wildfire are those places within 1.5 miles of areas of High or Very High wildfire threat as determined from CDF-FRAP fuels and hazard data. The project is located in a Moderate Fire Risk zone. South San Joaquin County Fire Authority has required an on-site fire suppression water supply for this project. Therefore, the impact of wildfires on the project are expected to be less than significant.

Potentially Significant Impact	Less Than Significant with Mitigation Incorporated	Less Than Significant Impact	No Impact	Analyzed In The Prior EIR
--------------------------------------	---	------------------------------------	--------------	---------------------------------

XXI. MANDATORY FINDINGS OF SIGNIFICANCE.

a) Does the project have the potential to substantially degrade the quality of the environment, substantially reduce the habitat of a fish or wildlife species, cause a fish or wildlife population to drop below self-sustaining levels, threaten to eliminate a plant or animal community, substantially reduce the number or restrict the range of a rare or endangered plant or animal or eliminate important examples of the major periods of California history or prehistory?

☐
☒
☐
☐
☐

b) Does the project have impacts that are individually limited, but cumulatively considerable? ("Cumulatively considerable" means that the incremental effects of a project are considerable when viewed in connection with the effects of past projects, the effects of other current projects, and the effects of probable future projects)?

☐
☐
☒
☐
☐

c) Does the project have environmental effects which will cause substantial adverse effects on human beings, either directly or indirectly?

☐
☐
☒
☐
☐

Impact Discussion:

a) The proposed project does not appear to have the potential to significantly degrade the overall quality of the region's environment, or substantially reduce the habitat of a fish or wildlife species, cause a fish or wildlife population to drop below self-sustaining levels, threaten to eliminate a plant or animal community, reduce the number or restrict the range of a rare or endangered plant or animal or eliminate important examples of the major periods of California history or prehistory. There are no identified historic or prehistoric resources identified on this site. No archaeological or paleontological resources have been identified in the project area.

The applicant has confirmed that he will participate in the *San Joaquin County Multi-Species Habitat Conservation and Open Space Plan* (SJMSCP), which provides compensation for the conversion of Open Space to non-Open Space uses which affect the plant, fish and wildlife species covered by the Plan. With the applicant's participation, the proposed project is consistent with the SJMSCP and any impacts to biological resources resulting from the proposed project will be reduced to a level of less-than-significant

b) The project is not expected to have cumulatively considerable impacts. Less than significant impacts to air quality, biological resources, traffic, and hydrology have been identified. Any potential impacts will be adequately addressed through conditions of approval and compliance with existing laws and regulations.

c) The project does not have environmental effects which will cause substantial adverse effects on human beings.

Note: Authority cited: Sections 21083, 21083.05, Public Resources Code. Reference: Section 65088.4, Gov. Code; Sections 21080, 21083.05, 21095, Pub. Resources Code; Eureka Citizens for Responsible Govt. v. City of Eureka (2007) 147 Cal.App.4th 357; Protect the Historic Amador Waterways v. Amador Water Agency (2004) 116 Cal.App.4th at 1109; San Franciscans Upholding the Downtown Plan v. City and County of San Francisco (2002) 102 Cal.App.4th 656.

SITE PLAN

Application #

PA1900143

Received By

SS

On 9/17/19

Project Data

Client: Costco Wholesale
599 Lake Drive
Issaquah, WA 98027

Project Address: 26901 Hansen Road
Tracy, CA 95377-8847

Site Data

Jurisdiction: San Joaquin County
Current Zoning: Industrial (I3)
Proposed Zoning: Industrial (IG)

APN: 290-110-100-000

Site Area: 15.53 AC

Boundary Information: This plan has been prepared using the Topographic Survey dated 05/09/19 prepared by Kier & Wright and is for preliminary use only.

Proposed Parking Data

New Truck/Trailer
Parking Stalls 10'x55': 200 Stalls

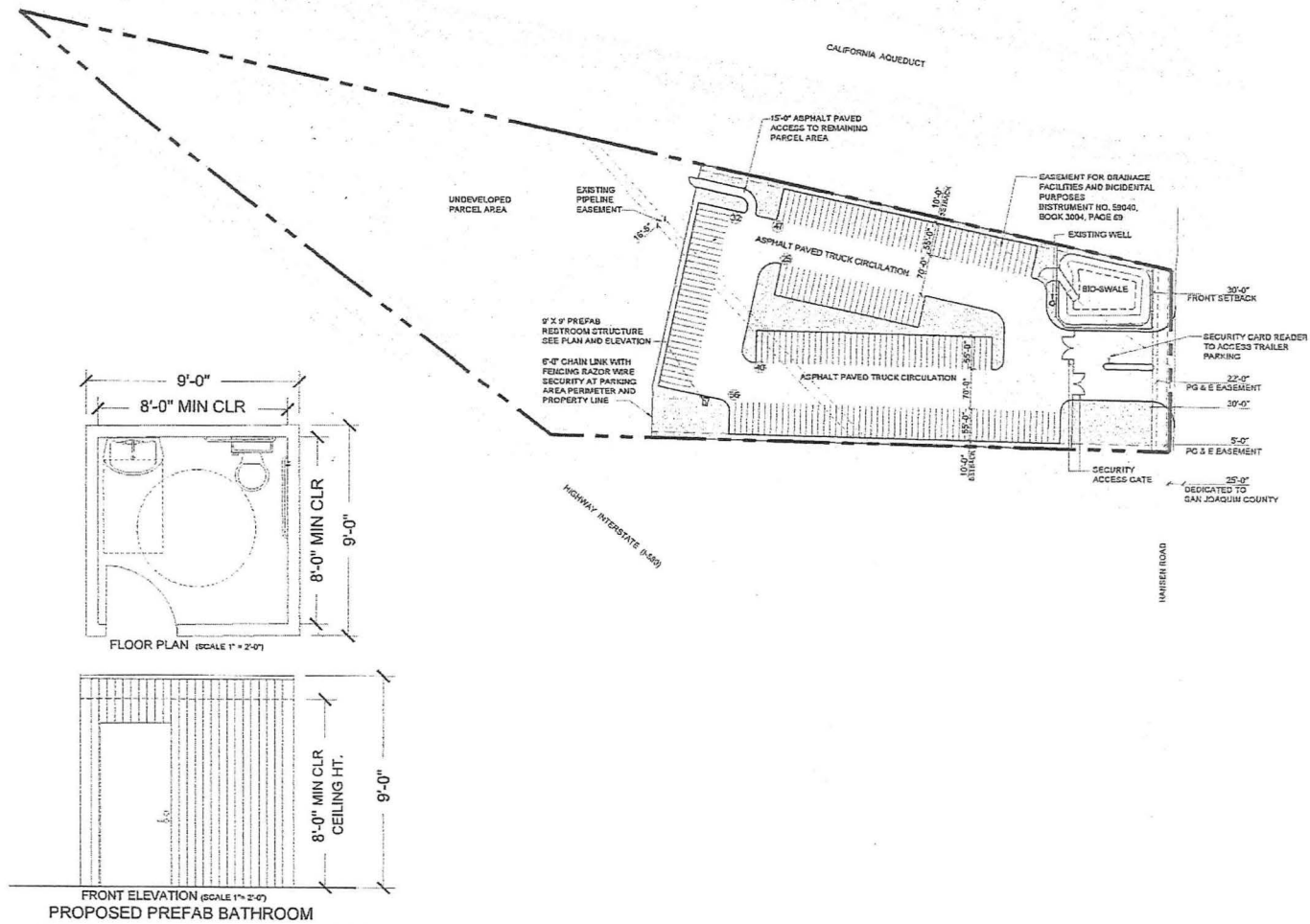

TRACY DEPOT TRAILER STORAGE FACILITY

CONCEPT SITE PLAN

1" = 20' 40' 80' 160'

SCALE 1" = 80'

SEPTEMBER 13, 2019



DBA # P.299

DB+A

ON-SITE PHOTOGRAPHY • PHOTOGRAPHY
ON-SITE PHOTOGRAPHY • PHOTOGRAPHY
ON-SITE PHOTOGRAPHY • PHOTOGRAPHY
ON-SITE PHOTOGRAPHY • PHOTOGRAPHY

SHEET
4
of 12