

LEGEND

- [E] EXISTING TO REMAIN
- [R3] REMOVE AND SALVAGE SIGN AND POST (IF APPLICABLE) AS NOTED
- [IS] FURNISH AND INSTALL SIGN AND POST (IF APPLICABLE)
- [RL] RELOCATE EXISTING SIGN TO NEW POST (IF APPLICABLE) AS NOTED
- [RP] REMOVE ALL EXISTING CONFLICTING TRAFFIC STRIPING, MARKINGS OR ARROWS AS NOTED, INCLUDING RAISED PAVEMENT MARKERS (EXCEPT WHERE INDICATED). GROUND OUT AREAS TO BE SLURRY SEALED.
- [#] INSTALL THERMOPLASTIC CALTRANS STRIPING DETAIL PER NUMBER NOTED. INCLUDING INSTALLATION OF RAISED PAVEMENT MARKERS.
- [PM] INSTALL THERMOPLASTIC PAVEMENT MARKERS OR ARROW AS NOTED. LEGENDS SHALL HAVE 50' SPACE TO NEXT LEGEND UNLESS NOTED OTHERWISE.
- [TS] SIGNALIZED INTERSECTION
- [P] PROPOSED SIGN
- [E] EXISTING SIGN
- [R] REMOVE SIGN

GENERAL NOTES:

- A. SIGNING AND STRIPING SHALL CONFORM TO THE CALTRANS STANDARD PLANS AND SPECIFICATIONS DATED 2015 AND 2014 CALIFORNIA MANUAL ON UNIFORM TRAFFIC CONTROL DEVICES (CAMUTCD), RIVERSIDE COUNTY STANDARD PLANS AND REQUIREMENTS, THESE PLANS AND THE SPECIAL PROVISIONS. SEE CALTRANS STANDARD PLANS A20 (A-D) & A-24 (A-E) FOR SIGNING AND STRIPING DETAILS, INCLUDING INSTALLATION OR REMOVAL OF RAISED PAVEMENT MARKERS (SEE SPECIAL PROVISIONS).
- B. SIGN POST SHALL BE INSTALLED PER RIVERSIDE COUNTY STANDARD PLANS.
- C. ALL SIGNS AND STRIPING SHALL BE REFLECTIVE PER CALTRANS SPECIFICATIONS AND AS DIRECTED BY ENGINEER.
- D. SIGNS SHALL BE INSTALLED ON STREET LIGHT POLES WHERE APPLICABLE AS DIRECTED BY THE ENGINEER.
- E. 125 MIL THICK ALKYD THERMOPLASTIC SHALL BE USED FOR ALL PERMANENT STRIPING AND PERMANENT MARKINGS THAT INCLUDE BUT NOT LIMITED TO LIMIT LINES, ARROWS, CROSSWALK LINES, PAVEMENT LETTERING AND ARTERIAL STRIPING INCLUDING CENTERLINE, LANE LINES AND EDGE LINES.
- F. ALL CENTERLINE STRIPING ON ARTERIAL & COLLECTOR STREETS SHALL INCLUDE THE INSTALLATION OF TWO-WAY RAISED PAVEMENT MARKERS, SPACING OF RAISED PAVEMENT MARKERS SHALL BE PER CALTRANS STANDARDS & REQUIREMENTS.
- G. THE CONTRACTOR SHALL RESTORE OR REPLACE ALL EXISTING IMPROVEMENTS DISTURBED DURING CONSTRUCTION INCLUDING, BUT NOT LIMITED TO STREET STRIPING, LANDSCAPING, AND SIGNS.
- H. NEW STRIPING SHALL NOT BE PLACED UNTIL SPOTTED AND SPOTTING APPROVED BY RIVERSIDE COUNTY. EXACT LOCATION OF STRIPING AND PAVEMENT MARKINGS SHALL BE APPROVED BY THE CITY PRIOR TO PAINTING OR INSTALLATION.
- I. ALL WORK SHALL BE COORDINATED WITH AND COMPLETED TO THE SATISFACTION OF THE RIVERSIDE COUNTY PUBLIC WORKS TRAFFIC DIVISION.
- J. FIRE HYDRANTS SHALL BE MARKED WITH BLUE PAVEMENT MARKERS PER RIVERSIDE COUNTY STANDARDS.
- K. ALL PAVEMENT LEGENDS SHALL BE PLACED IN THE CENTER OF THE TRAVEL LANE (EXCLUDING 8' OF PARKING LANE).

CONSTRUCTION NOTES:

- 1 INSTALL "YIELD" PAVEMENT MARKING PER DETAIL "A"
- 2 INSTALL YIELD LINE PER DETAIL "A"
- 3 INSTALL 12" WHITE CROSSWALK
- 4 INSTALL "STOP" PAVEMENT MARKING
- 5 INSTALL 12" WHITE LIMIT LINE
- 6 INSTALL 12" WHITE HATCHING AT 45 DEGREES WITH 5' SPACING

SIGN LEGEND:

DETAIL "A" -
"YIELD" BIKE PATH PAVEMENT
MARKER AND YIELD LINE

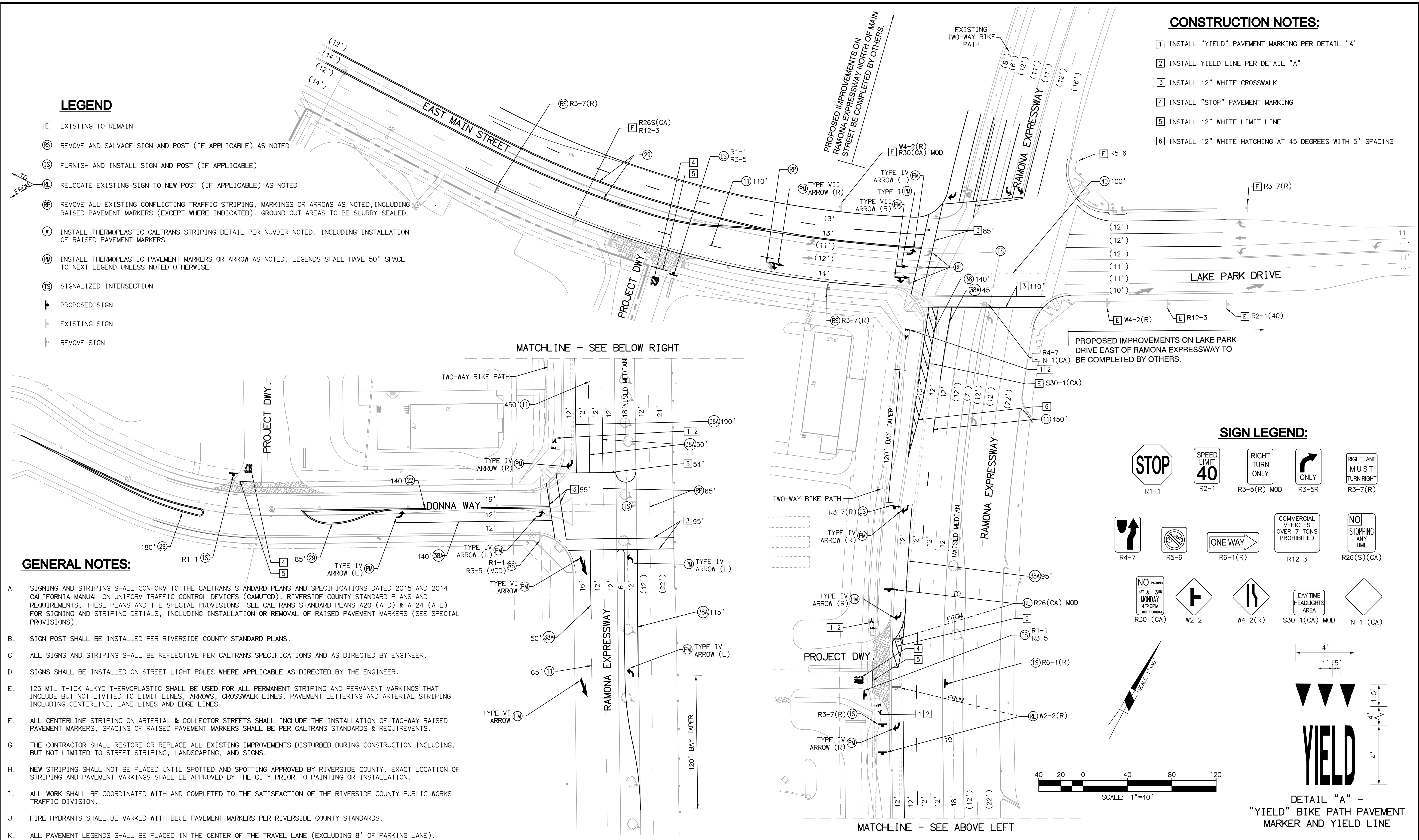
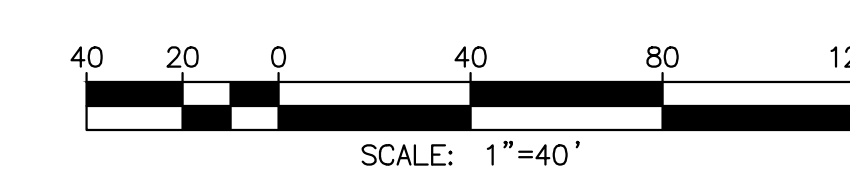

DATE	BY	MARK	REVISIONS	APPR. DATE
	ENGINEER			CITY
DESIGNED BY:		DRAWN BY:		CHECKED BY:

SEAL

APPROVED BY: _____ DATE _____
CITY ENGINEER
R.C.E. NO. _____ EXP. DATE _____
PREPARED BY: _____ DATE _____
R.C.E. NO. _____ EXP. DATE _____

Michael Baker INTERNATIONAL
5050 Avenida Encinas, Ste 200
Carlsbad, CA 92008
Phone: (760) 476-9193 - MBAKERINTL.COM

SCALE: _____ BENCHMARK: _____
DATE: MAY 2019

CITY OF SAN JACINTO
EAST MAIN ST. / LAKE PARK DR.
CONCEPTUAL SIGNING &
STRIPING PLANS
NOT FOR CONSTRUCTION
FOR SOBOBA BAND OF LUISENO INDIANS

SHEET NO. _____
OF SHEETS _____
FILE NO. _____

H:\PDATA\162409_LUISENO VILLAGE RETAIL CENTER\CADD\TRANSPW\DLV\162409-PD-01.DWG GRAY, JORDAN 5/29/2019 9:17 AM