

# APPENDIX

## F

### FLOOD HAZARD MAP

# LEGEND



**SPECIAL FLOOD HAZARD AREAS SUBJECT TO INUNDATION BY THE 1% ANNUAL CHANCE FLOOD**

The 1% annual flood (100-year flood), also known as the base flood, is the flood that has a 1% chance of being equaled or exceeded in any given year. The Special Flood Hazard Area is the area subject to flooding by the 1% annual chance flood. Areas of Special Flood Hazard include Zones A, AE, AH, AO, AR, A99, V, and VE. The Base Flood Elevation is the water-surface elevation of the 1% annual chance flood.

<b>ZONE A</b>	No Base Flood Elevations determined.
<b>ZONE AE</b>	Base Flood Elevations determined.
<b>ZONE AH</b>	Flood depths of 1 to 3 feet (usually areas of ponding); Base Flood Elevations determined.
<b>ZONE AO</b>	Flood depths of 1 to 3 feet (usually sheet flow on sloping terrain); average depths determined. For areas of alluvial fan flooding, velocities also determined.
<b>ZONE AR</b>	Special Flood Hazard Area formerly protected from the 1% annual chance flood by a flood control system that was subsequently decertified. Zone AR indicates that the former flood control system is being restored to provide protection from the 1% annual chance or greater flood.
<b>ZONE A99</b>	Area to be protected from 1% annual chance flood by a Federal flood protection system under construction; no Base Flood Elevations determined.
<b>ZONE V</b>	Coastal flood zone with velocity hazard (wave action); no Base Flood Elevations determined.
<b>ZONE VE</b>	Coastal flood zone with velocity hazard (wave action); Base Flood Elevations determined.



**FLOODWAY AREAS IN ZONE AE**

The floodway is the channel of a stream plus any adjacent floodplain areas that must be kept free of encroachment so that the 1% annual chance flood can be carried without substantial increases in flood heights.

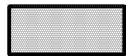

**OTHER FLOOD AREAS**

<b>ZONE X</b>	Areas of 0.2% annual chance flood; areas of 1% annual chance flood with average depths of less than 1 foot or with drainage areas less than 1 square mile; and areas protected by levees from 1% annual chance flood.
---------------	---

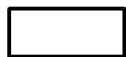

**OTHER AREAS**

<b>ZONE X</b>	Areas determined to be outside the 0.2% annual chance floodplain.
---------------	---

National Flood Insurance Program at 1-800-638-6620.



**MAP SCALE 1" = 1000'**

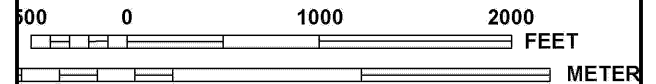

**NFIP**

**NATIONAL FLOOD INSURANCE PROGRAM**

**PANEL 0520E**

**FIRM**

**FLOOD INSURANCE RATE MAP**

**BUTTE COUNTY,  
CALIFORNIA  
AND INCORPORATED AREAS**

**PANEL 520 OF 1200**

(SEE MAP INDEX FOR FIRM PANEL LAYOUT)

CONTAINS:

<u>COMMUNITY</u>	<u>NUMBER</u>	<u>PANEL</u>	<u>SUFFIX</u>
BUTTE COUNTY	060017	0520	E

Notice to User: The Map Number shown below should be used when placing map orders; the Community Number shown above should be used on insurance applications for the subject community.



**MAP NUMBER  
06007C0520E**

**MAP REVISED  
JANUARY 6, 2011**

**Federal Emergency Management Agency**

This is an official copy of a portion of the above referenced flood map. It was extracted using F-MIT On-Line. This map does not reflect changes or amendments which may have been made subsequent to the date on the title block. For the latest product information about National Flood Insurance Program flood maps check the FEMA Flood Map Store at [www.msc.fema.gov](http://www.msc.fema.gov)

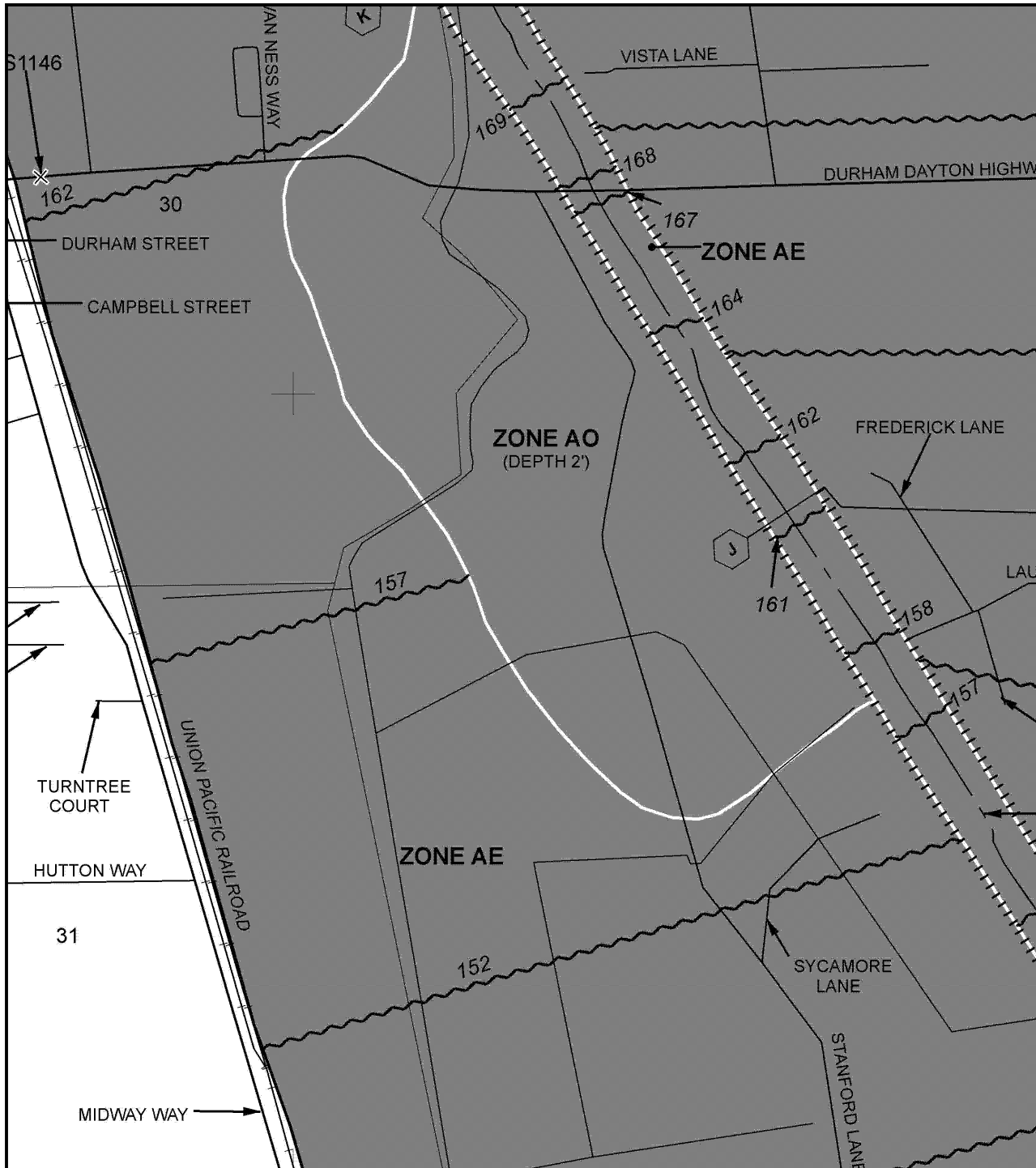

National Flood Insurance Program at 1-800-638-6620.



MAP SCALE 1" = 1000'

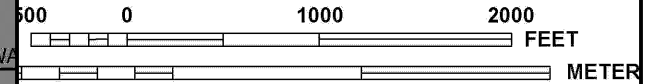

NFIP

NATIONAL FLOOD INSURANCE PROGRAM

PANEL 0520E

**FIRM**

**FLOOD INSURANCE RATE MAP**

**BUTTE COUNTY,  
CALIFORNIA  
AND INCORPORATED AREAS**

**PANEL 520 OF 1200**

(SEE MAP INDEX FOR FIRM PANEL LAYOUT)

CONTAINS:

COMMUNITY	NUMBER	PANEL	SUFFIX
BUTTE COUNTY	060017	0520	E

Notice to User: The Map Number shown below should be used when placing map orders; the Community Number shown above should be used on insurance applications for the subject community.



**MAP NUMBER  
06007C0520E**

**MAP REVISED  
JANUARY 6, 2011**

**Federal Emergency Management Agency**

This is an official copy of a portion of the above referenced flood map. It was extracted using F-MIT On-Line. This map does not reflect changes or amendments which may have been made subsequent to the date on the title block. For the latest product information about National Flood Insurance Program flood maps check the FEMA Flood Map Store at [www.msc.fema.gov](http://www.msc.fema.gov)