

2019038703

Notice of Exemption

Appendix E

To: Office of Planning and Research
P.O. Box 3044, Room 113
Sacramento, CA 95812-3044

County Clerk

County of: _____

From: (Public Agency): Caltrans-District 21657 Riverside DriveRedding, Ca 96001

(Address)

Project Title: Hayfork Elementary School water linesProject Applicant: California Department of Transportation

Project Location - Specific:

Trenching under State Route 3 in Trinity County at post miles 6.86/7.0/7.71.

Project Location - City: HayforkProject Location - County: Trinity

Description of Nature, Purpose and Beneficiaries of Project:

Trinity County Water Works is proposing a project that will install larger water lines to comply with Fire Departments request of higher flows and more hydrants. Caltrans would issue an encroachment permit for proposed improvements within the operational right-of-way of SR 3.

Name of Public Agency Approving Project: Mountain Valley Unified School DistrictName of Person or Agency Carrying Out Project: Trinity County Water Works

Exempt Status: (check one):

☐ Ministerial (Sec. 21080(b)(1); 15268);☐ Declared Emergency (Sec. 21080(b)(3); 15269(a));☐ Emergency Project (Sec. 21080(b)(4); 15269(b)(c));☒ Categorical Exemption. State type and section number: Class 1(b). Section 15301☐ Statutory Exemptions. State code number: _____

Reasons why project is exempt:

See the attached Notice of Exemption completed by Trinity County Water Works.

Lead Agency

Contact Person: Emiliano ProArea Code/Telephone/Extension: (530) 225-3174

If filed by applicant:

1. Attach certified document of exemption finding.

2. Has a Notice of Exemption been filed by the public agency approving the project? ☐ Yes ☐ No

Signature: _____

Date: 3/29/2019Title: SENIOR ENV. PLNR.

Governor's Office of Planning & Research

☒ Signed by Lead Agency ☐ Signed by Applicant

Authority cited: Sections 21083 and 21110, Public Resources Code.
Reference: Sections 21108, 21152, and 21152.1, Public Resources Code.

Date Received for filing at OPR: _____

MAR 29 2019
STATE CLEARINGHOUSE

STATE OF CALIFORNIA · DEPARTMENT OF TRANSPORTATION
ENCROACHMENT PERMIT APPLICATION REVIEW
TR-0110 (REV. 08/2010)

2019038703

APPLICANT Trinity County Waterworks				PERMIT NO. 02-19-N-UJ-0184	
DATE 03/28/2019				DIST /CO /RTE /PM 02-TRI-3-VAR	
Your comments and recommendations are requested regarding an encroachment permit application.				TYPE OF WORK	
REVIEW NEEDED BY 04/04/2019				REVIEWING UNITS Permit Writer - T Ehorn - MS-20 Inspector - S Veatch - MS-20 Environmental - MS-30	
CHARGE ALL "TRAVEL TIME" TO:					
PROJECT CODE 0000001163	PHASE N	REPORTING CODE _____	SUB OBJECT 037		
CHARGE ALL "NON-STORM WATER RELATED REVIEW TIME" TO:					
PROJECT CODE 0000001157	PHASE N	REPORTING CODE 702190184	SUB OBJECT 037		
CHARGE ALL "STORM WATER RELATED REVIEW TIME / CUST SERV / TRAVEL" TO:					
PROJECT CODE 0000001160	PHASE N	REPORTING CODE 702190184 7CUSTSERV 7TRAVEL	SUB OBJECT 037		
THERE IS ADDITIONAL INFORMATION AVAILABLE IN PERMIT FILE.				<input type="checkbox"/> YES <input type="checkbox"/> NO	
BESIDES THOSE LISTED, WHO ELSE SHOULD REVIEW THIS APPLICATION?				LAST Tanya Ehorn (x3499) , Permit Office	
THIS APPLICATION IS BEING REVIEWED SEPARATELY BY EACH UNIT.					

TIME CHARGED*		RESPONSIBLE UNIT	
0000001163 (TRAVEL)	_____ HOURS	PERMIT ENGINEERING EVALUATION REPORT REQUIRED	
0000001157 (REVIEW)	_____ HOURS	<input type="checkbox"/> NO (No adverse impact on highway operations or maintenance.)	
0000001160 (S W REVIEW)	_____ HOURS	DATE _____	
0000001160 (S W CUSTSERV)	_____ HOURS	BY _____, SR. TRANSP. ENGR	
0000001160 (S W TRAVEL)	_____ HOURS	DATE _____	
*MUST MATCH STAFF CENTRAL ENTRY		<input type="checkbox"/> YES <input type="checkbox"/> ATTACHED EST. COMPLETION DATE OF PEER. _____	
PERMIT RECOMMENDED			
<input type="checkbox"/> YES			
<input type="checkbox"/> NO			
<input type="checkbox"/> Need more information (explain)			

REMARKS: (Include necessary changes, required conditions, etc.)

DOUBLE PERMIT REQUIRED? Y N
EST. HOURS OF INSPECTION: _____
BONDS REQUIRED? N Y \$ _____
LEFT OR RIGHT SIDE? L R BOTH
TRAFFIC CONTROL NEEDED:
T-10 T-11 T-12 T-13 T-14 SHLDR SW
R/W WIDTH: _____ Full/to Half
R/W MAP INCLUDED _____
SWPPP _____ WPCP _____ SW SP _____

REVIEWED BY	UNIT CODE	BUSINESS PHONE	DATE
CONCURRED BY	UNIT CODE	BUSINESS PHONE	DATE

ADA Notice For individuals with sensory disabilities, this document is available in alternate formats. For alternate format information, contact the Forms Management Unit at (916) 445-1233, TTY 711, or write to Records and Forms Management, 1120 N Street, MS-89, Sacramento, CA 95814.
FM 91 1402 M (D2 Permit App)

2019038703

STANDARD ENCROACHMENT PERMIT APPLICATION

TR-0100 (REV. 03/2015)

Please type or print clearly your answers. Complete ALL fields, write "N/A" if not applicable.
This application is not complete until all requirements have been approved.

Permission is requested to encroach on the State Highway right-of-way as follows:

1. COUNTY Tri		2. ROUTE 3	3. POSTMILE 6.86/7.0/7.71		FOR CALTRANS USE PERMIT NO. 0219-NUT-0184 DIST/CO/RTE/PM 02/TR1/3/6.86 & 7.0 & 7.71 SIMPLEX STAMP DATE OF SIMPLEX STAMP 10. ESTIMATED COMPLETION DATE ASAP
4. ADDRESS OR STREET NAME Hwy 3			5. CITY Hayfork		
6. CROSS STREET (Distance and direction from project site) Community Dr. & School St.			7. PORTION OF RIGHT-OF-WAY var		
8. WORK TO BE PERFORMED BY <input checked="" type="checkbox"/> OWN FORCES <input type="checkbox"/> CONTRACTOR			9. ESTIMATED START DATE ASAP		
11. EXCAVATION	MAX. DEPTH 3'	AVG. DEPTH 3'	AVG. WIDTH 18"	LENGTH 60'	SURFACE TYPE AC
12. ESTIMATED COST WITHIN STATE HIGHWAY RIGHT-OF-WAY \$ 15,000.00			FUNDING SOURCE(S) <input type="checkbox"/> FEDERAL <input type="checkbox"/> STATE <input checked="" type="checkbox"/> LOCAL <input type="checkbox"/> PRIVATE		
13. PIPES	PRODUCT TYPE PVC HDPE STEEL	DIAMETER 8" & 10"	VOLTAGE / PSIG 90 psi		14. CALTRANS' PROJECT CODE (ID)
15. <input type="checkbox"/> Double Permit Parent Permit Number _____ Applicant's Reference Number / Utility Work Order Number _____					

16. Have your plans been reviewed by another Caltrans branch? ☒ NO ☐ YES (If "YES") Who? _____

17. Completely describe work to be done within STATE Highway right-of-way:

Attach 6 complete sets of plans (folded to 8.5" x 11") and any applicable specifications, calculations, maps, etc.

6 sets of drawings attached.

TRANSVERSE BORE NEW WATER SUPPLY
LINES FOR FIRE SUPPRESSION FOR THE
MOUNTAIN VALLEY UNIFIED SCHOOL DISTRICT,
UNDER HIGHWAY 3 AT THREE
LOCATIONS (POST MILES 6.86, 7.0, & 7.71),
IN HAYFORK, TRINITY COUNTY.

UPDATED DAVIS PCV'D.
RECEIVED
MAR 26 2019
DISTRICT 2
PERMITS

RECEIVED
DEC 17 2018
DISTRICT 2
PERMITS

18. Is a City, County or other public agency involved in the approval of this project?

☐ YES (If "YES", check type of project AND attach environmental documentation and conditions of approval)

☐ COMMERCIAL DEVELOPMENT ☐ BUILDING ☐ GRADING ☐ OTHER _____

☒ CATEGORICALLY EXEMPT ☐ NEGATIVE DECLARATION ☐ ENVIRONMENTAL IMPACT REPORT ☐ OTHER _____

☒ NO (If "NO", please check the category below which best describes the project AND answer questions A - K on page 2)

☐ DRIVEWAY OR ROAD APPROACH, RECONSTRUCTION, MAINTENANCE OR RESURFACING

☒ PUBLIC UTILITY MODIFICATIONS, EXTENSIONS, HOOKUPS

☐ FLAGS, SIGNS, BANNERS, DECORATIONS, PARADES AND CELEBRATIONS

☐ OTHER _____

☐ FENCE

☐ MAILBOX

☐ EROSION CONTROL

☐ LANDSCAPING

2019038703



CALIFORNIA
DEPARTMENT OF
EDUCATION

TOM TORLAKSON

STATE SUPERINTENDENT OF PUBLIC INSTRUCTION

March 7, 2018

Governing Board
Mountain Valley Unified
PO Box 339
Hayfork, CA 96041

Project Tracking No: 75028-7
Re: Hayfork Valley Elementary
County: Trinity
Square Feet: 11,704
Grade Level: K - 8

Dear Governing Board:

Subject: Final Plan Approval - Modernization

The California Department of Education approves the plans with the title sheet date of December 15, 2017, for the above referenced project. The plans were received on February 6, 2018. The plans meet the California Department of Education's standards for educational adequacy (California Code of Regulations, Title 5, et seq. and Education Code 17251(c) and (d)).

It is the responsibility of the school district to meet all requirements concerning toilet facilities, drinking water supply, sewage disposal, food service facilities and other plan elements having primary health and safety implications. The plans should be reviewed by the local health agency having jurisdiction and a written approval should be secured and filed in the school district's records. If the approved project involves work on an existing school building, it is the responsibility of the school district to meet all Federal, State and local requirements relating to the identification, remediation and/or removal of hazardous levels of lead and asbestos containing materials before or during construction. It is the responsibility of the district to complete all of the mitigation measures identified in the documents submitted to the California Department of Education for review.

The school site for this project is 7 usable acres. This represents 106.06% of the California Department of Education's recommended site size of 6.6 acres, as contained in the California Department of Education's "Guide to School Site Analysis and Development(2000)," for the current CBEDS enrollment of the site and the student capacity added by this project as calculated pursuant to SAB Regulation 1859.83(d).

The project as approved consists of:

<u>TEACHING STATIONS</u>	<u>GRADE LEVEL</u>	<u>ROOMS</u>	<u>STUDENTS</u>
Classrooms	1 - 6	3	75

Based on the standards specified in Education Code 17071.25 and the number of teaching stations in the project, the student capacity of this project is 75.

Mountain Valley Unified
March 7, 2018
Page 2

2019038703

PTN: 75028-7
Hayfork Valley Elementary

CORE FACILITIES:

Multi-Purpose

Teacher Work Room

This is a facilities hardship project.

The district has certified that this project is either exempt from, or has completed, the California Environmental Quality Act (CEQA) process.

For projects to be funded under the Leroy F. Greene School Facility Act of 1998, funding requests to the State Allocation Board must be submitted within two (2) years of the date of this letter. If the district is not seeking financial assistance from the State Allocation Board, the project must commence construction within two (2) years of the date of this letter. Regardless of the funding source, if, prior to construction, changes are made to the plans that would affect or alter the California Department of Education's original approval (including but not limited to changes in surrounding land uses, the master plan capacity of the project, changes in code and/or regulation, or a subsequent CEQA determination), the plan may be subject to reevaluation using the most recent standards.

Please contact the undersigned if you have questions regarding this letter.

Sincerely,



Fred A. Yeager, Assistant Director
School Facilities and Transportation Services
Division

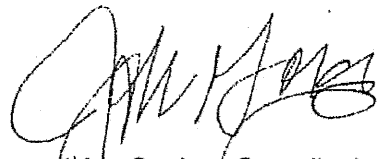

John Gordon, Consultant
School Facilities and Transportation Services
Division
(916)323-0575

DP9467/P8613
cc: Architect



CALIFORNIA DEPARTMENT OF EDUCATION
SCHOOL FACILITIES PLANNING DIVISION

2019038703

SFPD 4.08 – Rev. July 2010

PLAN SUBMISSION REQUIREMENTS FOR MODERNIZATION PROJECTS

Local Educational Agencies (LEA) requesting modernization funds from the State Allocation Board (SAB) must have the plans reviewed and approved by the California Department of Education (CDE) (*Education Code* Section 17070.50) prior to submitting a funding request.

Preliminary and Final Plan Submission Checklists – The checklists included in this packet identifying the items needed for preliminary plan and final plan submittal must be completed and submitted with the plans.

After preliminary plan review, if CDE did not require any changes and the LEA did not revise the plans from the preliminary plan submission, the LEA need not submit a second SFPD 4.08C form or a second set of plans. Indicate in a cover letter that no changes were made to the plans or the educational specifications, and submit an updated SFPD 4.08A, Project Information for Modernization and SFPD 4.08B, Local Educational Agency Certifications for Modernization.

CDE Resources and Contact Information - The required forms and instructions necessary for submitting modernization plans to CDE are located in this packet.

For more information on the plan review process, visit the SFPD Web page at <http://www.cde.ca.gov/ls/fa> or call 916-322-2470.

California Code of Regulations, Title 5 (Title 5) can be obtained on the Internet at <http://www.cde.ca.gov/ls/fa/sf/codes.asp>.

Submit plans and the required documents to the following address:

California Department of Education
School Facilities Planning Division
1430 N Street, Suite 1201
Sacramento, CA 95814

SFPD 4.08 Modernization Preliminary Plan Checklist

LEA to check boxes indicating the items included in the plan submittal. Submit checklist with plans.

CDE may recommend or require changes; therefore, the submission of preliminary plans is required before submission of final plans. It is not necessary to submit construction specifications.

Do not include drawings, calculations, or plans for buildings not included in the modernization project.

Preliminary Plans

- ☐ 1. **SFPD 4.08A, Project Information for Modernization**, including the project tracking number (PTN). The PTN is a unique identifier that links application data used by the SFPD, the Division of the State Architect (DSA), and the Office of Public School Construction (OPSC). Plans without a PTN will not be approved by the SFPD. A PTN may be obtained from the OPSC Web site at <http://www.opsc.dgs.ca.gov> or the SFPD Web site.
- ☐ 2. **Preliminary (Schematic) Plans**
 - ☐ Half-size plans and matching 11" x 17" plan set. Information on half-size plans must be legible and plans must be able to be scaled; otherwise full-size plans must be submitted.
 - ☐ Site plan must have street designations and labeled student, staff and visitor parking areas, as well as bus and parent drop-off areas.
 - ☐ Floor plans with dimensions and spaces labeled.
 - ☐ Dimensions and area calculations.
 - ☐ Interiors or schedules if applicable and available.
 - ☐ Elevations, if applicable and available.
 - ☐ Demolition plan, if applicable. Identify the location, type and use of buildings being removed.
- ☐ 3. **Plan Summary Form(s) – Modernization (All that apply. Some projects may include both the modernization of existing buildings and the demolition and rebuilding of buildings.)**
 - ☐ The project includes modernization of existing building area. Complete 4.08C Part 1 Plan Summary-Modernization for that portion of the project.
 - ☐ The project includes demolition and rebuilding of 50 percent or more of the existing square footage. Complete Plan Summary Form - New Construction. The form is available at <http://www.cde.ca.gov/ls/fa>. See Plan Summary form for greater detail.
 - ☐ The project includes demolition and rebuilding, and the area to be replaced is less than 50 percent of the demolished square footage. Complete the Plan Summary Form – Addition for that portion of the project. The form is available at <http://www.cde.ca.gov/ls/fa>. See Plan Summary form for greater detail.
- ☐ 4. **Form 4.08C Part 2 – Space Conversions:** Complete only for spaces that will be altered in size or purpose.

SFPD 4.08 Modernization Final Plan Checklist

After preliminary plan review, if CDE did not require any changes and the LEA did not revise the plans from the preliminary plan submission, the LEA need not submit a second SFPD 4.08C form or a second set of plans. Indicate in a cover letter that no changes were made to the plans or the educational specifications, and submit an updated SFPD 4.08A, Project Information for Modernization and SFPD 4.08B, Local Educational Agency Certifications for Modernization.

Do not include drawings, calculations, or plans for buildings not included in the modernization project.

- ☒ 1. **SFPD 4.08A, Project Information for Modernization (updated)**, including the PTN and the construction cost estimate that the LEA will submit to the OPSC.
- ☒ 2. **SFPD 4.08B, Local Educational Agency Certifications for Modernization.**
- ☒ 3. **Plan Summary Form(s) - Modernization** – Provide updated 4.08C Part 1 Plan Summary – Modernization, and/or Plan Summary – New Construction, and/or Plan Summary – Addition as applicable. If unchanged since preliminary review, note that no changes have been made to the educational specifications since the preliminary plan submission.
- ☒ 4. **Form 4.08C Part 2 – Space Conversions:** Complete only for spaces that will be altered in size or purpose.
- ☒ 5. **Final plans**
 - ☒ Half-size plans and matching 11" x 17" plan set. Information on half-size plans must be legible and plans must be able to be scaled; otherwise full-size plans must be submitted. If revisions are limited to a few pages, submit only those pages and note in cover letter that no other pages were revised.
 - ☐ Written response to any questions and/or comments in CDE's Preliminary Plan Review letter.
 - ☒ Site plan must have street designations and labeled student, staff, and visitor parking areas, as well as bus and parent drop-off areas.
 - ☒ Floor plans with dimensions and spaces labeled.
 - ☒ Dimensions and area calculations.
 - ☒ Interiors or schedules if applicable.
 - ☒ Elevations if applicable.
 - ☒ Demolition plan, if applicable. Identify the location, type, and use of buildings being removed.

SFPD 4.08A
Contact and Project Information

2019038703

Local Educational Agency (LEA) Information

Project Tracking #	7	5	0	2	8	-	0	0	0	7
--------------------	---	---	---	---	---	---	---	---	---	---

County Trinity

LEA Mountain Valley Unified School District

School Name Hayfork Elementary School

Street and Closest Cross Street 6930 State Hwy 3 Hayfork, CA 96041

LEA Contact (Please Print)

LEA Representative Contact for Title Robin Jackson
Business Manager

Phone 530-628-5265 ext 129

Fax 530-628-5267

Mailing Address 231 Oak Ave PO Box 339 Hayfork, CA 96041

E-mail rjackson@mvusd.us

Signature ☒ The governing board of the LEA has authorized me to submit this application and to request exemptions pursuant to Title 5, Section 14030 (r).

Robin Jackson

LEA Contact for questions, if different from above (Please Print)

Name _____

Title _____

Phone _____

Fax _____

E-Mail _____

Architect Contact (Please Print)

Contact Name Shawn LeCrone

Firm Name PBK

Mailing Address 2860 Gateway Oaks Drive Suite 370 Sacramento CA 95833

Phone 916-682-9494

Fax 916-682-0990

E-mail Shawn.LeCrone@pbk.com

SFPD 4.08A

Project Information			
Plans are submitted for <input type="checkbox"/> Preliminary Review <input checked="" type="checkbox"/> Final Approval			
Grade Levels	K-8	Grades in Class Size Reduction	
Beginning classroom count (this project)*	3	Project Capacity (this project)	75
Ending classroom count (this project)**	3	Total Project Area - this project (square feet)	11,704
Are there related new construction or modernization projects? Explain.			
<p>*Existing site: Before demolition, space conversions or removal of classrooms (if applicable)</p> <p>**The total number of classrooms at the end of this project</p>			

Site Area	
School Site Acres – Gross 10.3	Joint-Use Acres – Gross
School Site Acres – Net 10.3	Joint Use Acres – Net
School Site Acres Net plus Joint use Acres Net	

Construction Cost Estimate	
Construction Cost Estimate as reported to DSA - This figure multiplied by 0.0007 to determine the CDE plan review fee. (Education Code Section 17251(a))	\$5,000,000

SFPD 4.08B**Local Educational Agency Certifications for Modernization**

(For final plans only)

County	Project Tracking Number
Trinity County	7 5 0 2 8 — 0 0 0 7
Local Educational Agency	School
Mountain Valley Unified School District	Hayfork Elementary School

1. Existing School Safety Certification - An LEA modernizing an existing school site must certify that it has reviewed the following *California Code of Regulations, Title 5* standards for this school modernization project and that the project will not create any new significant safety hazards or exacerbate any existing safety hazards to students.

Check each box to indicate compliance.

California Code of Regulations, Title 5, Section 14010:

- ☒ (c) Powerlines/Electromagnetic fields
- ☒ (d) Within 1,500 feet of a railroad
- ☒ (e) Traffic noise
- ☒ (f) Active fault or fault trace
- ☒ (g) Flood or dam inundation area
- ☒ (h) Near an above ground water or fuel storage tank or within 1,500 feet of a pipeline, which can pose a safety hazard
- ☒ (i) Liquefaction/landslides
- ☒ (l) Traffic/pedestrian safety
- ☒ (m) Compatible existing and proposed surrounding land uses
- ☒ (q) Exposure to adverse light, wind, and air pollution
- ☒ (r) Easements restricting access or building placement
- ☒ (t) Within 2,000 feet of a significant disposal of hazardous waste

2. California Environmental Quality Act (CEQA) Compliance

Per *Public Resources Code* sections 21000 et seq.; and CEQA Guidelines sections 15000 et seq.

(Check one and fill in dates as applicable.)

The LEA certifies that it has completed for this project all actions required pursuant to CEQA and determined this project to be:

- ☐ A. Not a project for purposes of CEQA and that no CEQA action is required; or
- ☒ B. Completely exempt from preparation of CEQA documents either by (please check as appropriate) ___statutory, X_categorical, or ___general rule exemption; or
- ☐ C. Fully covered in a **Negative Declaration/Initial Study** adopted by the LEA; or
- ☐ D. Fully covered in a **Final Environmental Impact Report (EIR)** adopted and certified by the LEA; or
- ☐ E. Fully covered within **another lead agency's** adopted CEQA document, and if necessary, the LEA has adopted a finding of no new impact.

If applicable:

Date the **Final Environmental Impact Report** or **Negative Declaration** was adopted: _____

Date the project was approved by the LEA governing board: _____

Date the **Notice of Exemption** or **Notice of Determination** was filed with the County Clerk: _____

3. CDE Recommended Acres and Additional SAB Funding

The SAB requires information on the CDE recommended acres for a project. This information is used to determine if the project is eligible for specified additional funding. The CDE collects the following information for all projects regardless if the LEA intends to apply for the additional funding. See *SAB Regulation* Section 1859.83(d).

Physical Education Facilities

For middle schools, does the educational program require football and track facilities? ☐ Yes ☒ No

For high schools, does the educational program require:

- | | | |
|---|------------------------------|-----------------------------|
| 1) Swimming pool? | <input type="checkbox"/> Yes | <input type="checkbox"/> No |
| 2) Diving pool? | <input type="checkbox"/> Yes | <input type="checkbox"/> No |
| 3) Baseball field, including bleachers and dugouts? | <input type="checkbox"/> Yes | <input type="checkbox"/> No |
| 4) Football field and track, including a stadium? | <input type="checkbox"/> Yes | <input type="checkbox"/> No |

LEA Completion

Grades	Kinder.	1 - 3	4 - 6	7 - 8	9 - 12	Special Ed Nonsevere	Special Ed Severe	Total
Current CBEDS Enrollment of School (as adjusted for MTYRE*, if applicable)	18	44	67	44				173

CDE Completion

CDE Verification of CBEDS								
Net Capacity Added by This Project <i>SAB Regulations</i> sections 1859-1883(d) <i>Education Code</i> Section 17071.25(a)(2)								
Non-severe Special Education/ Severe Special Education Students								
Total Enrollment of School								
**CDE-Recommended Acres								

*For MTYRE, enter the maximum enrollment on the site at one time (*SAB Regulation* Section 1859.2.

**Based on the *Guide to School Site Analysis and Development*, 2000 Edition

Net Usable Acres as a Percent of CDE-Recommended Acres

I certify, as the local educational agency representative:

1. The information reported on this form is true and correct and that the above named local educational agency has reviewed the *California Code of Regulations, Title 5* standards, cited in Section 1 herein, for this school construction/replacement project and has determined that the project will not create any new significant safety hazards or exacerbate any existing safety hazards to students;
2. Pursuant to *Education Code* Section 17077.10 every permanent or portable classroom in this project will be provided a telephone that is a hard-wired or wireless connection to a public-switched telephone network, and
3. If a different and/or additional California Environmental Quality Act (CEQA) document (e.g., negative declaration, environmental impact report, or supplement) is adopted for this project subsequent to this certification, the local educational agency shall notify immediately the School Facility Planning Division and the Office of Public School Construction.

Robin Jackson

Name of Authorized Local Educational Agency Representative

Signature of Authorized Local Educational Agency Representative

Business Manager

Title

Date

SFPD 4.08C, PART ONE**Plan Summary - Modernization**

(Submit with preliminary and final modernization plans)

County Trinity	Project Tracking Number <table border="1"><tr><td>7</td><td>5</td><td>0</td><td>2</td><td>8</td><td>—</td><td>0</td><td>0</td><td>0</td><td>7</td></tr></table>	7	5	0	2	8	—	0	0	0	7
7	5	0	2	8	—	0	0	0	7		
Local Educational Agency Mountain Valley Unified School District	School Hayfork Elementary										
Summary of how the project supports the LEA's educational program: This will be a facility hardship project. The school's multipurpose room/gym and one classroom wing requires remediation for mold. Work includes removal and replacement all affected systems and finishes, including roof, walls, floors windows, HVAC system.											
Description of the scope of work in the following areas: A. Technology (<input type="checkbox"/> Centralized Technology Laboratory <input type="checkbox"/> Dispersed Technology <input type="checkbox"/> Both <input type="checkbox"/> None) Affected Electrical systems will be removed and replaced.											
B. Science (Indicate if the project includes science laboratories and if caustic and/or corrosive materials will be used)											
C. Heating, Ventilation, Air Conditioning Affected HVAC systems will be removed and replaced											
D. Plumbing											

SFPD 4.08C, PART ONE

E. Lighting, Ceilings, Electrical Affected finishes are removed and replaced.
F. Floors, Doors, Walls, Windows Affected finishes are removed and replaced.
G. Cabinetry Affected casework are removed and replaced.
H. Accessibility
I. Other

2019038703

SFPD 4.08C, PART TWO

Space Conversions (Complete only for spaces that will be altered in size or purpose)

County Trinity	Project Tracking Number 7 5 0 2 8 — 0 0 0 7
Local Educational Agency Mountain Valley Unified School District	School Hayfork Elementary School

Some modernization projects may include a change in the purpose and/or size of a particular space to provide for an environment suitable to the current and future educational program. If a space is altered significantly, complete this form. Removing a wall to create one large classroom out of two current classrooms would be significant. However, removing a stall in a restroom to make it handicapped accessible would be insignificant and not required on this form.

NOTE: Do not complete this section if teaching stations and support spaces are not being altered in size or purpose.

Column A Building Identification: Indicate the building identification by letter, number, or name.

Column B Type of Space and Educational Program: Label the type of space provided in each building under the column labeled "current". Indicate under the column labeled "planned" the type of space after modernization.

Column C Square Feet Per Space and Number of Spaces: Provide the current number of square feet per type of space to be converted and the number of spaces under the two columns under "current." Provide the square feet for the newly planned space and number of spaces under the "planned" column.

For example:

Current		Planned	
Square Feet	No. of Spaces	Square Feet	No. of Spaces
780	2	1,560	1

Column D Purposes: Provide a brief explanation of the educational purpose for the conversion. Example: A metal shop is converted to a simulation technology laboratory to provide students with exposure to various skills in operating robotics equipment and related computer programming.

A	B		C				D
Building Identification	Type of Space and Educational Program		Square Feet per Space and Number of Spaces				Purposes
	Current	Planned	Current		Planned		
			Square Feet	No. of Spaces	Square Feet	No. of Spaces	

Attach additional sheets if necessary

REVISIONS	BY

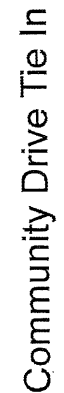

REGISTERED PROFESSIONAL ENGINEER
MARK A. DARNALL
No. C44512
Exp. 03/20
CIVIL
STATE OF CALIFORNIA

Trinity County
Water Works
Hayfork, CA

DRAWN: M. DARNAL
CHECKED: M. DARNAL
DATE: 11/28/18
SCALE:
SHEET: OF

2019038703

EP# 0219-NUJ-0184

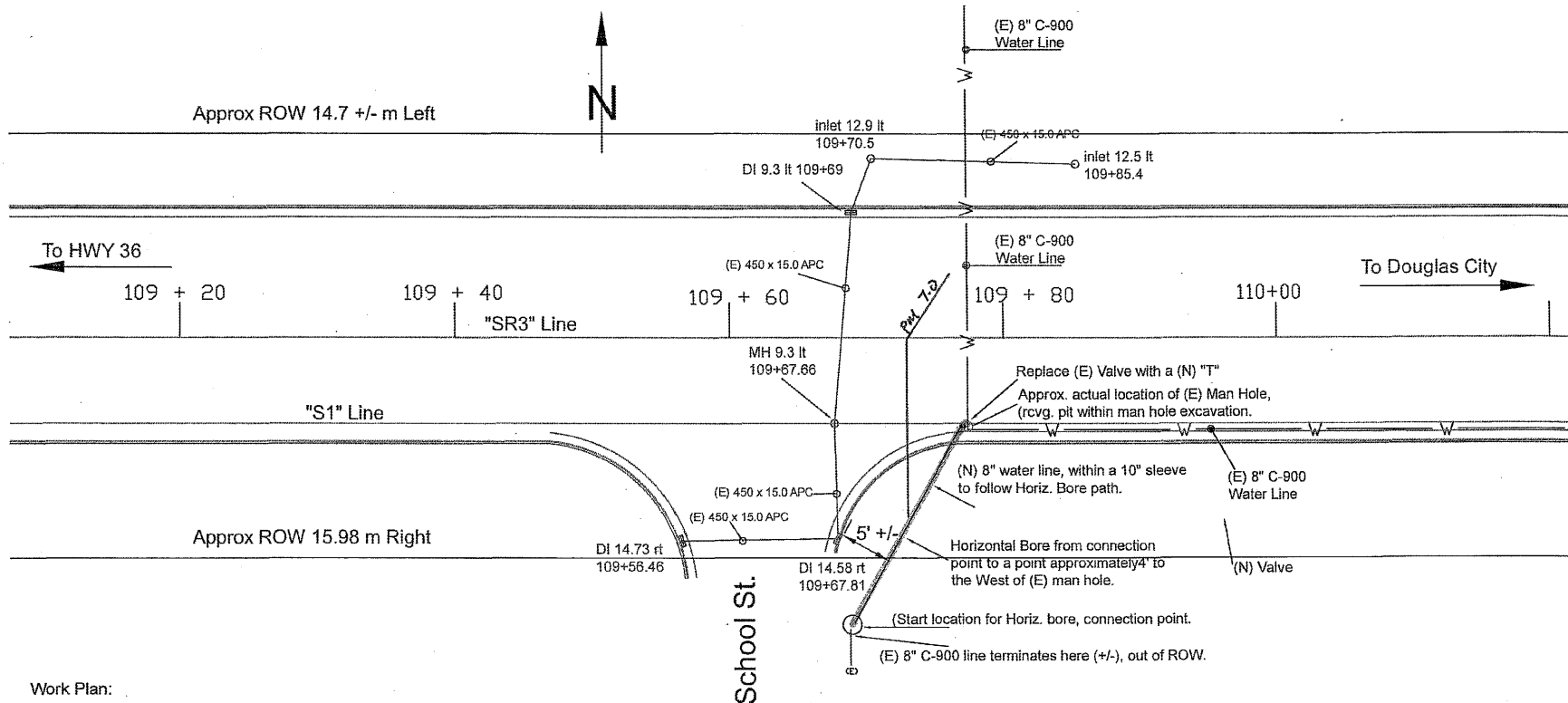

Work Plan:

- 1) Locate (E) 8" water line, terminating off of the ROW. This point establishes approx. location for start of horizontal bore. Horizontal bore to aim for a point approx. 4' to the west of the (E) manhole.
- 2) Excavate on a radius of approximately 4' +/- from center of manhole, excavation will be only on the west side +/-.
- 3) Remove (E) valve, replace with a "T". New lateral coming off of the new "T" has a new valve adjacent to the "T" (Existing valve is within a vault, no excavation required. All water Line, (E) and (N) is 8" nom. dia.
- 4) Complete all connections, backfill over top of new water line with approx. 4" of clean sand. Complete backfill of excavation, at (E) manhole, with 3 sack sand slurry mix. to a point to match existing AC thickness. Replace AC.

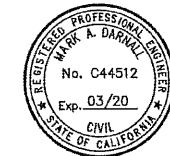

DATE SIGNED: 2-28-19

REVISIONS		BY

School Street Inter-tie

Trinity County
Water Works
Hayfork, CA

2019038703

DRAWN: M. DARIN
CHECKED: M. DARIN
DATE: 11/28/18
SCALE:
SHEET: OF

EP# 0219-N4J-0187

REVISIONS	BY

Oak St. Xing

Trinity County
Water Works
Hayfork CA

DRAWN: M. DARNALL
CHECKED: M. DARNALL
DATE: 11/28/18
SCALE: nbs
SHEET: 1
OF 1

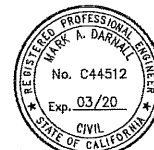
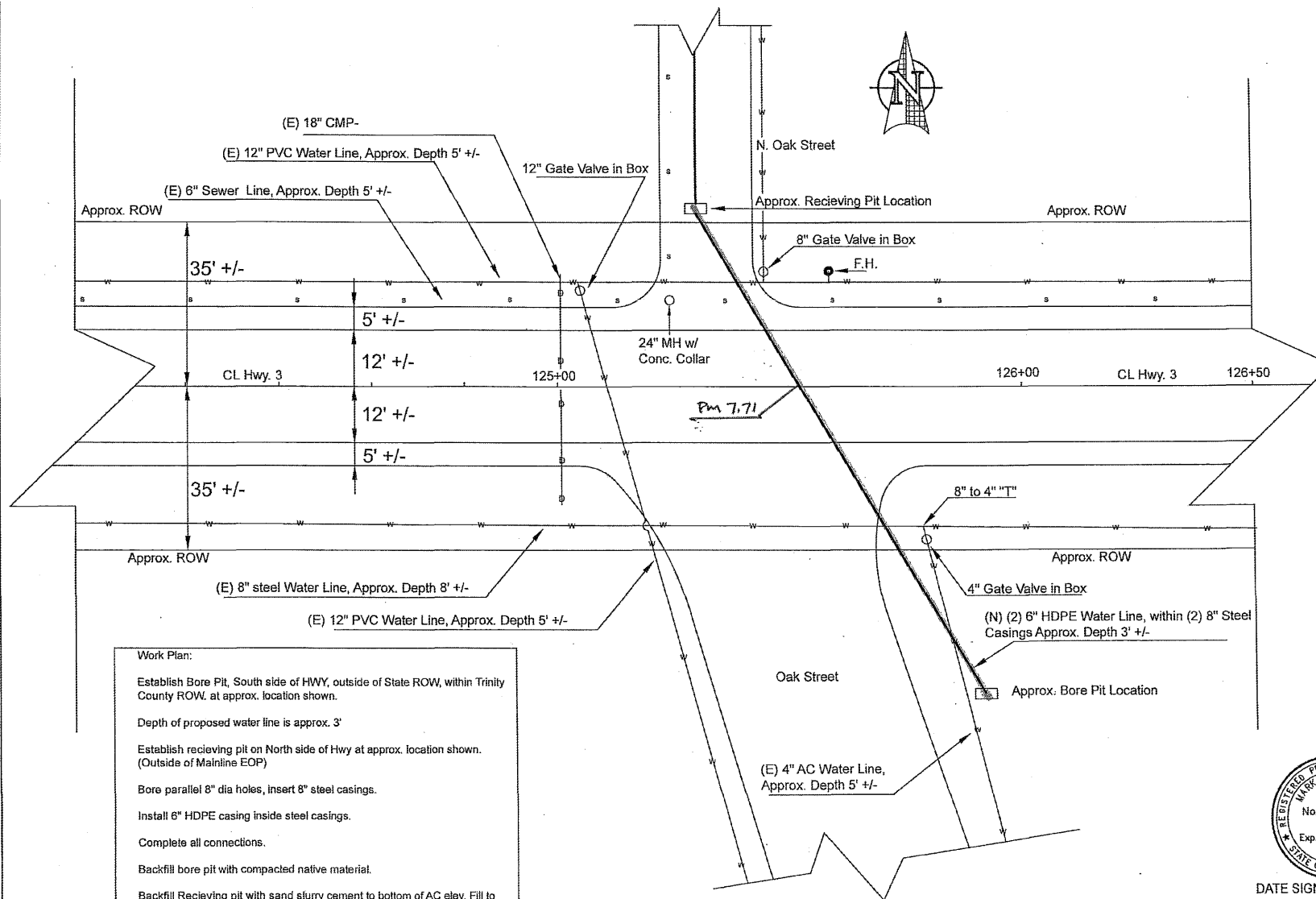

DATE SIGNED: 2-26-19