



Phase I ESA

141 South Taaffe Street

Sunnyvale, CA 94086

Inquiry Number: 5387365.10

August 09, 2018

Certified Sanborn® Map Report



6 Armstrong Road, 4th floor
Shelton, CT 06484
Toll Free: 800.352.0050
www.edrnet.com

Certified Sanborn® Map Report

08/09/18

Site Name:

Phase I ESA
141 South Taaffe Street
Sunnyvale, CA 94086
EDR Inquiry # 5387365.10

Client Name:

Cornerstone Earth Group
1259 Oakmead Parkway
Sunnyvale, CA 94085
Contact: Stason Foster



The Sanborn Library has been searched by EDR and maps covering the target property location as provided by Cornerstone Earth Group were identified for the years listed below. The Sanborn Library is the largest, most complete collection of fire insurance maps. The collection includes maps from Sanborn, Bromley, Perris & Browne, Hopkins, Barlow, and others. Only Environmental Data Resources Inc. (EDR) is authorized to grant rights for commercial reproduction of maps by the Sanborn Library LLC, the copyright holder for the collection. Results can be authenticated by visiting www.edrnet.com/sanborn.

The Sanborn Library is continually enhanced with newly identified map archives. This report accesses all maps in the collection as of the day this report was generated.

Certified Sanborn Results:

Certification # E210-4E32-A13B

PO # 118-97-1

Project Altair, Taaffe and Aries Way

Maps Provided:

1959
1943
1930
1911
1908



Sanborn® Library search results

Certification #: E210-4E32-A13B

The Sanborn Library includes more than 1.2 million fire insurance maps from Sanborn, Bromley, Perris & Browne, Hopkins, Barlow and others which track historical property usage in approximately 12,000 American cities and towns. Collections searched:

- ☒ Library of Congress
- ☒ University Publications of America
- ☒ EDR Private Collection

The Sanborn Library LLC Since 1866™

Limited Permission To Make Copies

Cornerstone Earth Group (the client) is permitted to make up to FIVE photocopies of this Sanborn Map transmittal and each fire insurance map accompanying this report solely for the limited use of its customer. No one other than the client is authorized to make copies. Upon request made directly to an EDR Account Executive, the client may be permitted to make a limited number of additional photocopies. This permission is conditioned upon compliance by the client, its customer and their agents with EDR's copyright policy; a copy of which is available upon request.

Disclaimer - Copyright and Trademark Notice

This Report contains certain information obtained from a variety of public and other sources reasonably available to Environmental Data Resources, Inc. It cannot be concluded from this Report that coverage information for the target and surrounding properties does not exist from other sources. NO WARRANTY EXPRESSED OR IMPLIED, IS MADE WHATSOEVER IN CONNECTION WITH THIS REPORT. ENVIRONMENTAL DATA RESOURCES, INC. SPECIFICALLY DISCLAIMS THE MAKING OF ANY SUCH WARRANTIES, INCLUDING WITHOUT LIMITATION, MERCHANTABILITY OR FITNESS FOR A PARTICULAR USE OR PURPOSE. ALL RISK IS ASSUMED BY THE USER. IN NO EVENT SHALL ENVIRONMENTAL DATA RESOURCES, INC. BE LIABLE TO ANYONE, WHETHER ARISING OUT OF ERRORS OR OMISSIONS, NEGLIGENCE, ACCIDENT OR ANY OTHER CAUSE, FOR ANY LOSS OF DAMAGE, INCLUDING, WITHOUT LIMITATION, SPECIAL, INCIDENTAL, CONSEQUENTIAL, OR EXEMPLARY DAMAGES. ANY LIABILITY ON THE PART OF ENVIRONMENTAL DATA RESOURCES, INC. IS STRICTLY LIMITED TO A REFUND OF THE AMOUNT PAID FOR THIS REPORT. Purchaser accepts this Report "AS IS". Any analyses, estimates, ratings, environmental risk levels or risk codes provided in this Report are provided for illustrative purposes only, and are not intended to provide, nor should they be interpreted as providing any facts regarding, or prediction or forecast of, any environmental risk for any property. Only a Phase I Environmental Site Assessment performed by an environmental professional can provide information regarding the environmental risk for any property. Additionally, the information provided in this Report is not to be construed as legal advice.

Copyright 2018 by Environmental Data Resources, Inc. All rights reserved. Reproduction in any media or format, in whole or in part, of any report or map of Environmental Data Resources, Inc., or its affiliates, is prohibited without prior written permission.

EDR and its logos (including Sanborn and Sanborn Map) are trademarks of Environmental Data Resources, Inc. or its affiliates. All other trademarks used herein are the property of their respective owners.

Sanborn Sheet Key

This Certified Sanborn Map Report is based upon the following Sanborn Fire Insurance map sheets.



1959 Source Sheets



Volume 1, Sheet 5
1959

1943 Source Sheets



Volume 1, Sheet 5
1943

1930 Source Sheets



Volume 1, Sheet 5
1930

1911 Source Sheets



Volume 1, Sheet 2
1911

Sanborn Sheet Key

This Certified Sanborn Map Report is based upon the following Sanborn Fire Insurance map sheets.



1908 Source Sheets



Volume 1, Sheet 3
1908

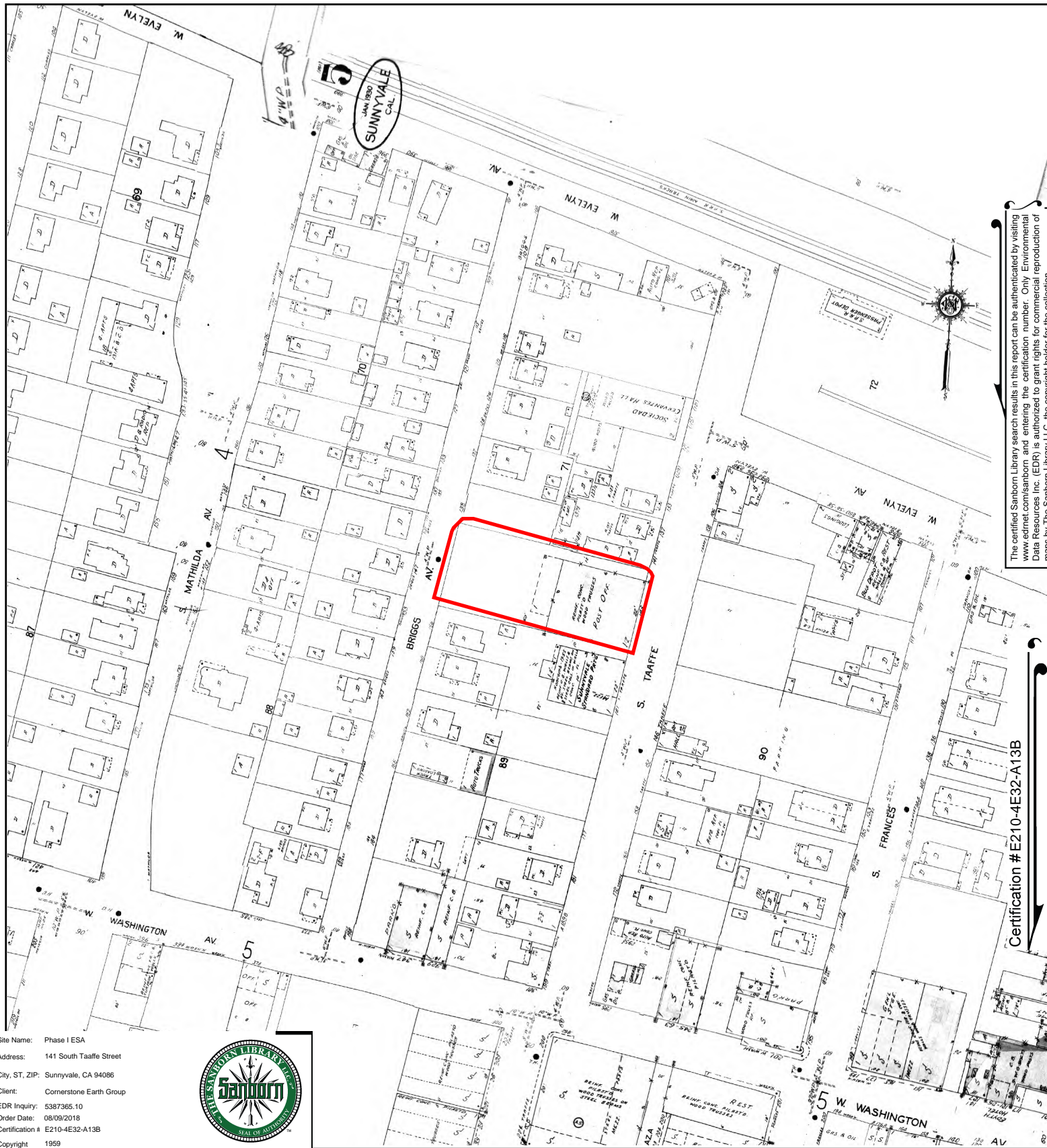

The certified Sanborn Library search results in this report can be authenticated by visiting www.edr.com/sanborn and entering the certification number. Only Environmental Data Resources Inc. (EDR) is authorized to grant rights for commercial reproduction of maps by The Sanborn Library LLC, the copyright holder for the collection.

Certification #E210-4E32-A13B

Site Name: Phase I ESA
 Address: 141 South Taaffe Street
 City, ST, ZIP: Sunnyvale, CA 94086
 Client: Cornerstone Earth Group
 EDR Inquiry: 5387365.10
 Order Date: 08/09/2018
 Certification #: E210-4E32-A13B
 Copyright: 1959



This Certified Sanborn Map combines the following sheets.
 Outlined areas indicate map sheets within the collection.

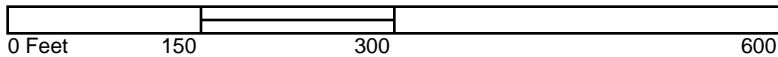

Volume 1, Sheet 5

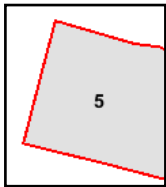

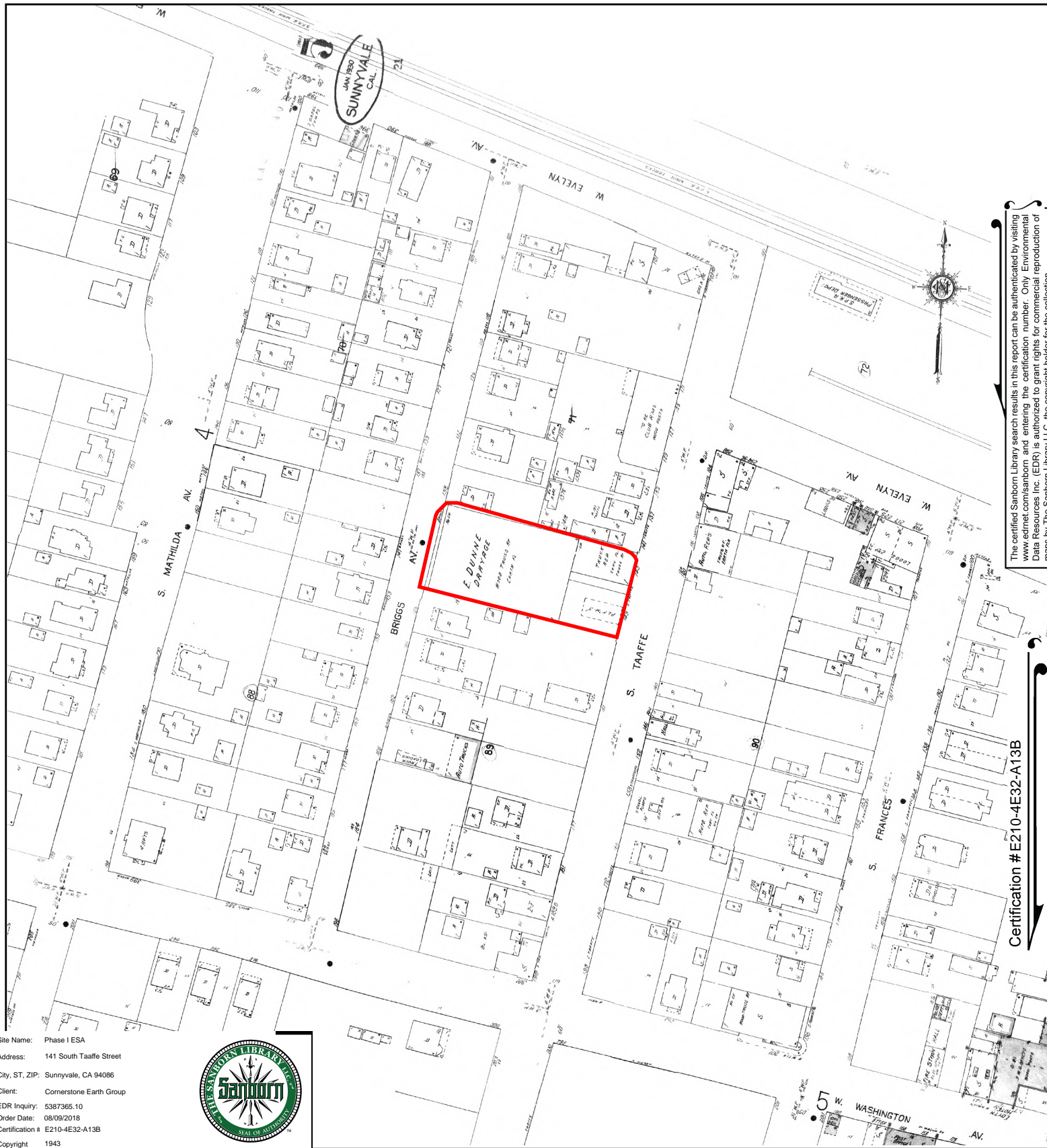

The certified Sanborn Library search results in this report can be authenticated by visiting www.edrnet.com/sanborn and entering the certification number. Only Environmental Data Resources Inc. (EDR) is authorized to grant rights for commercial reproduction of maps by The Sanborn Library LLC, the copyright holder for the collection.

Certification #E210-4E32-A13B

Site Name: Phase I ESA

Address: 141 South Taaffe Street

City, ST, ZIP: Sunnyvale, CA 94086

Client: Cornerstone Earth Group

EDR Inquiry: 5387365.10

Order Date: 08/09/2018

Certification # E210-4E32-A13B

Copyright 1943



This Certified Sanborn Map combines the following sheets.
Outlined areas indicate map sheets within the collection.

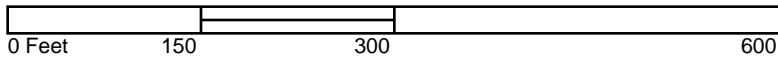

Volume 1, Sheet 5

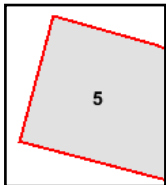

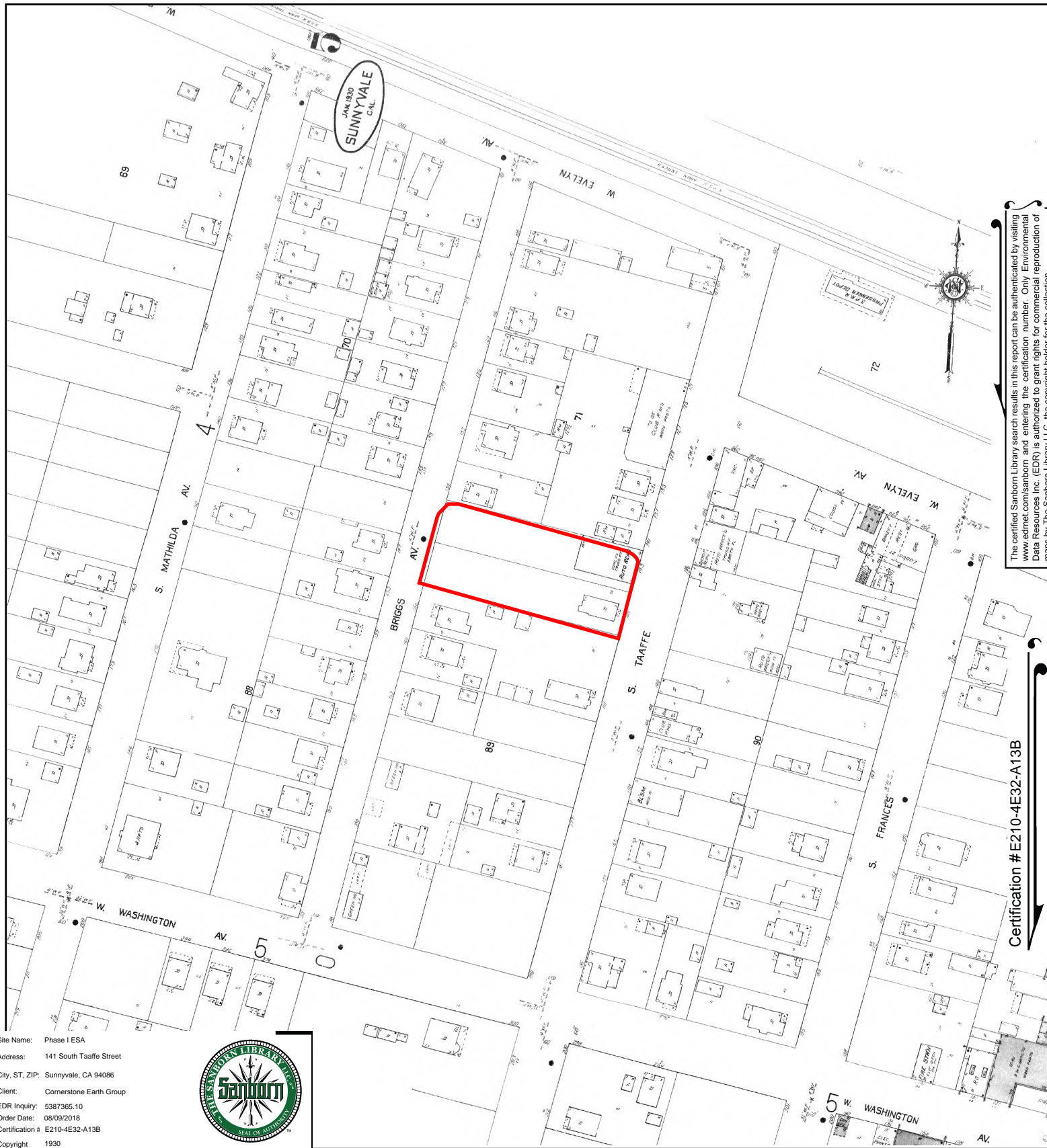

The certified Sanborn Library search results in this report can be authenticated by visiting www.edrnet.com/sanborn and entering the certification number. Only Environmental Data Resources Inc. (EDR) is authorized to grant rights for commercial reproduction of maps by The Sanborn Library LLC, the copyright holder for the collection.

Certification #E210-4E32-A13B

Site Name: Phase I ESA
 Address: 141 South Taaffe Street
 City, ST, ZIP: Sunnyvale, CA 94086
 Client: Cornerstone Earth Group
 EDR Inquiry: 5387365.10
 Order Date: 08/09/2018
 Certification #: E210-4E32-A13B
 Copyright: 1930



This Certified Sanborn Map combines the following sheets.
 Outlined areas indicate map sheets within the collection.

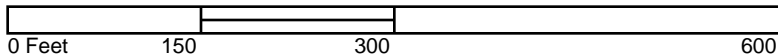

Volume 1, Sheet 5

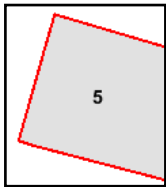

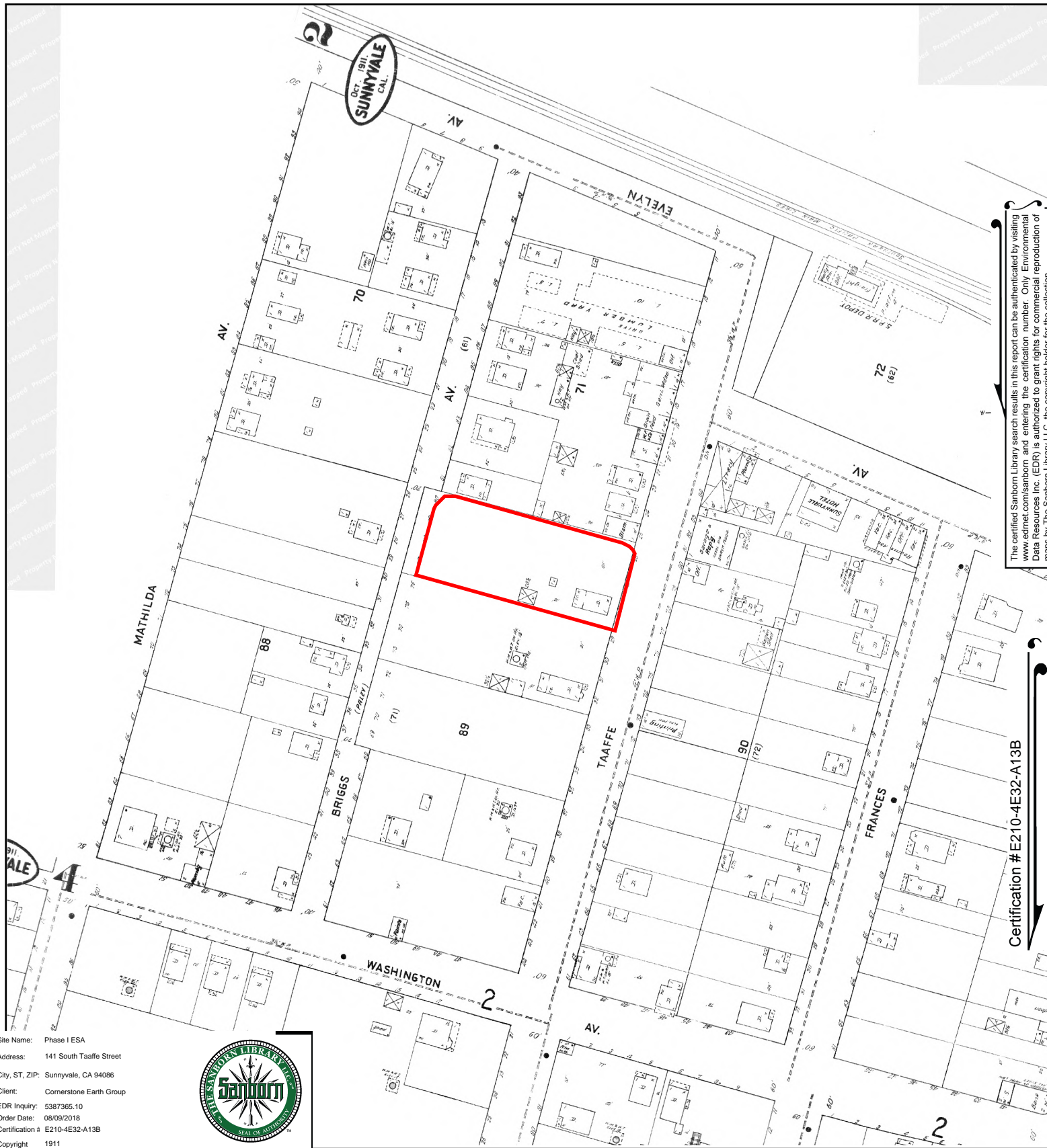

The certified Sanborn Library search results in this report can be authenticated by visiting www.edrnet.com/sanborn and entering the certification number. Only Environmental Data Resources Inc. (EDR) is authorized to grant rights for commercial reproduction of maps by The Sanborn Library LLC, the copyright holder for the collection.

Certification #E210-4E32-A13B

Site Name: Phase I ESA
 Address: 141 South Taaffe Street
 City, ST, ZIP: Sunnyvale, CA 94086
 Client: Cornerstone Earth Group
 EDR Inquiry: 5387365.10
 Order Date: 08/09/2018
 Certification #: E210-4E32-A13B
 Copyright: 1911



This Certified Sanborn Map combines the following sheets.
 Outlined areas indicate map sheets within the collection.

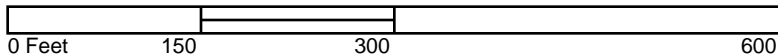

Volume 1, Sheet 2

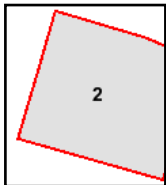

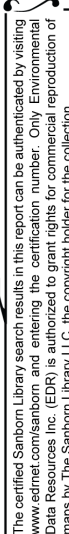

Certification # E210-4E32-A13B

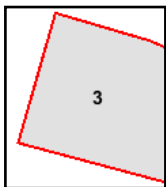

Volume 1, Sheet 3

