

February 23, 2006

Ms. Karen Ruggels
KLR Planning
720 Camino de la Riena, Suite 316
San Diego, California 92108

Re: Draft Report for Archaeological Study of the Stone Creek Project, City of San Diego,
California

Dear Ms. Ruggels,

This letter report describes the results of a cultural resource study conducted by ASM Affiliates, Inc. (ASM) for the Stone Creek Project, located in the City of San Diego, California. This report describes the results of records searches conducted at the South Coastal Information Center (SCIC) and San Diego Museum of Man and a field survey of the property. While records search information identified two previously recorded archaeological sites located in the vicinity, the project was negative in that no cultural resources were identified within the property due to a high level of modern disturbance.

Project Description

The Stone Creek Project is located within the City of San Diego on the Del Mar and Poway USGS quadrangles, in Township 15S, Range 3W, Sections 1 and 6 on the Del Mar quadrangle and Township 15S, Range 2W, Section 6 on the Poway quadrangle. The project is located adjacent to an existing stone quarry; mining has disturbed the entire project area. The majority of the project has been impacted and was therefore subjected to purposive survey; with the lesser-disturbed areas (including the slopes) being surveyed on foot at 15-m intervals and the highly disturbed areas receiving only cursory examination.

Records Search Results

ASM conducted a records search for the project area and a one-mile radius surrounding it at the South Coastal Information Center on February 7 and 8, 2006 and at the San Diego Museum of Man on February 17, 2006 (Appendix A). The searches included a review of

maps and files to identify any previously recorded sites located within the project area of potential effect (APE). Two sites recorded by Malcolm Rogers in the early twentieth century may extend into the project area. Rogers recorded SDM-W-155 and SDM-W-196 as covering large areas in the region but did not provide definitive mapping of the limits of these sites. SDM-W-155 encompasses a 20-mile² area, which covers the present communities of Linda Vista, Clairemont, University City, Kearny Mesa and Miramar. Hedges (1980) noted the boundaries of this site as being Mission Valley on the south, Mission Bay and Rose Canyon on the west and north, Carroll Canyon on the north, and Murphy Canyon on the east. SDM-W-196 was recorded as a number of small campsites extending from Carroll Canyon, north to Black Mountain, between Carroll and Los Penasquitos canyons. Rogers recorded these sites prior to the onslaught of development in San Diego County and it is likely that little evidence of them remains; no evidence of either site was identified during ASM's survey of the Stone Creek project area. The results of the records search are shown in Table 1.

Table 1. Records Search Results

Site Number	Site Type	Location in Relation to Project	Recorder/Year Recorded	Notes
SDM-W-155	Habitation area	May cross into project area	Rogers/n.d.	Noted as a 20-mile ² area used for highland winter camps, includes 13 loci
SDM-W-196	Temporary habitation	May cross into project area	Rogers/n.d.	Includes area from Carroll Canyon to Black Mountain
SDM-W-3479 C	Isolate	Outside of project	Hunter and Robbins Wade/1984	Core
SDM-W-3479 D	Isolate	Outside of project	Hunter and Robbins Wade/1984	Scraper
SDM-W-3479 E	Isolate	Outside of project	Hunter and Robbins Wade/1984	Scraper
SDM-W-3479 F	Isolate	Outside of project	Hunter and Robbins Wade/1984	Flake
SDM-W-3479 G	Isolate	Outside of project	Hunter and Robbins Wade/1984	Debitage
SDM-W-6350	Temporary habitation	Outside of project	James, Glenn, and Cooley/1994	Noted as not eligible for National Register
SDM-W-6351	Lithic scatter	Outside of project	James and Pignuolo/1994	Noted as not eligible for National Register
SDM-W-7735	Isolate	Outside of project	Robbins-Wade/2003	Core
SDM-W-7736	Isolate	Outside of project	Robbins-Wade/2003	Core
SDI-1076	Lithic scatter	Outside of project	Crabtree and King/1960	
SDI-6945H/SDM-W-2103	Structural remains	Outside of project	RECON/1979	Adobe bricks and trash scatter
SDI-9702 A, B	Temporary habitation	Outside of project	Thesken/1983	Shell scatters
SDI-11711	Not a site	Outside of project	Mooney/1990	Modern flintknapping area used by archaeologists, not a site

Site Number	Site Type	Location in Relation to Project	Recorder/Year Recorded	Notes
SDI-12203/H/ SDM-W-6736	Historic homestead	Outside of project	Gallegos et al./1995	Tested in 1992, now destroyed
SDI-13800	Temporary habitation	Outside of project	James, Glenn, and Cooley/1994	Noted as not eligible for National Register
SDI-13820	Lithic scatter	Outside of project	James and Pignuolo/1994	Two flakes and one core
SDI-15608/ P-37-018429	Railroad track	Outside of project	Giacomini/2000	Miramar railroad spur line
SDI-I-23	Isolate	Outside of project	Muranaka/1984	Isolated flake
SDI-I-24	Isolate	Outside of project	Muranaka/1984	Isolated flake
SDI-I-82	Isolate	Outside of project	Hunter and Robbins Wade/1984	Core
SDI-I-83	Isolate	Outside of project	Hunter and Robbins Wade/1984	Scraper
SDI-I-84	Isolate	Outside of project	Hunter and Robbins Wade/1984	Scraper
SDI-I-85	Isolate	Outside of project	Hunter and Robbins Wade/1984	Flake
SDI-I-86	Isolate	Outside of project	Hunter and Robbins Wade/1984	Flake/debitage
SDI-14738	Historic landscaping feature and trash scatter	Outside of project	Briggs and Cooley/1998	Historic red brick structure with trash scatter
P-37-016201	Redeposited prehistoric and historic cultural material	Outside of project	Briggs and Cooley/1998	Identified during monitoring in fill soils
P-37-024291	Isolate	Outside of project	EDAW/2001	Cobble core
P-37-024934	Isolate	Outside of project	Robbins Wade/2003	Cobble core
P-37-024935	Isolate	Outside of project	Robbins Wade/2003	Cobble core

41 archaeological studies have been conducted within a one-mile radius of the project. Of these, four have taken place in areas adjacent to the current project's boundaries. These include: Schaefer 1994 (negative), City of San Diego 1992 (positive), RECON 1979 (positive), and Crotteau 1984 (negative).

A review of historic maps on file at SCIC identified one historic structure on the 1930 La Jolla 1:62,500-scale quadrangle; this structure was not relocated during ASM's survey and is presumed destroyed. A search of the GeoFinder database, which reviews the National and California registers, California State Landmarks, California Points of Historic Interest and other property lists identified two historic structures within a one-mile radius of the project. 7501 Miramar Avenue is a California ranch style house constructed in 1950. 4958 Marlborough Drive, the Robb/Rotta House, is a Spanish Eclectic/Hacienda style private residence (ca. 1930). Neither of these properties is located within the project area.

Management Recommendations

No cultural resources were identified as a result of a pedestrian survey of the project area. Two previously recorded sites documented by Rogers may or may not fall within the project area; no evidence of either site was identified by ASM's survey. The entire project area has been extensively impacted by mining operations and residential development in the area. As such, no further cultural resource studies of the Stone Creek project area are required.

If you have any questions regarding the results of this study, please do not hesitate to contact me.

Sincerely,

A handwritten signature in black ink, appearing to read 'John R. Cook', with a stylized flourish at the end.

John R. Cook, RPA
President

Attachments: Figure 1. Project Vicinity Map
Figure 2. Project Location Map
Appendix A: Confidential Records Search Cover Sheets



Figure 1. Project Vicinity Map

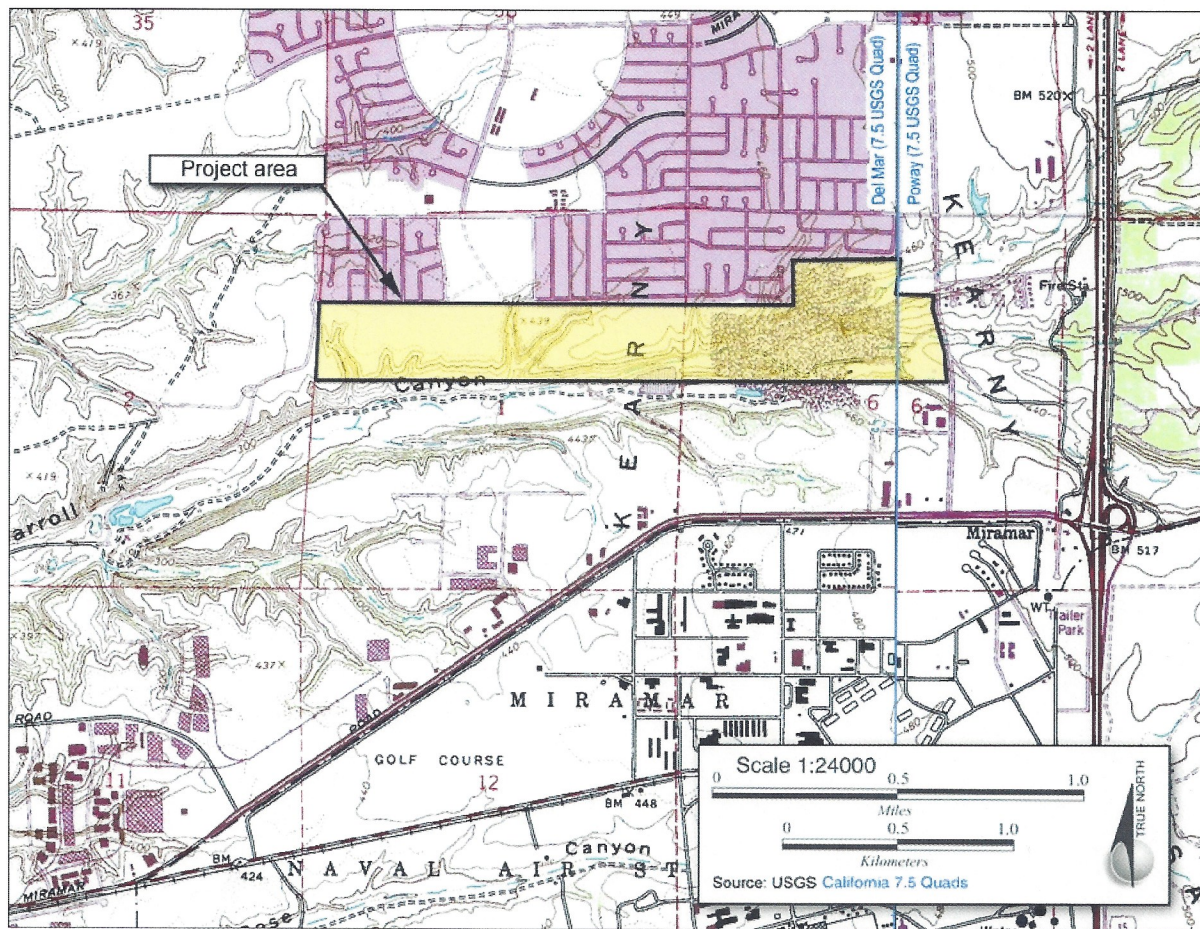

Figure 2. Project Location Map

Appendix A: Confidential Records Search Results

CALIFORNIA HISTORICAL RESOURCES INFORMATION SYSTEM SITE FILES RECORD SEARCH

Company: ASM
Company Representative: Michelle Dalope
Date of Request: 2/7/2006
Date Request Received: 2/7/2006
Project Identification: Stoney Creek Project
Search Radius: 1 mile

Archaeological Site Location(s) check: SM

Date: 2/8/2006

Archaeological (CA-SDI) and Primary (P-37) site maps have been reviewed. All sites within the project boundaries and the specified radius of the project area have been plotted. Copies of the site record forms have been included for all recorded sites.

Bibliographic Materials check: SM

Date: 2/8/2006

Project boundary maps have been reviewed. The bibliographic materials for reports within the project boundaries and within the specified radius of the project area have been included.

Historic Map(s) check: MO

Date: 2/7/2006

The historic maps on file at the South Coastal Information Center have been reviewed, and copies have been included.

Historic Resources check: MO

Date: 2/7/2006

A map generated from Geofinder, an historic database and mapping program, has been included.

HOURS: 4

COPIES: 140

RUSH: No

This is not an invoice. Please pay from the monthly Billing Statement.

San Diego Museum of Man

REPORT ON ARCHAEOLOGICAL SITE FILES RECORD SEARCH

Source of Request: ASM Affiliates - Michelle Dalope
Name of Project: Stone Creek Project
Date of Request: February 15, 2006
Date Request Received: February 16, 2006

The Record Search for the above referenced project has been completed. Archaeological site file information is enclosed for the following sites located within or in the vicinity of the project area:

W - 155, all of Kearny Mesa	W - 6350
(W - 155 Locus 13)	W - 6351
W - 196	W - 6736
W - 2103	W - 7735
W - 3479 A-G	W - 7736

The Museum holds collections for the following sites:

W - 155
W - 196

Bibliographic information is enclosed for the following reports on archaeological environmental impact studies conducted within or in the vicinity of the project area:

EIS - 203	EIS - 1037
EIS - 275	EIS - 1257
EIS - 481	EIS - 1404
EIS - 769	EIS - 1420

This Record Search is based only on information contained in the files of the San Diego Museum of Man. Archaeological site records and/or environmental impact studies pertaining to the project area may exist in other repositories.

Record Search prepared by:

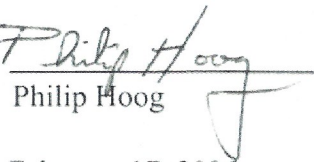
Philip Hoog

Date of Record Search: February 17, 2006

1350 El Prado, Balboa Park, San Diego, California 92101 619/239-2001

An educational, non-profit corporation founded in 1915
collecting for posterity and displaying the life and history of man

