

Lorelei H. Oviatt, AICP, Director  
2700 "M" Street, Suite 450  
Bakersfield, CA 93301  
Phone: (661) 862-8800  
Fax: (661) 862-8801 TTY Relay 1-800-735-2929  
Email: [dsa@co.kern.ca.us](mailto:dsa@co.kern.ca.us)  
Web Address: <http://pcd.kerndsa.com/>



**PLANNING AND NATURAL  
RESOURCES DEPARTMENT**

Planning  
Community Development  
Administrative Operations

**NOTICE OF PREPARATION**

**DATE:** June 5, 2020

**To:** See Attached Mailing List

**FROM:** Kern County Planning and Natural  
Resources Department  
Attn: Janice Mayes  
2700 "M" Street, Suite 100  
Bakersfield, CA 93301  
(661) 862-8793;  
[mayesj@kerncounty.com](mailto:mayesj@kerncounty.com)

**SUBJECT: NOTICE OF PREPARATION OF A DRAFT SUPPLEMENTAL ENVIRONMENTAL  
IMPACT REPORT (SCH #2004111015) – Shafter/Wasco Compost and Waste  
Diversion Project, by Kern County Public Works Department (PP20404)**

The Kern County Planning and Natural Resources Department as Lead Agency (per CEQA Guidelines Section 15050) has determined that a Supplemental Environmental Impact Report (SEIR) (per CEQA Guidelines Section 15161) is necessary for the project identified below. The Planning and Natural Resources Department solicits the views of your agency as to the scope and content of the environmental information which is germane to your agency's statutory responsibilities in connection with the proposed project. Your agency will need to use the SEIR prepared by our agency when considering your permit or other approval of projects.

You are invited to view the NOP and submit written comments regarding this project should you wish to do so. Due to the limits mandated by State law, your response must be received by **July 6, 2020 at 5pm**. Comments can be submitted to the Kern County Planning and Natural Resources Department at the address shown above. A Scoping meeting that will be held on Friday, **June 26, 2020 at 1:30pm**. In compliance with the Governor's Executive Order, the California Department of Public Health's guidelines on gatherings regarding COVID-19, and Kern County Local Emergency Declaration, the scoping meeting required by the CEQA Guidelines will be conducted online. Closed captioning in Spanish will be available to attendees. Instructions for accessing the virtual scoping meeting will be available three (3) days before the virtual scoping meeting on the Kern County Planning and Natural Resources website at <https://kernplanning.com>.

Comments on the scope and content of the NOP should be sent to [mayesj@kerncounty.com](mailto:mayesj@kerncounty.com).

**PROJECT TITLE:** Shafter-Wasco Composting and Waste Diversion Project by Kern County Public Works Department. Modification to CUP No. 1, Map #78; and General Plan Amendment No. 10, Map #78 (PP20404).

**PROJECT LOCATION:** The project site is located at 17621 Scofield Avenue, Shafter, CA 93263, one mile north of Lerdo Highway, in an unincorporated area of Kern County on Assessor's Parcel Numbers (APNs) 088-100-38, 088-100-40, and 088-100-08. The site is located in Section 8 of Township 28 South, Range 24 East, Mount Diablo Base & Meridian (MDB&M).

**PROJECT DESCRIPTION:** The project includes a request for land use entitlements necessary to facilitate the operation of a covered aerated static pile composting facility and expansion of self-haul transfer and processing activities within the current landfill permitted facility boundary. The project includes the increase to the permitted facility boundary and hours for the receipt of waste and facility operating hours.

The major components of the Project are:

- (A) General Plan Amendment and Appendix E Map Amendment from 3.4.1 to 3.7 for 20 acres for a compost facility and from 8.1 to 3.4.1 for 50.21 acres for landfill buffer;
- (B) Modify existing CUP No. 1, Map 78 to include additional buffer lands and increase permitted facility boundary from 357.48 acres to 407.69 acres to include 50.21 acres of landfill buffer property and designate 20 acres for the compost facility;
- (C) Revise existing Solid Waste Facility Permit to increase permitted facility boundary to 407.69 acres, increase composting design capacity from zero tons per year to 100,000 tons per year; and increase hours for the receipt of waste and facility operating hours;
- (D) Apply for Waste Discharge Requirements for Composting Operations to construct and operate a Tier II designed compost facility; and
- (E) Apply for Authority to Construct for construction and operation of a 100,000 tons per year compost facility.

Document can be viewed online at: <https://kernplanning.com/planning/notices-of-preparation/>

Signature: \_\_\_\_\_

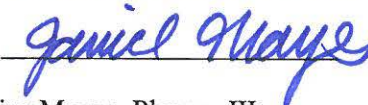

Name: Janice Mayes, Planner III

**EIR 04-19**  
**PWD Shafter/Wasco Composting**  
**SEIR**

California Regional Water Quality  
Control Board/Central Valley Region  
1685 E Street  
Fresno, CA 93706-2020^

City of Arvin  
P.O. Box 548  
Arvin, CA 93203

Bakersfield City Planning Dept  
1715 Chester Avenue  
Bakersfield, CA 93301

Bakersfield City Public Works Dept  
1501 Truxtun Avenue  
Bakersfield, CA 93301

California City Planning Dept  
21000 Hacienda Blvd.  
California City, CA 93515

Delano City Planning Dept  
P.O. Box 3010  
Delano, CA 93216

City of Maricopa  
P.O. Box 548  
Maricopa, CA 93252

City of McFarland  
401 West Kern Avenue  
McFarland, CA 93250

City of Ridgecrest  
100 West California Avenue  
Ridgecrest, CA 93555

City of Shafter  
336 Pacific Avenue  
Shafter, CA 93263

City of Taft  
Planning & Building  
209 East Kern Street  
Taft, CA 93268

City of Tehachapi  
Attn: John Schlosser  
115 South Robinson Street  
Tehachapi, CA 93561-1722

City of Wasco  
764 E Street  
Wasco, CA 93280

Inyo County Planning Dept  
P.O. Drawer "L"  
Independence, CA 93526

Kings County Planning Agency  
1400 West Lacey Blvd, Bldg 6  
Hanford, CA 93230

Los Angeles Co Reg Planning Dept  
320 West Temple Street  
Los Angeles, CA 90012

San Bernardino Co Planning Dept  
385 North Arrowhead Avenue, 1st Floor  
San Bernardino, CA 92415-0182

San Luis Obispo Co Planning Dept  
Planning and Building  
976 Osos Street  
San Luis Obispo, CA 93408

Santa Barbara Co Resource Mgt Dept  
123 East Anapamu Street  
Santa Barbara, CA 93101

Tulare County Planning & Dev Dept  
5961 South Mooney Boulevard  
Visalia, CA 93291

Ventura County RMA Planning Div  
800 South Victoria Avenue, L1740  
Ventura, CA 93009-1740

U.S. Bureau of Land Management  
Caliente/Bakersfield  
3801 Pegasus Drive  
Bakersfield, CA 93308-6837

U. S. Fish & Wildlife Service  
Division of Ecological Services  
2800 Cottage Way #W-2605  
Sacramento, CA 95825-1846

North West Kern Resource Cons Dist  
5080 California Avenue, Suite 150  
Bakersfield, CA 93309

Environmental Protection Agency  
Region IX Office  
75 Hawthorn Street  
San Francisco, CA 94105

U.S. Dept of Agriculture/NRCS  
5080 California Avenue, Ste 150  
Bakersfield, CA 93309-0711

U.S. Postal Service  
Address Management Systems  
28201 Franklin Parkway  
Santa Clarita, CA 91383-9321

State Air Resources Board  
Stationary Resource Division  
P.O. Box 2815  
Sacramento, CA 95812

So. San Joaquin Valley Arch Info Ctr  
California State University of Bkfd  
9001 Stockdale Highway  
Bakersfield, CA 93311

Caltrans/Dist 6  
Planning/Land Bank Bldg.  
P.O. Box 12616  
Fresno, CA 93778

State Clearinghouse  
Office of Planning and Research  
1400 - 10th Street, Room 222  
Sacramento, CA 95814

State Dept of Conservation  
Director's Office  
801 "K" Street, MS 24-01  
Sacramento, CA 95814-3528

State Dept of Conservation  
Geologic Energy Management Division  
4800 Stockdale Highway, Ste 108  
Bakersfield, CA 93309

State Dept of Conservation  
Office of Land Conservation  
801 "K" Street, MS 18-01  
Sacramento, CA 95814

State Dept of Conservation  
Div Recycling Cert. Sec.  
801 "K" Street, MS 19-01  
Sacramento, CA 95814

California State University  
Bakersfield - Library  
9001 Stockdale Highway  
Bakersfield, CA 93309

California Fish & Wildlife  
1234 East Shaw Avenue  
Fresno, CA 93710

California Highway Patrol  
Planning & Analysis Division  
P.O. Box 942898  
Sacramento, CA 94298-0001

Integrated Waste Management  
P.O. Box 4025, MS #15  
Sacramento, CA 95812-4025

California Regional Water Quality  
Control Board/Central Valley Region  
1685 E Street  
Fresno, CA 93706-2020

CalRecycle  
Dept of Resources, Recycling, and  
Recovery  
1001 "I" Street  
Sacramento, CA 95812

Kern County  
Agriculture Department

Kern County Administrative Officer

Kern County Public Works Department/  
Building & Development/Floodplain

Kern County Public Works Department/  
Building & Development/Survey

Kern County  
Env Health Services Department

Kern County Fire Dept  
Cary Wright, Fire Marshall

Kern County Library/Beale  
Local History Room

Kern County Library/Beale  
Andie Sullivan

Kern County Library  
Shafter Branch

Kern County Library  
Wasco Branch  
1102 Seventh Street  
Wasco. CA 93280

Kern County Sheriff's Dept  
Administration

Kern County Public Works Department/  
Building & Development/Development  
Review

Kern County Public Works  
Department/Operations &  
Maintenance/Regulatory Monitoring &  
Reporting

Wasco Union High School Dist  
P.O. Box 250  
Wasco, CA 93280

Sierra Club/Kern Kaweah Chapter  
P.O. Box 3357  
Bakersfield, CA 93385

Kern County Superintendent of Schools  
Attention School District Facility Services  
1300 - 17th Street  
Bakersfield, CA 93301

KernCOG  
1401 19th Street - Suite 300  
Bakersfield, CA 93301

Semi Tropic Water Storage Dist  
P.O. Box Z  
Wasco, CA 93280



Kern County Water Agency  
P.O. Box 58  
Bakersfield, CA 93302-0058

Shafter Rec & Parks Dist  
700 East Tulare Avenue  
Shafter, CA 93263

San Joaquin Valley  
Air Pollution Control District  
1990 East Gettysburg Avenue  
Fresno, CA 93726

Kern Mosquito Abatement Dist  
4705 Allen Road  
Bakersfield, CA 93314

Adams, Broadwell, Joseph & Cardozo  
Attention: Janet M. Laurain  
601 Gateway Boulevard, Suite 1000  
South San Francisco, CA 94080

AT&T California  
OSP Engineering/Right-of-Way  
4901 Ashe Road  
Bakersfield, CA 93313

Kern Audubon Society  
Attn: Frank Bedard, Chairman  
4124 Chardonnay Drive  
Bakersfield, CA 93306

Center on Race, Poverty  
& the Environment  
Attn: Marissa Alexander  
1999 Harrison Street – Suite 650  
San Francisco, CA 94612

Center on Race, Poverty  
& the Environmental/  
CA Rural Legal Assistance Foundation  
1012 Jefferson Street  
Delano, CA 93215

Defenders of Wildlife/  
Kim Delfino, California Dir  
980 - 9th Street, Suite 1730  
Sacramento, CA 95814

California Farm Bureau  
2300 River Plaza Drive, NRED  
Sacramento, CA 95833

Native American Heritage Council  
of Kern County  
Attn: Gene Albitre  
3401 Aslin Street  
Bakersfield, CA 93312

Pacific Gas & Electric Co  
Land Projects  
650 "O" Street, First Floor  
Fresno, CA 93760-0001

Sierra Club/Kern Kaweah Chapter  
P.O. Box 3357  
Bakersfield, CA 93385

Southern California Gas Co  
35118 McMurtrey Avenue  
Bakersfield, CA 93308-9477

Southern California Gas Co  
Transportation Dept  
9400 Oakdale Avenue  
Chatsworth, CA 91313-6511

Chumash Council of Bakersfield  
2421 "O" Street  
Bakersfield, CA 93301-2441

David Laughing Horse Robinson  
P.O. Box 20849  
Bakersfield, CA 93390

Kern Valley Indian Council  
Attn: Robert Robinson, Chairperson  
P.O. Box 401  
Weldon, CA 93283

Kern Valley Indian Council  
Historic Preservation Office  
P.O. Box 401  
Weldon, CA 93283

Santa Rosa Rancheria  
Ruben Barrios, Chairperson  
P.O. Box 8  
Lemoore, CA 93245

Tejon Indian Tribe  
Kathy Morgan, Chairperson  
1731 Hasti-acres Drive, Suite 108  
Bakersfield, CA 93309

Kitanemuk & Yowlumne Tejon Indians  
Chairperson  
115 Radio Street  
Bakersfield, CA 93305

Tubatulabals of Kern County  
Attn: Robert Gomez, Chairperson  
P.O. Box 226  
Lake Isabella, CA 93240

Tule River Indian Tribe  
Neal Peyron, Chairperson  
P.O. Box 589  
Porterville, CA 93258

San Fernando Band of Mission Indians  
Attn: John Valenzuela, Chairperson  
P.O. Box 221838  
Newhall, CA 91322

LIUNA  
Attn: Danny Zaragoza  
2201 "H" Street  
Bakersfield, CA 93301

Lozeau Drury LLP  
1939 Harrison Street, Suite 150  
Oakland, CA 94612

State Dept of Public Health  
Drinking Water Field Ops  
265 W Bullard Avenue, Ste 101  
Fresno, CA 93704-1755

Lorelei H. Oviatt, AICP, Director  
2700 "M" Street, Suite 100  
Bakersfield, CA 93301-2323  
Phone: (661) 862-8600  
Fax: (661) 862-8601 TTY Relay 1-800-735-2929  
Email: [planning@kerncounty.com](mailto:planning@kerncounty.com)  
Web Address: <http://kernplanning.com/>



**PLANNING AND NATURAL  
RESOURCES DEPARTMENT**

Planning  
Community Development  
Administrative Operations

**DATE:** June 5, 2020

**TO:** Surrounding Property Owners within  
1,000 Feet of Project Boundary; and,  
Interested Parties

**FROM:** Kern County Planning and Natural  
Resources Department  
Atten: Janice Mayes  
2700 "M" Street, Suite 100  
Bakersfield, CA 93301  
(661) 862-8793; [mayesj@kerncounty.com](mailto:mayesj@kerncounty.com)

**RE: NOTICE OF PREPARATION OF A SUPPLEMENTAL ENVIRONMENTAL IMPACT  
REPORT (SCH #2004111015) – Shafter/Wasco Compost and Waste Diversion Project, by  
Kern County Public Works Department (PP20404)**

Dear Sir or Madam:

The Kern County Planning and Natural Resources Department has determined that preparation of a Supplemental Environmental Impact Report (SEIR) is necessary for the project identified below. The purpose of this letter is to notify surrounding property owners within 1,000 feet of the project boundaries of this determination. A copy of the Notice of Preparation (NOP) prepared for this project is available for viewing at the following Kern County website: <https://kernplanning.com/planning/notices-of-preparation/>. The purpose of the NOP is to describe the proposed project, specify the project location, and to identify the potential environmental impacts of the project so that Responsible Agencies and interested persons can provide a meaningful response related to potential environmental concerns that should be analyzed in the SEIR.

You are invited to view the NOP and submit written comments regarding this project should you wish to do so. Due to the limits mandated by State law, your response must be received by **July 6, 2020 at 5pm.** Comments can be submitted to the Kern County Planning and Natural Resources Department at the address shown above. A Scoping Meeting is scheduled for Friday, **June 26, 2020 at 1:30 pm.** In compliance with the Governor's Executive Order, the California Department of Public Health's guidelines on gatherings regarding COVID-19, and Kern County Local Emergency Declaration, the scoping meeting required by the CEQA Guidelines will be conducted online. Closed captioning in Spanish will be available to attendees. Instructions for accessing the virtual scoping meeting will be available three (3) days before the virtual scoping meeting on the Kern County Planning and Natural Resources website at <https://kernplanning.com>.

Comments on the scope and content of the NOP should be sent to [mayesj@kerncounty.com](mailto:mayesj@kerncounty.com).

Please be advised that any comments received after the dates listed above will still be included in the public record for this project and made available to decision makers when this project is scheduled for consideration at a public hearing. Please also be advised that you will receive an additional notice in the mail once a public hearing date is scheduled for this project. You will also be provided additional opportunities to submit comments at that time.

**PROJECT TITLE:** Shafter-Wasco Composting and Waste Diversion Project by Kern County Public Works Department. Modification to CUP No. 1, Map 78; General Plan Amendment No. 10, Map #78 (PP20404).

**PROJECT LOCATION:** The project site is located at 17621 Scofield Avenue, Shafter, CA 93263, one mile north of Lerdo Highway, in an unincorporated area of Kern County on Assessor's Parcel Numbers (APNs) 088-100-38, 088-100-40, and 088-100-08. The site is located in Section 8 of Township 28 South, Range 24 East, Mount Diablo Base & Meridian (MDB&M).

**PROJECT DESCRIPTION:** The project includes a request for land use entitlements necessary to facilitate the operation of a covered aerated static pile composting facility and expansion of self-haul transfer and processing activities within the current landfill permitted facility boundary. The project includes the increase to the permitted facility boundary and hours for the receipt of waste and facility operating hours.

The major components of the Project are:

(A) General Plan Amendment and Appendix E Map Amendment from 3.4.1 to 3.7 for 20 acres for a compost facility and from 8.1 to 3.4.1 for 50.21 acres for landfill buffer;

(B) Modify existing CUP No. 1, Map 78 to include additional buffer lands and increase permitted facility boundary from 357.48 acres to 407.69 acres to include 50.21 acres of landfill buffer property and designate 20 acres for the compost facility;

(C) Revise existing Solid Waste Facility Permit to increase permitted facility boundary to 407.69 acres, increase composting design capacity from zero tons per year to 100,000 tons per year; and increase hours for the receipt of waste and facility operating hours;

(D) Apply for Waste Discharge Requirements for Composting Operations to construct and operate a Tier II designed compost facility; and

(E) Apply for Authority to Construct for construction and operation of a 100,000 tons per year compost facility.

Document can be viewed online at: <https://kernplanning.com/planning/notices-of-preparation/>

Sincerely,



Janice Mayes, Planner III  
Advanced Planning Division

Attachment: Vicinity Map showing project boundary



**GPA No. 10,  
CUP Mod No. 1,  
Map No. 78**

**Vicinity Map**

**Kern County Planning and  
Natural Resources**

-  **SITE**
-  **INTERSTATE**
-  **NAMED HWY**
-  **STATE HWY**
-  **Arterials**
-  **Township/Range**
-  **Sections**
-  **City Limits**

APN: 088-100-08 & 088-100-38  
& 088-100-40

Sec. 5 & 8- T28S/R24E

Created on: 6/1/2020

0 2,500 5,000 7,500 10,000 Feet



**Kern County  
Planning & Natural  
Resources Department**

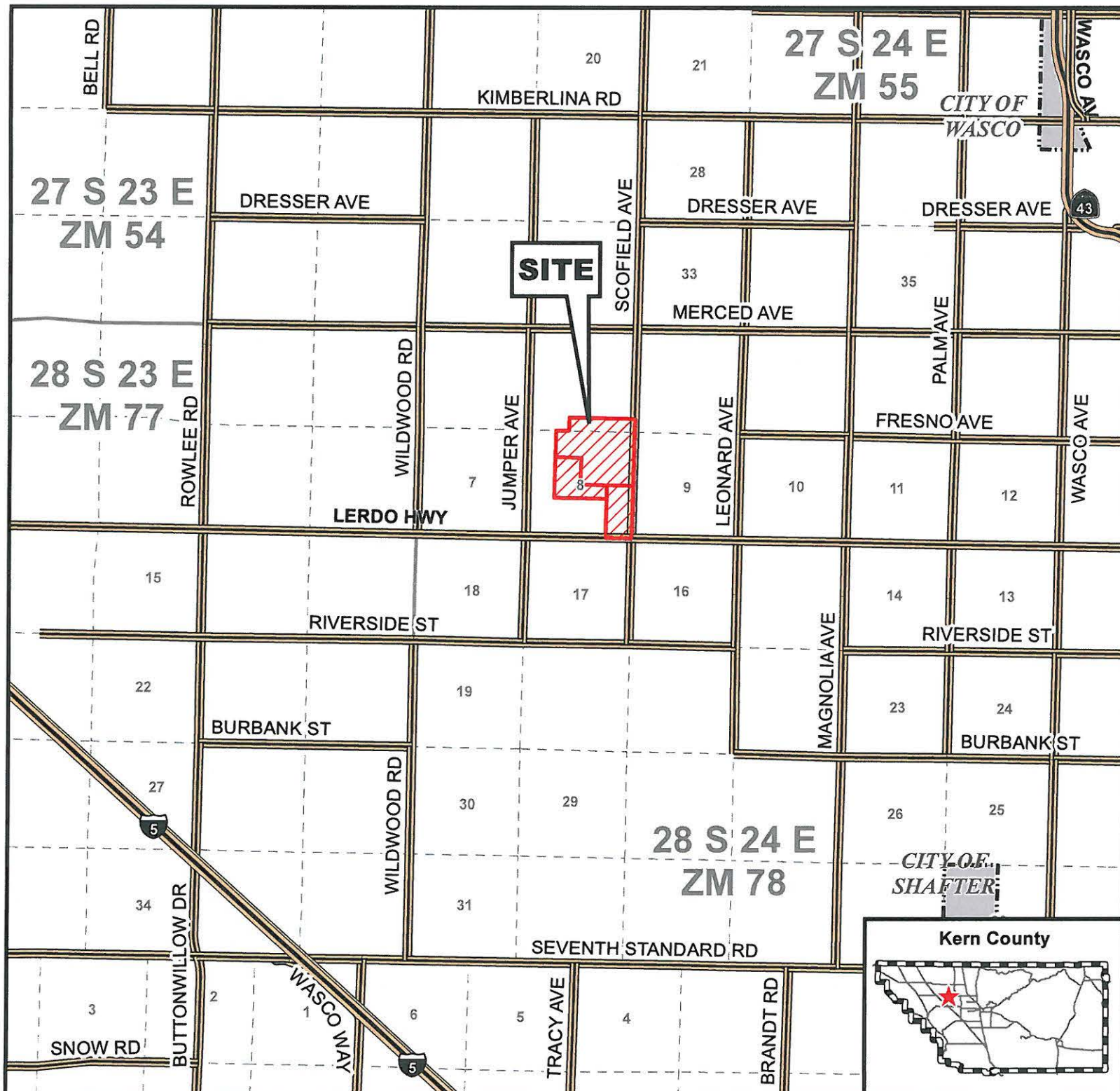



I:\Planning\WORKGRPS\WP\LABELS\  
Map 78, GPA10, CUP1, EIR 04-  
19.docxMap 78, GPA 10, CUP 1,  
EIR 04-19  
cp06/02/20

088 100 41 00 8  
BALLENLEE BROTHERS FARMS  
17679 JUMPER AV  
SHAFTER CA 93263

088 100 19 00 5  
BALLENLEE MARK P & LYNDIA  
17679 JUMPER AV  
SHAFTER CA 93263

088 030 16 00 6  
BLOEMER ESTATE LP  
4948 ENGLE RD  
BAKERSFIELD CA 93313-9707

088 100 28 00 1  
CALIFORNIA RESOURCES  
PETROLEUM CORPORATION  
27200 TOURNEY RD STE 315  
VALENCIA CA 91355-4990

088 130 22 00 2  
CALIFORNIA RESOURCES  
PETROLEUM CORPORATION  
PO BOX 22830  
BAKERSFIELD CA 93390-2830

088 090 10 00 6  
CAUZZA ALMONDS L P  
1600 CORN CAMP RD  
BUTTONWILLOW CA 93206

088 100 08 01 2                      site  
COUNTY OF KERN  
1115 TRUXTUN AV FLR 3  
BAKERSFIELD CA 93301

088 100 38 00 0                      **DUP**  
COUNTY OF KERN  
\*  
\*

088 030 17 01 8  
GHILARDUCCI SAMMY & DIANE  
FAMILY TRUST  
17138 PANADERO CT  
BAKERSFIELD CA 93314-8696

088 130 04 00 0  
KING & GARDINER FARMS LLC  
PO BOX 1200  
WASCO CA 93280-8100

088 090 01 01 9  
PIANTAGIONE BLOEMHOF DI  
MANDORLE  
PO BOX 4140  
SAN LUIS OBISPO CA 93403-4140

088 040 03 02 9  
REGENTS OF THE UNIVERSITY CA  
2199 ADDISON ST  
BERKELEY CA 94704-1153

088 020 18 01 8  
AJL ENTERPRISES  
PO BOX 8002  
WASCO CA 93280-8056

# INITIAL STUDY/NOTICE OF PREPARATION

---

of a Supplemental Environmental Impact Report  
to the Shafter-Wasco Sanitary Landfill Permit Revision Project (SCH No. 2004111015)

**Shafter-Wasco Composting and Waste Diversion Project**  
by Kern County Public Works Department

General Plan Amendment No. 10, Map 78  
Modification to Conditional Use Permit No. 1, Map 78  
Solid Waste Facility Permit Revision

(PP20404)

---

**Lead Agency:**



Kern County Planning and Natural Resources Department  
2700 M Street, Suite 100  
Bakersfield, CA 93301-2370

Contact:

Janice Mayes, Planner III  
(661) 862-8793; [mayesj@kerncounty.com](mailto:mayesj@kerncounty.com)

June 2020



## A. INTRODUCTION

This Notice of Preparation is being circulated pursuant to Section 15087 of the California Environmental Quality Act (CEQA) Guidelines and serves to notify responsible agencies of the preparation of a Supplemental Environmental Impact Report (SEIR) to the Shafter-Wasco Sanitary Landfill Permit Revision Project (SCH #2004111015). The Supplemental EIR to modify the previously certified Shafter-Wasco Sanitary Landfill Permit Revision Project EIR is being prepared pursuant to Section 15163 of the CEQA Guidelines.

### **Previous Approvals**

The Shafter-Wasco Sanitary Landfill Permit Revision Project Environmental Impact Report (EIR) (SCH #2004111015) was certified by the Kern County Board of Supervisors on September 29, 2009 and included the following actions for the Shafter-Wasco RSLF:

- Amendment to the Kern County General Plan (GPA No. 8, Map 78) to have compatible and consistent general plan designation and zone district for the site; amendment to the Appendix E Map to show revised permitted facility boundary;
- Modification to Conditional Use Permit (CUP) to revise the permitted facility boundary, include the addition of land uses ancillary to landfill activities, allow a vertical expansion of the permitted disposal area, increase the final height and permitted disposal capacity of the waste footprint;
- Petition to exclude the landfill and additional acreage owned by the County from Agricultural Preserve No. 8;
- Revision to the solid waste facility permit to increase disposal capacity and lifespan by vertical expansion; relocation and expansion of the recycling/diversion area; and
- Issuance of revised Waste Discharge Requirements to include the change in permitted facility boundary, allow a vertical expansion of the permitted disposal area, and increase the final height and permitted disposal capacity of the waste footprint.

### **Proposed Modifications**

Since certification of the 2009 Shafter-Wasco Sanitary Landfill Permit Revision Project EIR, the California State Legislature has passed numerous statutes (Assembly Bill [AB] 341, AB 1594, AB 1826, and Senate Bill [SB] 1383) requiring the reduction of methane emissions resulting from landfill operations and the removal of organic materials from the disposal waste stream. CalRecycle has implemented regulations complimenting these statutes. As a result, the Kern County Public Works Department has evaluated existing solid waste management services provided and determined additional programs will require implementation to meet State and CalRecycle mandates. Additional programs to be implemented at the Shafter-Wasco RSLF include a 100,000 tons per year (TPY) composting operation and a self-haul recycling operation; both will require additional hours for ancillary site activities.

It should be noted that the Public Works Department is adjusting the management, processing, and handling method associated with the organic materials coming into the Shafter-Wasco RSLF with no increase in permitted maximum daily tonnage and permitted traffic (volume or flow pattern), nor permitted capacity. The Public Works Department is proposing to shift the organic material that is currently being disposed of in the landfill to the proposed compost facility and self-haul recycling operation for recovery, handling, processing, or composting.



However, the proposed Project constitutes a change to the previously analyzed Shafter-Wasco Recycling and Sanitary Landfill (RSLF) operations that will require a revision to the 2009 previously certified EIR because of a potential for new significant environmental effects or a substantial increase in the severity of previously identified effects. Therefore, as allowed for within CEQA Guidelines Section 15163, a Supplemental EIR will be prepared for the proposed Project. As provided for in CEQA Guidelines, a Supplemental EIR need only address those EIR topics that require, for the reason listed above, revisions to the original EIR to make the previous EIR adequate for the project as revised. Mitigation measures, as applicable, from the 2009 previously certified EIR will be incorporated into the proposed Project.

## **B. PROJECT DESCRIPTION**

### **1. PROJECT LOCATION**

The Shafter-Wasco Composting and Waste Diversion Project (proposed Project) site is in the unincorporated area of western Kern County, California. The Project is sited within the 407.69-acre Shafter-Wasco Recycling and Sanitary Landfill (RSLF) located at 17621 Scofield Avenue, Shafter, CA 93263, approximately eight miles west of the City of Shafter and nine miles northeast of the City of Wasco in an unincorporated area of Kern County (Figure 1, *Site Vicinity*). The Shafter-Wasco RSLF is accessible from Scofield Avenue, near Lerdo Highway, via the main entrance of the Shafter-Wasco RSLF. The Project site is bordered to the north, south, east, and west by agricultural lands. The nearest populated areas to the project site are the City of Shafter and the City of Wasco, approximately eight miles east and nine miles northeast, respectively, of the Shafter-Wasco RSLF permitted boundary.

The Shafter-Wasco RSLF is an existing class III municipal solid waste landfill owned by the County of Kern and operated by the Public Works Department. The Project site is identified as Kern County Assessor's Parcel Numbers (APNs) 088-100-38, 088-100-40, and 088-100-08, situated in Section 8 of Township 28 South, Range 24 East, Mount Diablo Base & Meridian (MDB&M) (Figure 2, *Assessor's Parcel Number Map*). The permitted facility boundary encompasses 357.48 acres of which 135 acres are permitted for disposal and approximately 92 acres contain the existing refuse footprint area (Figure 3, *Current Site Map*). The landfill consists of five modules total - one unlined module (Module 1), two lined modules (Modules 2 and 3) currently constructed, and two additional lined modules (Modules 4 and 5) planned for construction in the future.

### **PROJECT SITE HISTORY AND EXISTING OPERATIONS**

The Shafter-Wasco RSLF is an active public Class III municipal solid waste disposal facility, owned by the County of Kern and operated by the Public Works Department since July 1972, that serves an area of 2,075 square miles, including the cities of Shafter, Wasco, Delano, McFarland, Bakersfield (northwest region) and the unincorporated communities of Glennville, Lost Hills, Buttonwillow, and Rosedale. The landfill services the residential, commercial, and agricultural waste and recycling needs of the County of Kern. Current operations receive waste from Public Works Department owned and operated transfer stations, including but not limited to, Buttonwillow, Glennville, McFarland-Delano, and Roberts Lane.

Landfill property was purchased from Stockdale Development Corporation on December 20, 1971. Prior to the County's acquisition of the property, the parcel was open space and used as a landing strip for a crop-dusting service. The landfill opened in July 1972. From 1999 to 2004, 247 acres of buffer lands were acquired around the landfill to preclude incompatible development adjacent to the landfill and for the installation of any required environmental monitoring and control systems, drainage improvements, soil borrow areas, storm water diversion facilities, and diversion activities.





Existing permits for the landfill include a Solid Waste Facility Permit (No. 15-AA-0057) issued February 29, 2016 by the Kern County Public Health Services Department – Environmental Health Division and concurred with by the Department of Resources Recycling and Recovery (CalRecycle); Waste Discharge Order No. R5-2012-0011 adopted February 2, 2012 by the California Regional Water Quality Control Board – Central Valley Region (Water Board); Title V Permit to Operate S-3431 issued by the San Joaquin Valley Air Pollution Control District (APCD) and CUP No. 1, Map 78 approved September 29, 2009 by the Kern County Board of Supervisors.

The site is permitted to receive municipal solid waste, agricultural waste, construction and demolition waste, non-friable asbestos, industrial waste, compostable materials, dead animals, and inert debris. In 2019, the landfill received approximately 692 tons per day (TPD), with an average of 591 TPD of material being disposed and 101 TPD being diverted. The permitted maximum tonnage is 1,500 TPD for 300 days per calendar year with a maximum of 2,250 TPD for 15 days per quarter. The permitted traffic volume is 788 vehicles per day, with an average of 255 vehicles per day. Hours for the receipt of waste may occur seven days per week from 7:00 a.m. to 4:00 p.m. The estimated date the Shafter-Waco RSLF will reach permitted capacity is March 2055 per the 2019 Kern County Public Works Department Capacity Study. The closure date is an estimate subject to annual review based upon such factors as fill rate, waste settlement, enhanced diversion programs, regional growth rates, fluctuations in incoming tonnages, and regulatory requirements and, therefore, is different than what was stated in the previously certified 2009 Final EIR.

The Public Works Department operates several diversion programs. Materials designated for diversion include waste tires, white goods, scrap metal, wood waste (branches and lumber), inerts (concrete, asphalt, etc.), grass, leaves, manure, food waste, vegetative food waste, universal waste (cathode ray tubes, electronic devices), used motor oil, used oil filters, municipal recyclable materials (cardboard, plastics, glass, etc.), drywall, and product stewardship items (mattresses, carpet, etc.). Depending upon existing approvals and material types, materials are either stockpiled, loaded into trailers, or placed in roll-off bins. Storage, handling, and stockpiling activities for recyclable materials are conducted in a planned and controlled manner to minimize the risk of fire, health, and safety hazards, vector harborage, and public nuisances.

Current incoming organic feedstocks stockpiled, handled, processed, and transferred through the diversion area of the Shafter-Wasco RSLF include green material, food material, vegetative food material, organic waste, manure, and agricultural material. Organic feedstocks are stockpiled in individual designated areas and processed through various machinery to remove contamination (L3 Starscreen or trommel screeners) or processed for size reduction (chipping/grinding and tub grinder). Depending upon the material type and destination, material is then in turn placed back into a stockpile configuration and loaded at a later date for transport to an off-site regional composting facility, beneficially reused onsite, or other suitable end market. Materials may also be directly loaded for transport and removed from the site.

Self-haul vehicles entering the site are currently directed to the diversion area. Customers are directed to unload any targeted recyclable materials (as detailed above) into designated stockpiles. After depositing materials, customers are sent to the active face to dispose of their remaining load or waste is placed in a low-profile roll-off bin in the diversion area for Public Works Department staff to transport to the active face for disposal. Large commingled commercial and residential loads are not handled or processed by Public Works Department staff at the diversion area and are sent directly to the landfill for disposal.



## 2. PROJECT OVERVIEW

### Composting Operations

The proposed Project includes the construction and operation of a covered aerated static pile (CASP) forced aeration system, which would include positive or negative aeration infrastructure to push or pull air flow into the compost material during the active compost phase. Construction activities associated with the CASP system consists of improvements and construction of concrete bunkers with sidewalls, push walls, and aeration trenches; underground and aboveground piping; water trap and collection sumps; pump station manhole; electrical conduit; site preparation, earthwork, final grading, and drainage; control and monitoring building; 4 x 10,000 gallon aboveground storage tanks; pumps, controls, wiring, valves and meters; air supply compressor; and associated controls, valves, fittings, and bollards. Heavy, light-duty, and support equipment will complete earthwork needs, in general, consisting of mobilization/demobilization, excavation, backfilling, compaction, subgrade preparation, and trenching.

The Public Works Department may utilize an engineered membrane fabric cover technology or a biocover (such as 12 inches of finished compost or wood chips) to cover a compost pile. Feedstocks received would be temporarily stockpiled, processed through various machinery to remove contamination or reduce in size, and then placed in a pile to be composted. Water would be applied during compost pile construction to help reduce fugitive dust and to prepare the materials for ideal composting conditions. Materials would be actively composted for 8 weeks during which monitoring for moisture content, oxygen content, pH, and temperature would occur. The CASP system would consist of concrete bunkers with subgrade aeration trenches to collect leachate and deliver air for the composting process. Separation of storm water would be achieved by physically covering the material with an impermeable cover. Rain would be conveyed to a storm water control system for treatment, retention, or discharge. The leachate would be directed by subgrade drainage piping to a holding system for recirculation. After the active composting phase, materials would be moved to an adjacent bunker for the maturation stage for 4 weeks. Lastly, materials would be moved to a bunker for 4 weeks for the final curing stage. The Public Works Department anticipates using the compost beneficially on site (per Title 27 California Code of Regulations [CCR]), as an amendment to agricultural farmland soil, for community beautification projects, for residential property use, and other suitable end uses. See Figure 4, *Conceptual Composting Facility Site Plan*, for conceptual composting site layout.

The proposed Project would include the following compostable organic feedstocks, as defined by Title 14 CCR and Senate Bill 1383 – green material, food material, vegetative food material, organic waste, manure, and agricultural material. It should be noted that the existing Solid Waste Facility Permit and corresponding permitting documents currently authorize the receipt and handling of the listed feedstocks either for waste diversion or disposal. A detailed analysis of the organics feedstocks will be presented in the Supplemental EIR.

Construction of the facility may occur in two phases. As such, construction of Phase 1 (16 bunkers at 50,000 TPY) would be initially constructed. Operations of Phase 1 would run concurrently with the construction of Phase 2 (an additional 16 bunkers at 50,000 TPY). Total operational capacity of the proposed composting facility would be 32 bunkers and 100,000 TPY. The project proponent may choose to construct a complete build-out of the proposed project at one time. The construction of the compost and self-haul facility is anticipated to begin in 2021 and operational in 2022.



### **Waste Diversion**

The proposed Project also includes an enhancement to existing diversion activities by providing additional self-haul transfer and processing activities at a dedicated location in the diversion area of the northern buffer area. Construction activities associated with the self-haul recycling facility consists of the construction of a 500ft x 500ft concrete pad, which includes heavy equipment and support equipment to complete, in general, mobilization/demobilization, excavation, compaction, subgrade preparation, placement of concrete, drainage, and final grading. Self-haul customers would be directed to deposit their commingled solid waste loads onto a concrete, asphalt, or compacted soil surface dumping pad in the existing diversion area. Staff would sort the load using equipment or by hand, removing divertible materials and placing materials into stockpiles. Items targeted for diversion include, but are not limited to, scrap metal, wood waste, dimensional lumber, tires, tree trimmings, brush, grass clippings, organic wastes, inerts (concrete, asphalt, tile, etc.), drywall, electronic waste, mixed recyclables (cardboard, paper, aluminum, plastics, etc.), mattresses, and carpet. Residual solid wastes that cannot be salvaged would be sent to disposal.

### **Hours of Operation/Ancillary Activities**

The proposed Project includes an increase to the permitted hours for the Receipt of Refuse/Waste from 7:00 a.m. to 5:00 p.m., seven days per week to 7:00 a.m. to 7:00 p.m., seven days per week. Hours for the Receipt of Waste is defined as the days and hours open to all customers for the deposition of waste and diversion materials. The proposed increase in waste acceptance hours is in effort to provide additional waste disposal opportunity beyond standard working hours to the residents and commercial customers of Kern County. An increase in hours would also reduce the illegal dumping activities in the area caused by limited hours.

The proposed Project includes a change in Ancillary and Facility Operating Hours from 7:00 a.m. to 5:00 p.m., seven days per week to 24-hours a day, seven days per week. Facility Operating Hours is defined as the days and hours during which non-disposal activities occur, including but not limited to:

- Prescriptive cover placement;
- Alternative daily cover placement and removal;
- Facility and equipment maintenance;
- Dust control activities;
- Stockpile management;
- Processing, loading, handling, and transporting of diversion materials;
- Maintenance and operation of the compost facility;
- Environmental monitoring system maintenance, installation, and monitoring; and
- Other non-disposal related activities associated with the operation, maintenance, and monitoring of a solid waste disposal facility, compost facility, and diversion operation.

### **Solid Waste Buffer Area**

The proposed Project includes the addition of 50.21 acres into the Solid Waste Facility Permit (SWFP) as permitted facility boundary and into the CUP as solid waste disposal facility buffer. The 50.21 acres is a portion of APN 088-100-08. No landfilling activities will occur on the parcel. The project proposes to utilize the property consistent with the existing CUP and identified land use approvals, which includes:

- Borrow area, drainage facilities, landfill gas, and groundwater monitoring
- Passive energy collection facilities, with prior written approval of the Director of the Kern County Planning & Natural Resources Department
- Construction and closure activities



- Drainage improvements and erosion controls
- Groundwater monitoring installations
- Landfill gas monitoring and extraction installations
- Areas required for landfill closure construction
- Leachate storage and extraction facilities
- Closure equipment staging facilities
- Habitat Conservation Plan offsets
- Buffer to prevent incompatible adjacent land uses

The proposed Project does not propose an increase in maximum tonnage, traffic volumes, refuse footprint, or landfill design capacity beyond what is currently permitted. The estimated closure date is being updated to reflect current disposal projections, waste settlement, regional growth rates, enhanced diversion programs, and fluctuations in incoming tonnages; the updated estimated closure date is not due to a design capacity expansion. The Public Works Department is adjusting the management, processing, and handling method associated with the organic materials coming into the Shafter-Wasco RSLF. The Public Works Department is shifting the organic material that is currently being disposed of in the landfill to the proposed compost facility and self-haul recycling operation for recovery, handling, processing, or composting.

**The major components of the Project include:**

*Amend the Kern County General Plan (GPA No. 10, Map 78):*

- From Map Code 3.4.1 (Solid Waste Facility Buffer) to Map Code 3.7 (Other Waste Facilities) for 20 acres for a 100,000 ton per year compost facility (Figure 5, *Proposed General Plan Designations & Zoning Districts*);
- From Map Code 8.1 (Intensive Agriculture – Min. 20-Acre Parcel Size) to 3.4.1 (Solid Waste Disposal Facility Buffer) for 50.21 acres of landfill buffer; (Figure 5, *Proposed General Plan Designations & Zoning Districts*); and
- Amend Appendix E Map “Shafter-Wasco RSLF” to show revised permitted facility with designated buffer and compost areas (Figure 6, Proposed Appendix E Map)

*Modify the existing Conditional Use Permit (CUP No. 1, Map 78) to:*

- Revise the Shafter-Wasco RSLF permitted facility boundary from 357.48 acres to 407.69 acres to include 50.21 acres of landfill buffer property and designate 20 acres for the compost facility with no change to the 135-acre permitted disposal area;
- Include a 100,000 ton per year compost facility that allows for the composting of green materials, agricultural materials, paper materials, vegetative food materials, food materials (non-vegetative), and manure from residential, self-haul, commercial, and municipal haulers;
- Establish a finished compost storage time limit of 180 days to accommodate seasonal markets;
- Integrate enhanced self-haul recycling operations into existing waste diversion operations;
- Increase the hours for the receipt of refuse/waste from 7:00 a.m. to 5:00 p.m., seven days per week to 7:00 a.m. to 7:00 p.m., seven days per week; and
- Increase facility operating hours, including ancillary activities and non-disposal operations, from 7:00 a.m. to 5:00 p.m., seven days per week to 24 hours a day, seven days per week.





*Revise the existing Solid Waste Facility Permit (SWFP #15-AA-0057) to:*

- Increase the permitted facility boundary to 407.69 acres that will include the additional buffer area;
- Increase the composting design capacity from zero tons per year to 100,000 tons per year;
- Increase the hours for the receipt of waste from 7:00 a.m. to 5:00 p.m., seven days per week to 7:00 a.m. to 7:00 p.m., seven days per week;
- Increase facility operating hours, including ancillary activities and non-disposal operations, from seven days per week 7:00 a.m. to 5:00 p.m. to 24 hours a day, seven days per week; and
- Update estimated closure year from 2059 to 2055. (Note – The current closure date is an estimate subject to annual review based upon such factors as fill rate, inbound tonnage, waste projections, waste settlement, and regional growth rates. The Project proposes to update the estimated closure year for the Solid Waste Facility Permit from 2059 to 2055.)

*Apply for the issuance of Waste Discharge Requirements (WDRs) for Composting Operations to:*

- Construct and operate a 100,000 tons per year Tier II designed compost facility (in two 50,000 ton per year phases) that allows for the composting of green materials, agricultural materials, paper materials, vegetative food materials, food materials (non-vegetative), and manure from residential, self-haul, commercial, and municipal haulers.

*Apply for Authority to Construct and Permit to Operate to:*

- Allow for the construction and operation of a 100,000 tons per year compost facility (in two 50,000 ton per year phases) utilizing Best Available Control Technology designed to satisfy the requirements of the San Joaquin Valley Air Pollution Control District Rule 4566 and volatile organic compound emissions from composting operations.

### **3. ENVIRONMENTAL SETTING**

The proposed Project is situated in the southern San Joaquin Valley in western Kern County, California. Agriculture is the predominant land use surrounding the site. Other land uses within a one-mile radius include orchards, irrigated land, a cotton gin, residential, commercial, and farm dwellings. The nearest dwelling is 1/2 mile west of the site. Surrounding properties within an approximate two-mile radius are currently used for agricultural cultivation except for four dairies. Future land use in the area is projected to remain similar to existing land use. The existing landfill is compatible with adjacent farmland and vice-versa. All non-County owned parcels immediately adjacent to the Project site are designated as Prime Farmland and are under active Williamson Act contracts which encourages continued compatible agricultural land use. However, the County owned project area is not under an active Williamson Act contract (Figure 7, *Williamson Act*). County owned parcels within the project area are designated by the Department of Conservation as Vacant or Disturbed Land (north-east buffer), Grazing Land (north-west buffer), Urban and Built-Up Land (landfill), Prime Farmland (southern buffer), and Farmland of Statewide Importance (southernmost area of southern buffer) (Figure 8, *Department of Conservation Farmland Mapping Designations*).



The project site, as currently permitted and operational, is the extensively disturbed landfill and landfill buffer areas. Other than the landfill, the visual setting of the region is predominantly flat land and farms. Topographically, the area surrounding the landfill is generally flat. Pre-landfill surface elevations immediately adjacent to the site area ranged from 294 feet above mean sea level (AMSL) to 301 feet AMSL. The pre-landfill elevations ranged from 280 feet AMSL to 310 feet AMSL. The top of the existing fill surface is currently above natural grade at 384 feet AMSL.

The project site within the existing Shafter-Wasco RSLF is amidst intensely cultivated fields and is not a part of a wildlife migratory corridor. The site has been utilized by landfill operations, access roads, environmental monitoring wells, diversion activities, drainage features, and agricultural farming. Vegetation is dominated by common salt brush; conspicuous plants also include non-native red brome, Arabian grass, mustards, ripgut brome, and Russian thistle.

The nearest mapped active faults (during the Holocene period) to the site are the Kern Front and Buena Vista Faults, located 19 miles east and 24 miles south of the site, respectively. The San Andreas Fault is located 28 miles west of the site. No known or mapped faults trend towards or beneath the project site. The site is located within the administrative boundaries of the abandoned Garrison City Gas Field. There are no oil or gas wells on the project site. An abandoned oil pipeline crosses underneath the northern landfill buffer area that includes the diversion area operation and proposed composting area.

Water bearing zones beneath the site consist of confined, unconfined and perched aquifers. In September 2018, the unconfined groundwater surface was measured in the landfill water well at a depth of 342 feet below grade surface. Current depth to the highest perched aquifer is approximately 70 to 85 feet below grade surface, and the predominant flow direction is to the east-northeast. The landfill groundwater monitoring system consists of background wells, compliance wells, evaluation monitoring program wells,

and pan lysimeters. Current groundwater quality data confirms the continued presence of several volatile organic compounds (VOC) in the perched groundwater, with the highest concentrations occurring in samples from those wells nearest the unlined waste module, Module 1. The leachate collection and recovery system is functioning for Modules 2 and 3.

The project area is not archaeologically or culturally resource sensitive; there are no historical landmarks in the area. The predominant soil type at the site is Milham sandy loam. The project area is outside of the 100-year floodplain. The project is not within the boundaries of any airport as identified in the Kern County Airport Land Use Compatibility Plan. The nearest airports are the Wasco Airport (10 miles northeast) and Minter Field Airport (13.8 miles east). The site is outside the planning spheres of influence for the Cities of Shafter and Wasco and outside the Metropolitan Bakersfield area.

Public facilities are not available due to the rural location of the project. The Shafter-Wasco RSLF is not located near an existing or planned recreational facility. The site is in a quiet noise environment. Agricultural equipment, crop dusters, and road traffic on Scofield Avenue are the sources of off-site noise.

### **Surrounding Land Uses**

The project lies within the administrative boundaries of the Kern County General Plan. Land uses on the Project site and surrounding areas are described in Table 1 and shown on Figure 9, *Current General Plan Designations and Zoning Districts*. The landfill is in a rural agricultural area; no established community exists. Existing planning does not allow for the establishment of a community land use pattern.

**Table 1: Project Site & Surrounding Land Uses\***

<b>Direction from Project Site</b>	<b>Existing Land Use</b>	<b>Existing Map Code Designation</b>	<b>Existing Zoning Classifications</b>
Project Site	Landfill Disposal, Diversion, and Landfill Buffer	3.4 (Solid Waste Disposal Facility); 3.4.1 (Solid Waste Disposal Facility Buffer); 8.1 (Intensive Agriculture)	A (Exclusive Agriculture)
North	Agriculture	8.1 (Intensive Agriculture)	A (Exclusive Agriculture)
East	Agriculture	8.1 (Intensive Agriculture)	A (Exclusive Agriculture)
South	Agriculture	8.1 (Intensive Agriculture)	A (Exclusive Agriculture)
West	Agriculture	8.1 (Intensive Agriculture)	A (Exclusive Agriculture)

Source: Kern County General Plan and Kern County Zoning Ordinance via Kern County GIS

\*No changes are proposed to Zoning Districts as part of the proposed Project

#### 4. PROJECT OBJECTIVES

The CEQA Guidelines Section 15124(b) require that the Project description contain a statement of objectives that includes the purpose of the Project. The specific objectives for the proposed Project, as identified by the project proponent, are as follows:

- Facilitate CalRecycle's statewide diversion goal of 75 percent recycling, composting, or source reduction of materials by 2025 established under SB 1383 by targeting agricultural material, food material, vegetative food material, manure, and other compostable, organic, and recyclable materials.
- Implement an organic waste recycling program to divert organic waste consistent with the requirement of AB 1826, Mandatory Commercial Organics Recycling, which requires businesses to recycle their organic waste on and after April 1, 2016, depending on the amount of waste they generate per week.
- Assist in requirement of AB 32 (California Global Warming Solutions Act of 2006) to reduce GHG emissions to 1990 levels by 2020. In 2016, Legislature passed SB 32 and AB 197, which requires a 2030 GHG emissions reduction target of 40 percent below 1990 levels.
- Construct and operate a regional composting facility for municipal, commercial, business, and residential sources by removing organics from landfills in an effort to reduce volatile organic compound and greenhouse gas emissions resulting from landfill operations.
- Utilize existing County-owned lands and existing infrastructure for composting and self-haul recycling operations to preserve prime farmland, minimize environmental impact, and target compostable materials from being landfilled.
- Provide solid waste disposal, diversion, and composting programs to the residents and businesses of Kern County in compliance with organic waste diversion and groundwater and air quality requirements.
- Manufacture high quality compost for use in sustainable agricultural practices, community beautification projects, residential property use, and other suitable end uses.

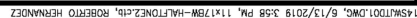
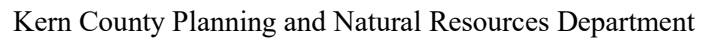



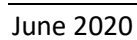
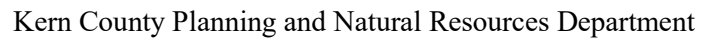

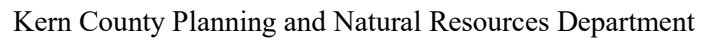

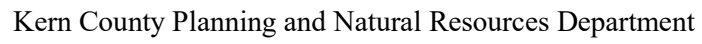

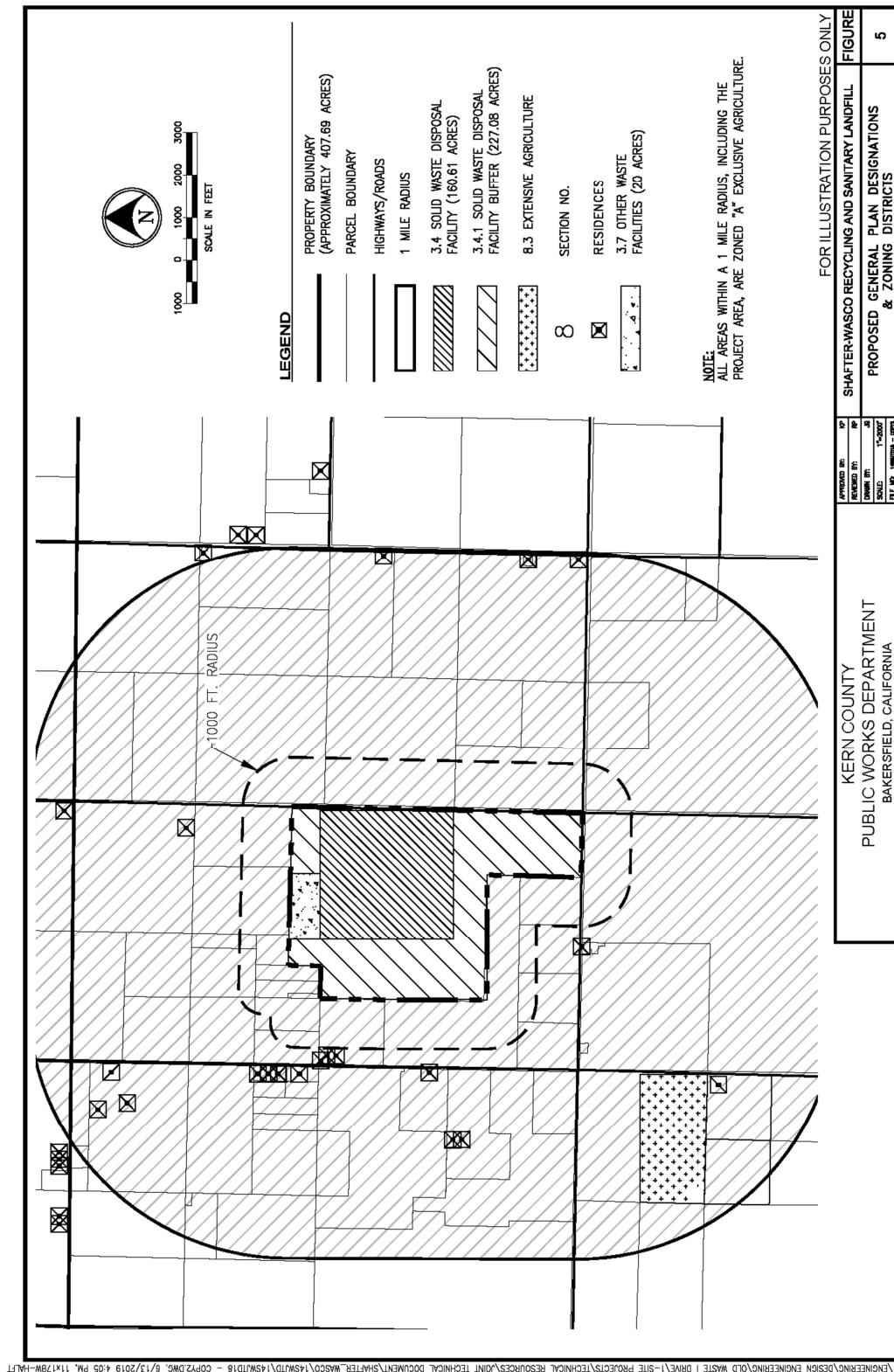



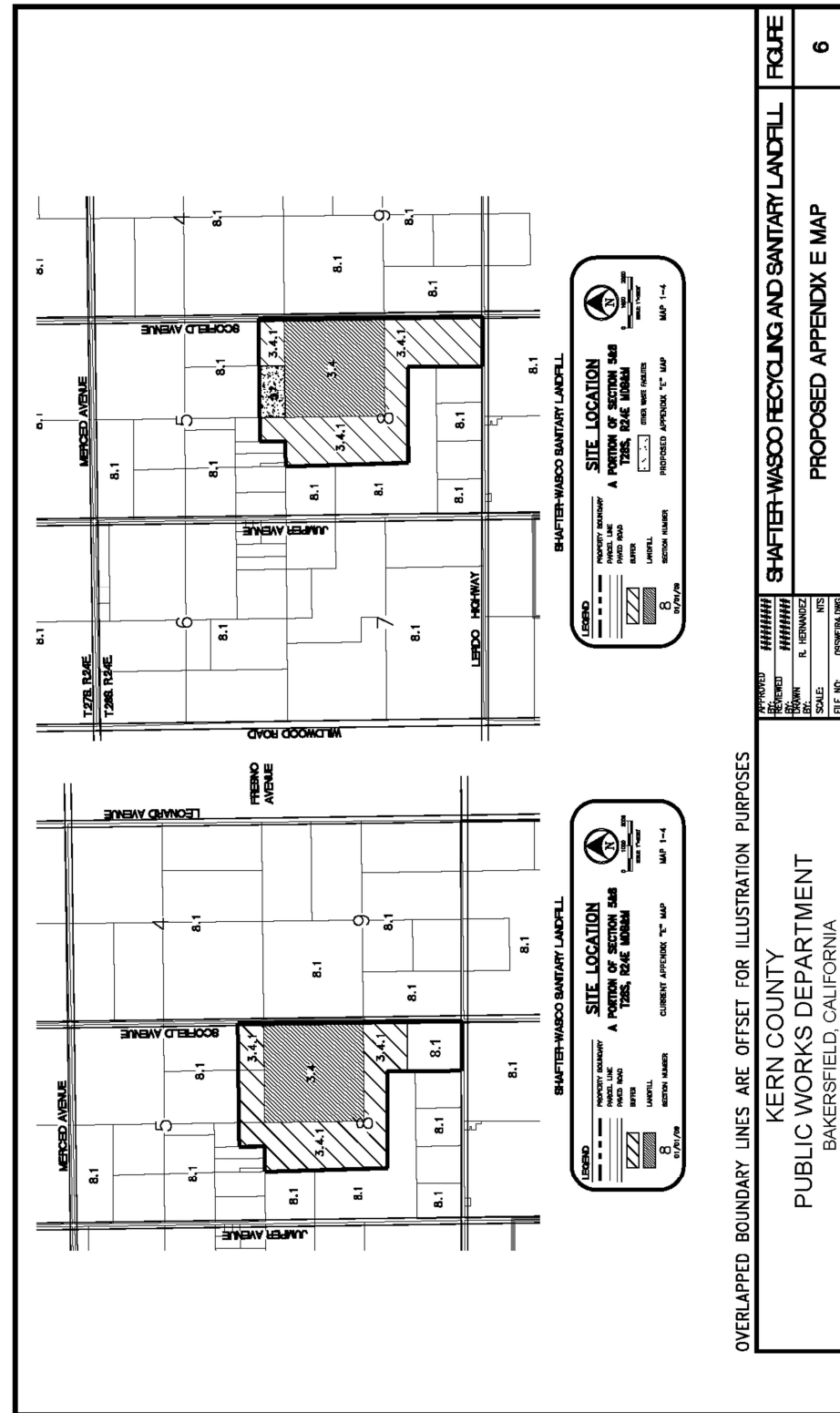

OVERLAPPED BOUNDARY LINES ARE OFFSET FOR ILLUSTRATION PURPOSES

KERN COUNTY PUBLIC WORKS DEPARTMENT BAKERSFIELD, CALIFORNIA		APPROVED REVIEWED DESIGNED BY: R. HERNANDEZ SCALE: NTS FILE NO: 055WEIR/04	SHAFER-WASCO RECYCLING AND SANITARY LANDFILL	FIGURE 6
---	--	---	--	-------------

K:\ENGINEERING\DESIGN ENGINEERING\OLD WASTE I DRIVE\1-SITE PROJECTS\TECHNICAL RESOURCES\ENVIRON  
IMPACT REPORT\SHAFER-WASCO\095WEIR\DWG\095WEIR4.DWG, 4:06 PM, ROBERTO HERNANDEZ



# Kern County Planning and Natural Resources Department

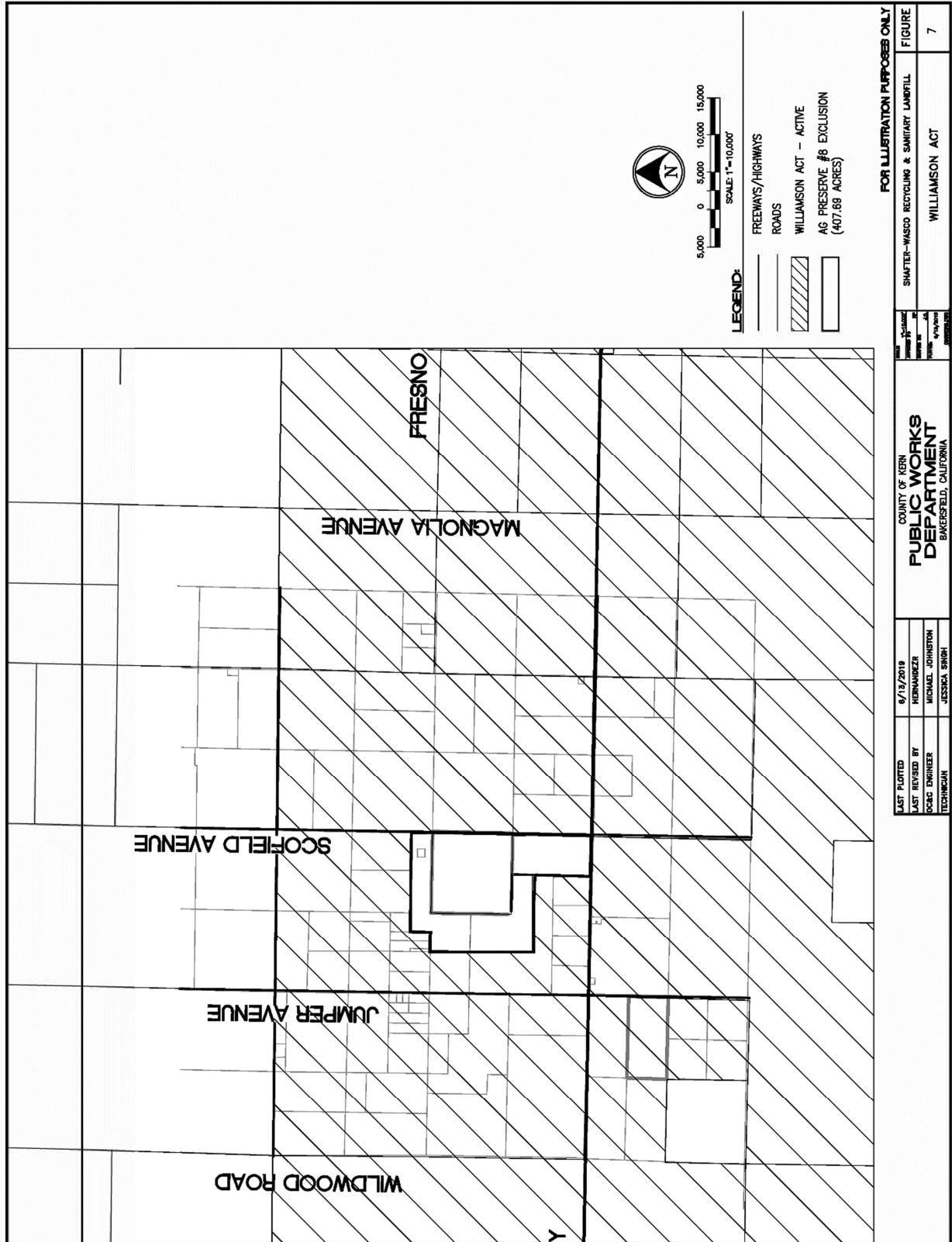



Kern County Planning and Natural Resources Department

K:\ENGINEERING\DESIGN ENGINEERING\OLD WASTE 1 DRINK\1-SITE PROJECTS\TECHNICAL RESOURCES\JOINT TECHNICAL DOCUMENT\SHAFER\MASCO\145W\T0145W\T0145W.DWG, 3/12/2020 12:08 PM, 1114734.dwg, ROBI

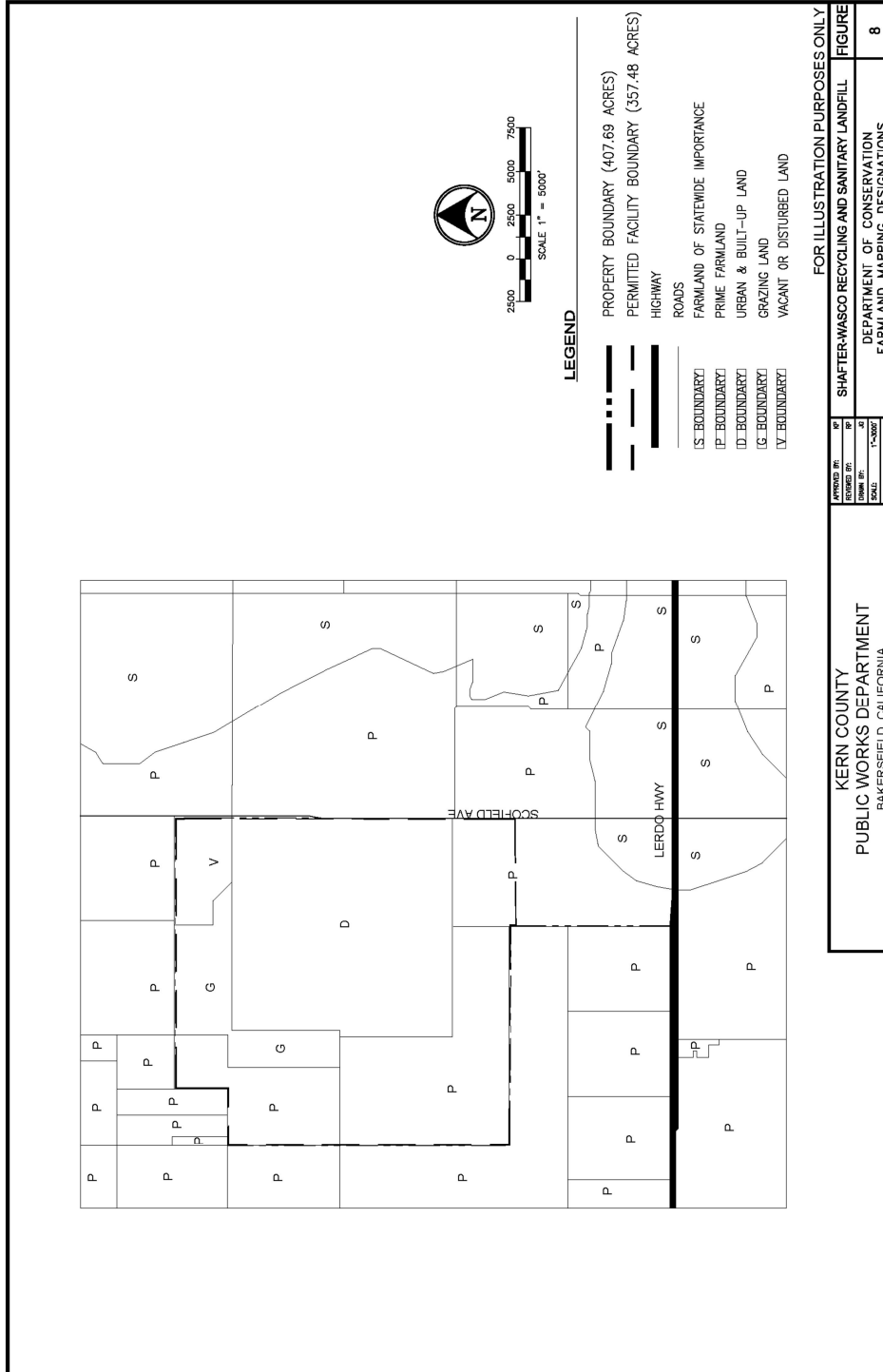

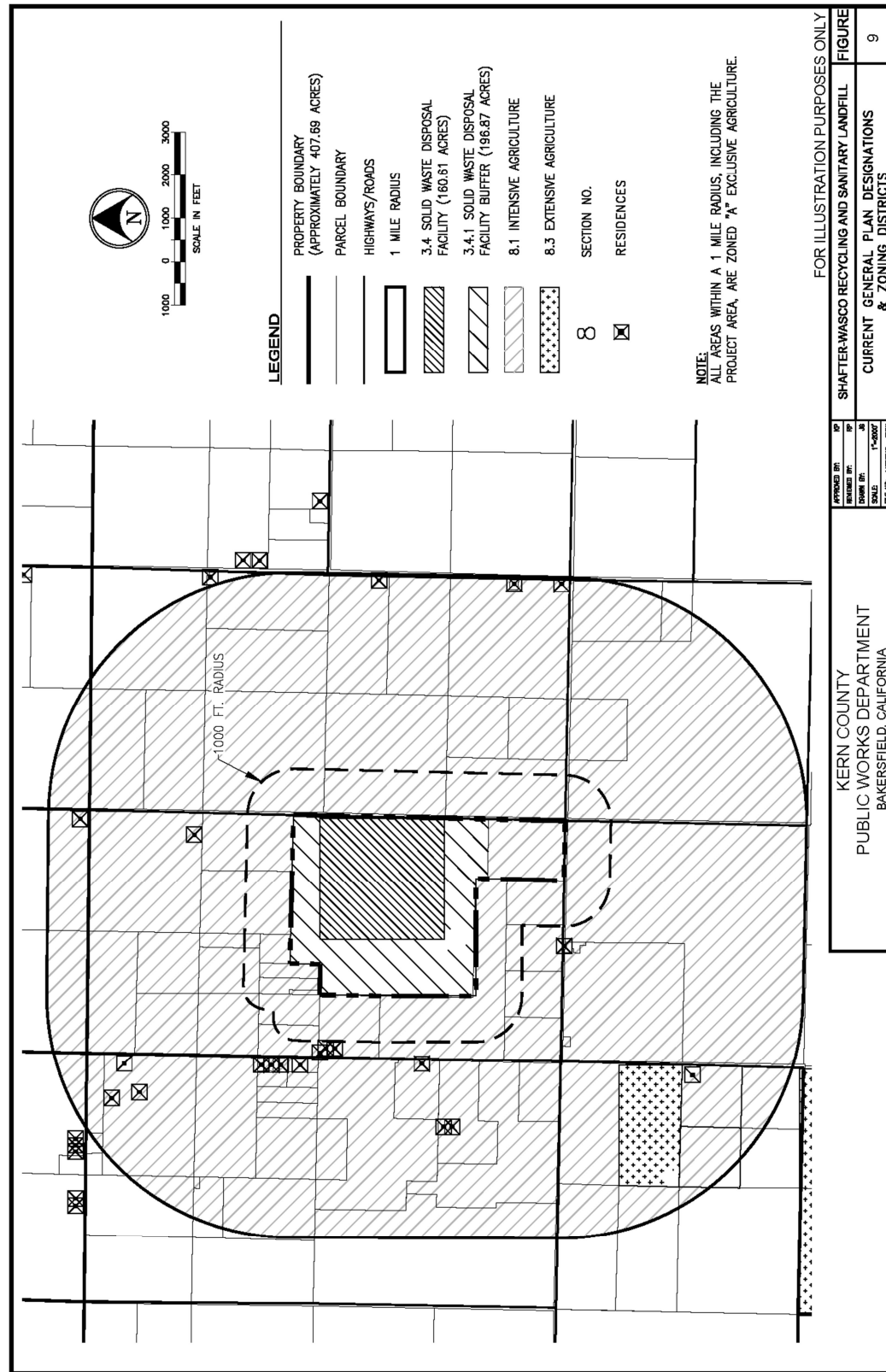





## C. ENVIRONMENTAL FACTORS POTENTIALLY AFFECTED

In accordance with CEQA Guidelines, the County intends to prepare a Supplemental EIR to evaluate potential environmental effects of the project and to propose mitigation measures to reduce any significant effects identified.

The supplement to the EIR will contain only the information necessary to document all project impacts for the Shafter-Wasco Composting and Waste Diversion Project (CEQA Guidelines 15163(b)). The environmental factors checked below would be potentially affected by this project, involving at least one impact that is a “Potentially Significant Impact” as indicated by the Kern County approved checklist. As such, the environmental review of the Supplemental EIR will focus on these issues.

- |   |   |  |
|---|---|--|
| <input checked="" type="checkbox"/> Aesthetics                  | <input checked="" type="checkbox"/> Agricultural and Forestry Resources | <input checked="" type="checkbox"/> Air Quality                        |
| <input checked="" type="checkbox"/> Biological Resources        | <input checked="" type="checkbox"/> Cultural Resources                  | <input checked="" type="checkbox"/> Energy                             |
| <input checked="" type="checkbox"/> Geology / Soils             | <input checked="" type="checkbox"/> Greenhouse Gas Emissions            | <input checked="" type="checkbox"/> Hazards & Hazardous Materials      |
| <input checked="" type="checkbox"/> Hydrology / Water Quality   | <input checked="" type="checkbox"/> Land Use / Planning                 | <input checked="" type="checkbox"/> Mineral Resources                  |
| <input checked="" type="checkbox"/> Noise                       | <input type="checkbox"/> Population / Housing                           | <input type="checkbox"/> Public Services                               |
| <input type="checkbox"/> Recreation                             | <input checked="" type="checkbox"/> Transportation and Traffic          | <input checked="" type="checkbox"/> Tribal Cultural Resources          |
| <input checked="" type="checkbox"/> Utilities / Service Systems | <input checked="" type="checkbox"/> Wildfire                            | <input checked="" type="checkbox"/> Mandatory Findings of Significance |

### Other Environmental Issues

The County conducted preliminary review of the proposed Project and proposed modifications to CUP No. 1, Map 78 and has determined it is not likely to result in significant environmental effects to the following resources and/or would not substantially increase an impact already addressed in the previously certified 2009 Shafter-Wasco Sanitary Landfill Permit Revision Project EIR and the previously circulated 2007 Notice of Preparation.

- Population / Housing: The proposed Project will not induce substantial unplanned population growth through the construction of new homes, roads, or other infrastructure nor displace any housing units or people.
- Public Services: Existing services are adequate to serve the proposed Project and would not result in altering and creating new governmental and public services (police protection, schools, parks, or other public facilities).



- 
- Recreation: The Kern County General Plan does not identify any existing or proposed recreational facilities near the project area.

### **Mitigation Measures**

The previously certified 2009 EIR and approved mitigation measures that were designed to reduce or eliminate potential impacts will be incorporated into the Supplemental EIR for the proposed Project. These mitigation measures were adopted by the County in its approval of the 2009 EIR. The effectiveness of these measures to reduce impacts to specific resources affected by the Project will be evaluated in the Supplemental EIR and additional mitigation measures may be developed to further reduce impacts, if required.

### **Alternatives to be Evaluated in the Supplemental EIR**

The Supplemental EIR will include an evaluation of a reasonable range of potentially feasible alternatives to the project. The alternatives analysis will recognize that the project is already used as a landfill and the handling of compostable and recyclable materials. Consistent with CEQA requirements, alternatives evaluated in the Supplemental EIR will be based on their potential to reduce the significant environmental impacts of the project. A No Project alternative will be included as well as potential alternatives such as mitigated design and/or an off-site alternative.